

Rear Speaker

Operating Instructions

SA-Z9R



©2018 Sony Corporation Printed in Malaysia

4-727-591-32(1)

What You Can Do with the Rear Speakers

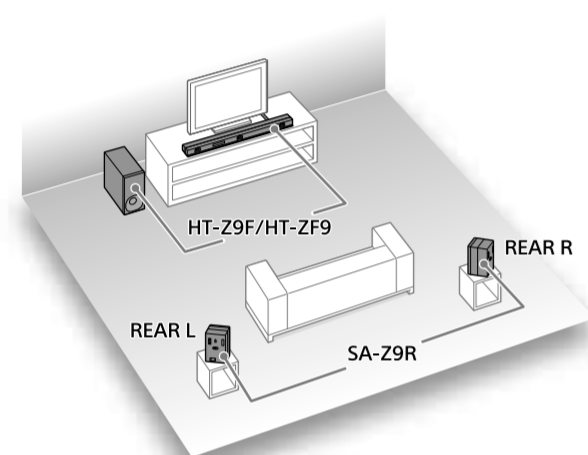

The following are available when the rear speakers are used with the Sound Bar (HT-Z9F/HT-ZF9) (not supplied).

- You can enjoy the surround sound that makes you feel as if you were actually listening to a live performance.
- You can update the software of the rear speakers. For details, refer to the Operating Instructions supplied with the Sound Bar (HT-Z9F/HT-ZF9).

- Note**
- The rear speakers are designed exclusively for use with the Sound Bar (HT-Z9F/HT-ZF9) and cannot be used with other devices.
 - Install the rear speakers vertically.

Parts and Controls

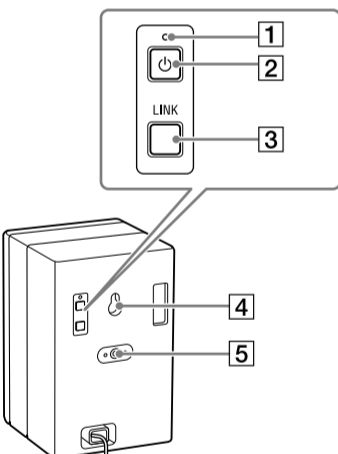

- Power indicator
- (power) button
- LINK button
- Wall mount hole
- Mounting hole for the general speaker stand

Power indicator

Indicator status (color)	Rear speaker status
Flashes slowly (green)	The rear speaker is not connected to the Sound Bar (HT-Z9F/HT-ZF9).
Lights up (green)	The rear speaker is connected to the Sound Bar (HT-Z9F/HT-ZF9).
Flashes twice repeatedly (green)	The rear speaker is attempting to connect to the Sound Bar (HT-Z9F/HT-ZF9).
Flashes/lights up (orange)	The software is updating.
Lights up (red)	The rear speaker is in standby mode.
Turns off	The rear speaker is turned off.

Connection

1 Connect the AC power cord (mains lead).

The rear speaker is turned on and connected to the Sound Bar (HT-Z9F/HT-ZF9) wirelessly.

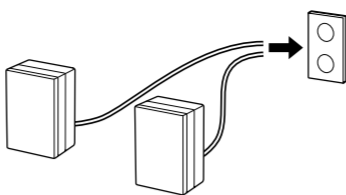

2 Make sure that the power indicator on the rear speaker lights in green.

When the power indicator lights in green, the connection of the rear speaker and the Sound Bar (HT-Z9F/HT-ZF9) is established. If the connection is not established, connect the rear speaker to the Sound Bar (HT-Z9F/HT-ZF9) manually. For details, refer to the Operating Instructions supplied with the Sound Bar (HT-Z9F/HT-ZF9).

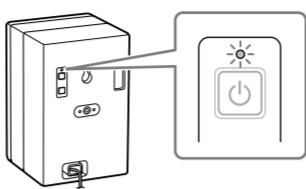

3 Install the rear speaker by considering the right/left of the rear speaker.

Check the label on the rear of the rear speaker. "REAR R" is for the right, "REAR L" is for the left.

Mounting the Rear Speaker on a Wall

You can mount the rear speakers on a wall.

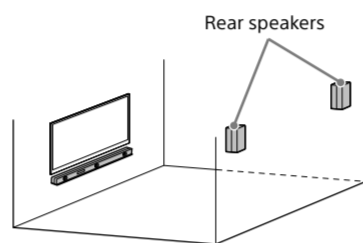

Note

- Prepare screws (not supplied) that are suitable for the wall material and strength. As a plasterboard wall is especially fragile, attach the screws securely in the wall beam. Install the speakers horizontally, hung by screws in studs in a continuous flat section of the wall.
- Have the installation done by a Sony dealer or licensed contractor and pay special attention to safety during the installation.
- Sony shall not be held responsible for accidents or damage caused by improper installation, insufficient wall strength, improper screw installation or natural disaster, etc.

1 Prepare a screw (not supplied) that is suitable for the wall mount hole on the rear of the rear speaker.

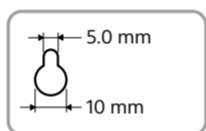
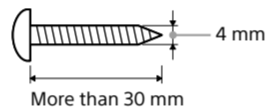

Hole on the rear of the rear speaker

2 Fasten the screw in the wall.

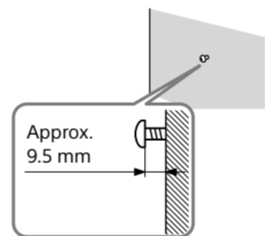

3 Hang the rear speaker by confirming the right/left of the rear speaker.

Check the label on the rear of the rear speaker. "REAR R" is for the right, "REAR L" is for the left.

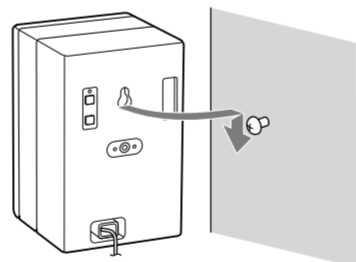

Troubleshooting

If you experience any of the following difficulties while using the rear speakers, use this troubleshooting guide to help remedy the problem before requesting repairs. Should any problem persist, consult your nearest Sony dealer. Be sure to bring all of your rear speakers and Sound Bar (HT-Z9F/HT-ZF9) (main unit and subwoofer) (not supplied) even if it seems as though only one has a problem, when you request to repair.

No sound is heard from the rear speakers.

- Make sure the AC power cord (mains lead) of the rear speaker is connected properly.
- If the power indicator on the rear speaker does not light, try the following.
 - Make sure the AC power cord (mains lead) of the rear speaker is connected properly.
 - Press (power) of the rear speaker to turn on the power.
- If the power indicator on the rear speaker flashes slowly in green or lights in red, try the following.
 - Move the rear speaker to a location near the main unit of the Sound Bar (HT-Z9F/HT-ZF9) so that the power indicator on the rear speaker lights in green.
 - Connect the rear speaker to the Sound Bar (HT-Z9F/HT-ZF9) manually. For details, refer to the Operating Instructions supplied with the Sound Bar (HT-Z9F/HT-ZF9).
 - Check the wireless connection status. For details, refer to the Operating Instructions supplied with the Sound Bar (HT-Z9F/HT-ZF9).
- Press REAR \leftarrow + on the remote control of the Sound Bar (HT-Z9F/HT-ZF9) to increase the volume of the rear speakers.
- If you change the [RF Channel] setting of the Sound Bar (HT-Z9F/HT-ZF9) from [Off] to [On], it may take 1 minute for the sound to be output. For details, refer to the Operating Instructions supplied with the Sound Bar (HT-Z9F/HT-ZF9).

Sound skips or has noise.

- If there is a device nearby that generates electromagnetic waves, such as a wireless LAN or a microwave oven in use, locate the rear speakers and the Sound Bar (HT-Z9F/HT-ZF9) apart from that device.
- If there is an obstacle between the main unit of the Sound Bar (HT-Z9F/HT-ZF9) and the rear speakers, move or remove the obstacle.
- Locate the main unit of the Sound Bar (HT-Z9F/HT-ZF9) and the rear speakers as close as possible.
- Switch the network connection of the TV or Blu-ray Disc player from wireless to wired.

Specifications

Amplifier section

POWER OUTPUT (rated)
30 W + 30 W (at 4 ohms, 1 kHz, 1% THD)
POWER OUTPUT (reference)
50 W (per channel at 4 ohms, 1 kHz)

Speaker system

Full range speaker system, Acoustic suspension

Speaker

46 mm cone type, Full range speaker

Power requirements

220 V - 240 V AC, 50 Hz/60 Hz

Power consumption

On: 11 W
Standby mode: 1 W or less
Turned off: 0.5 W or less

Dimensions (w/h/d) (approx.)

100 mm x 155 mm x 100 mm (projecting parts not included)

Mass (approx.)

1.0 kg

Wireless transmitter/receiver section

Communication system

Wireless Sound Specification Version 4.0

Frequency band

5 GHz

Modulation method

OFDM

Radio Frequency Bands and Maximum Output Power

Frequency band	Maximum output power
5150 - 5250 MHz	< 18 dBm
5250 - 5350 MHz	< 18 dBm
5470 - 5600 MHz	< 18 dBm
5650 - 5725 MHz	< 18 dBm
5725 - 5850 MHz	< 13.98 dBm

Included items

- Rear speaker R (1), Rear speaker L (1)
- Operating Instructions (1)

On copyrights

This product contains software that is subject to the GNU General Public License ("GPL") or GNU Lesser General Public License ("LGPL"). These establish that customers have the right to acquire, modify, and redistribute the source code of said software in accordance with the terms of the GPL or the LGPL.

For details of the GPL, LGPL and other software licenses, please refer to [Software License Information] under [Setup] - [Advanced Settings] - [System Settings] on the product.

The source code for the software used in this product is subject to the GPL and LGPL, and is available on the Web. To download, please access the following: URL: <http://oss.sony.net/Products/Linux>

Please note that Sony cannot answer or respond to any inquiries regarding the content of this source code.

All other trademarks are trademarks of their respective owners.

WARNING

Do not install the appliance in a confined space, such as a bookcase or built-in cabinet.

To reduce the risk of fire, do not cover the ventilation opening of the appliance with newspapers, tablecloths, curtains, etc. Do not expose the appliance to naked flame sources (for example, lighted candles).

To reduce the risk of fire or electric shock, do not expose this appliance to dripping or splashing, and do not place objects filled with liquids, such as vases, on the appliance.

The unit is not disconnected from the mains as long as it is connected to the AC outlet, even if the unit itself has been turned off.

As the main plug is used to disconnect the unit from the mains, connect the unit to an easily accessible AC outlet.

Should you notice an abnormality in the unit, disconnect the main plug from the AC outlet immediately.

Indoor use only.

For the customers in Europe

Notice for customers: the following information is only applicable to equipment sold in countries applying EU directives.

This product has been manufactured by or on behalf of Sony Corporation.

EU Importer: Sony Europe Limited.

Inquiries to the EU Importer or related to product compliance in Europe should be sent to the manufacturer's authorized representative, Sony Belgium, bijkantor van Sony Europe Limited, Davincilaan 7-D1, 1935 Zaventem, Belgium.



Hereby, Sony Corporation declares that this equipment is in compliance with Directive 2014/53/EU.

The full text of the EU declaration of conformity is available at the following internet address: <http://www.compliance.sony.de/>

For this radio equipment, the following restrictions on putting into service or of requirements for authorisation of use apply in BE, BG, CZ, DK, DE, EE, IE, EL, ES, FR, HR, IT, CY, LV, LT, LU, HU, MT, NL, AT, PL, PT, RO, SI, SK, FI, SE, UK, IS, LI, NO, CH, AL, BA, MK, MD, RS, ME, XK, TR: 5150 - 5350 MHz band is restricted to indoor operations only.

This radio equipment is intended to be used with the approved version(s) of software that are indicated in the EU Declaration of Conformity. The software loaded on this radio equipment is verified to comply with the essential requirements of the Directive 2014/53/EU.

The software version can be found via: Refer to [System Information] under [Setup] - [Advanced Settings] - [System Settings].



Disposal of old electrical & electronic equipment (applicable in the European Union and other countries with separate collection systems)

This symbol on the product or on its packaging indicates that this product shall not be treated as household waste. Instead it shall be handed over to the appropriate collection point for the recycling of electrical and electronic equipment. By ensuring that this product is disposed of correctly, you will help to prevent potential negative consequences for the environment and human health, which could be caused by inappropriate waste handling of this product. The recycling of materials will help to conserve natural resources. For more detailed information about recycling of this product, please contact your local Civic Office, your household waste disposal service or the shop where you purchased the product.

For the customers in Australia or New Zealand

It should be installed and operated with at least 20 cm and more between the radiator and person's body (excluding extremities: hands, wrists, feet and ankles).

For the customers in Australia



Disposal of old electrical & electronic equipment (applicable in the European Union and other countries with separate collection systems)