

SONY

电视机

入门指南

BRAVIA

KD-75X8500C / 65X8500C / 55X8500C / 49X8300C / 43X8300C

A 	B KD-75/ 65X8500C (1)	C KD-75/ 65X8500C (2)
D M6 × 12 M5 × 20 (4)	E KD-55X8500C, KD-49/43X8300C (1)	F KD-55X8500C, KD-49/43X8300C (2)
G M5 × 16 KD-55X8500C, KD-49/43X8300C (6)	H R03 KD-75/65/ 55X8500C	I R03
J KD-75/65/ 55X8500C (1)	K (1)	L * (1)



* 仅针对有限的地区/国家/电视机型号。

KD-75/65/55X8500C

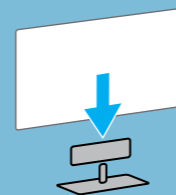

KD-75/65X8500C

1

2

3

KD-55X8500C, KD-49/43X8300C

1

2

3

搬运电视机以前，请参阅参考指南中的“安全信息”。

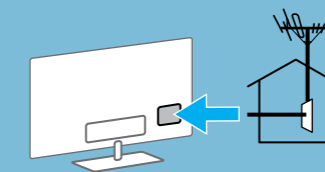

A

B

连接天线或有线 (A)，机顶盒 (B)。选择HDMI进行连接。
*端子和标签因电视机型号而异。



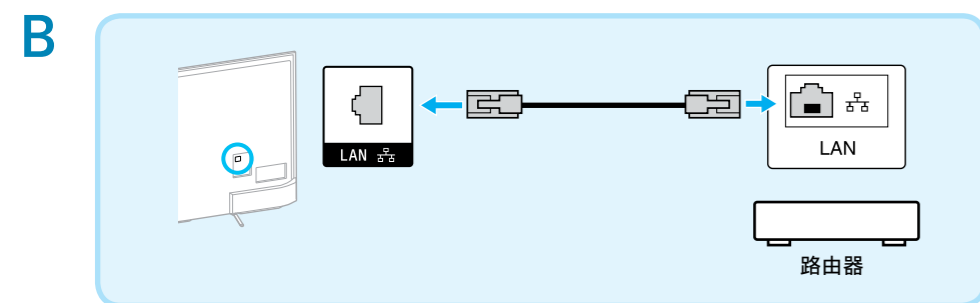
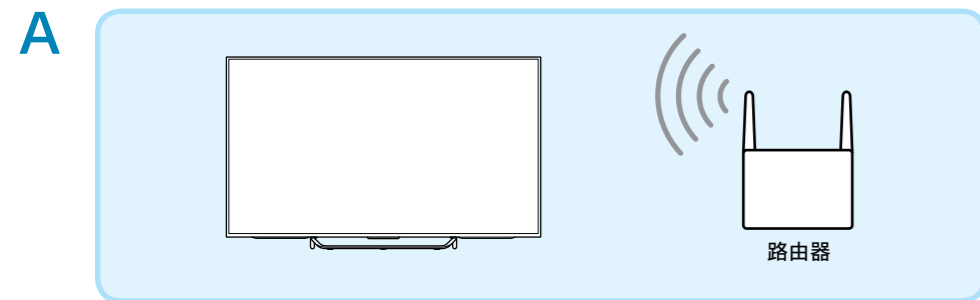

互联网无线连接 (A)，有线连接 (使用7类LAN电缆) (B)。有关路由器设定，请参阅路由器附送的说明书。

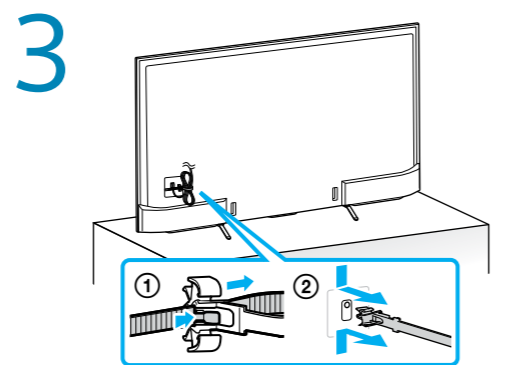
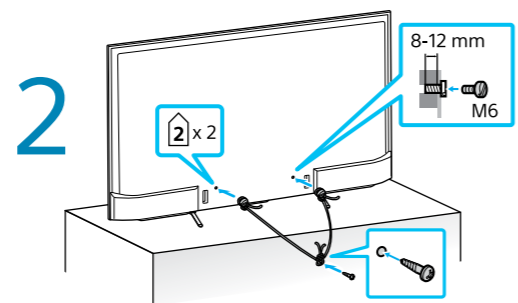
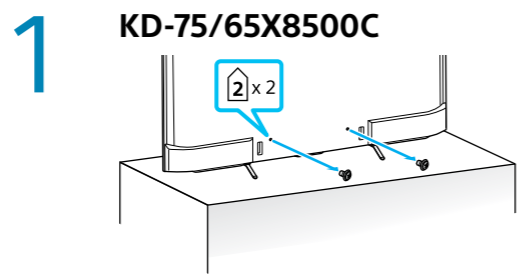

安装 请勿将交流电源线和其它电缆捆扎在一起。

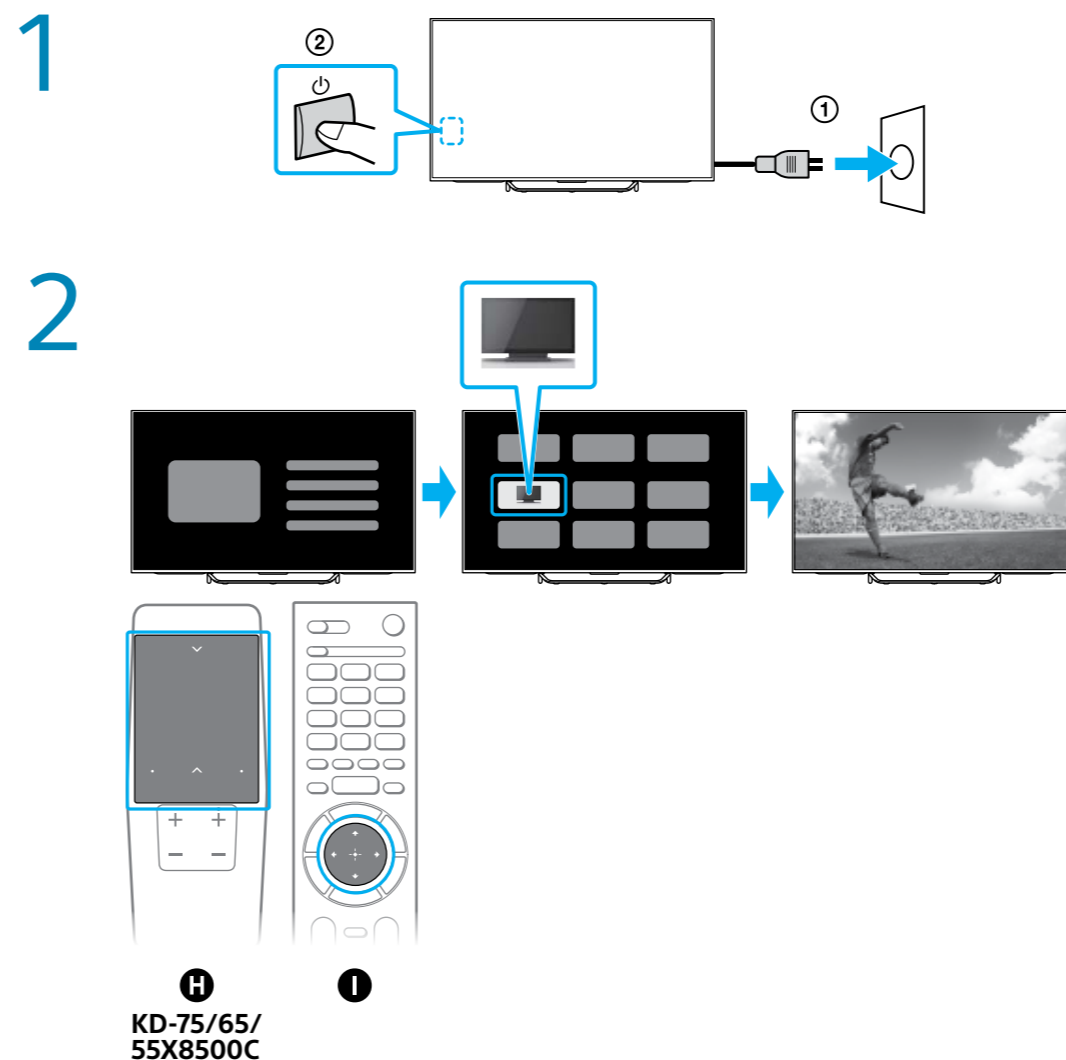
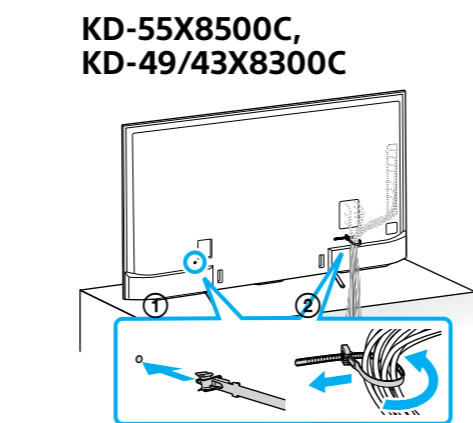
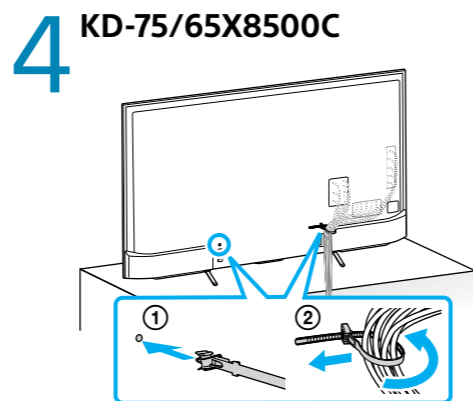

打开电视机，然后执行初始设定。

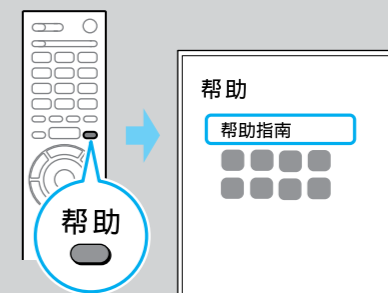

http://rd1.sony.net/help/tv/cch1/h_ch/

帮助指南：有关如何使用电视机功能的信息。电视机和网页上均可获取。

<http://service.sony.com.cn/TV/index.htm>