

FM/AM Compact Disc Player

Operating Instructions

GB

To switch the FM/AM tuning step, see page 6.
To cancel the demonstration (DEMO) display, see page 12.



Be sure to install this unit in the dashboard of the car for safety.
For installation and connections, see the supplied installation/connections manual.

Laser Diode Properties

- Emission Duration: Continuous
 - Laser Output: Less than 53.3 μW
- (This output is the value measurement at a distance of 200 mm from the objective lens surface on the Optical Pick-up Block with 7 mm aperture.)

Note on the lithium battery

Do not expose the battery to excessive heat such as direct sunlight, fire or the like.

Warning if your car's ignition has no ACC position

Be sure to set the AUTO OFF function (page 12). The unit will shut off completely and automatically in the set time after the unit is turned off, which prevents battery drain. If you do not set the AUTO OFF function, press and hold OFF until the display disappears each time you turn the ignition off.

Table of Contents

Guide to Parts and Controls	4
---------------------------------------	---

Getting Started

Detaching the Front Panel	5
Switching the FM/AM Tuning Step	6
Setting the Clock	6
Connecting an iPod/USB Device	6
Connecting Other Portable Audio Device	7

Listening to the Radio

Listening to the Radio	7
Using Radio Data System (RDS)	8

Playback

Playing a Disc	9
Playing an iPod/USB Device	9
Searching and Playing Tracks	10

Listening to Pandora®

Preparing for Pandora®	11
Streaming Pandora®	11
Available Operations in Pandora®	11

Settings

Canceling the DEMO Mode	12
Basic Setting Operation	12
GENERAL Setup	12
SOUND Setup	13
EQ3 PRESET	13
EQ3 SETTING	13
DISPLAY Setup	13
COLOR (Preset Color - Dynamic Color Illuminator)	13
CUSTOM-C (Custom Color)	13

Additional Information

Precautions	14
Maintenance	15
Specifications	16
Troubleshooting	17

Guide to Parts and Controls

Main unit

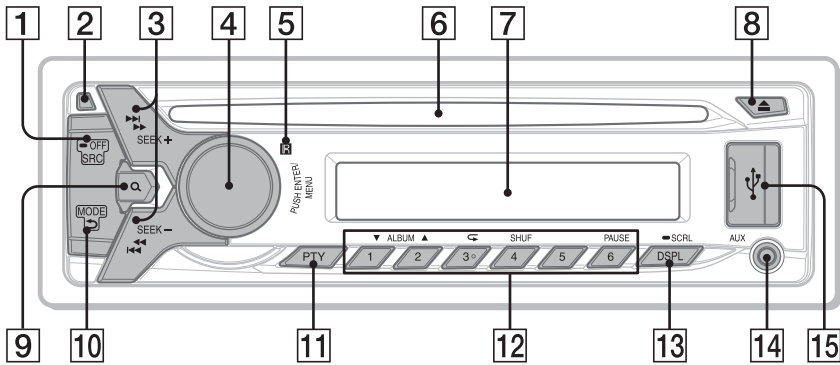

The number 3/↺ (repeat) button has a tactile dot.

1 SRC (source)

Turn on the power.
Change the source.

-OFF

Press and hold for 1 second to turn off the power.
Press and hold for more than 2 seconds to turn off the power and the display.
If the unit is turned off and the display disappears, it is unable you to operate with the remote.

2 Front panel release button

3 SEEK +/-

Tune in radio stations automatically.
Press and hold to tune manually.

◀◀/▶▶ (prev/next) ◀◀/▶▶ (reverse/fast-forward)

4 Control dial

Rotate to adjust the volume.

ENTER

Enter the selected item.

MENU

Open the setup menu.

5 Receptor for the remote commander

6 Disc slot

7 Display window

8 ▲ (disc eject)

9 Q (browse) (page 10, 11)

Enter the browse mode during playback.

10 ↶ (back)

Return to the previous display.

MODE (page 7, 9, 11)

11 PTY (program type)

Select PTY in RDS.

12 Number buttons (1 to 6)

Receive stored radio stations. Press and hold to store stations.

ALBUM ▼/▲

Skip an album for audio device. Press and hold to skip albums continuously.

Thumbs up (▲), or thumbs down (▼) in Pandora® (page 11).

↺ (repeat)

SHUF (shuffle)

PAUSE

13 DSPL (display)

Change display items.

-SCRL (scroll)

Press and hold to scroll a display item.

14 AUX input jack

15 USB port

RM-X211 Remote

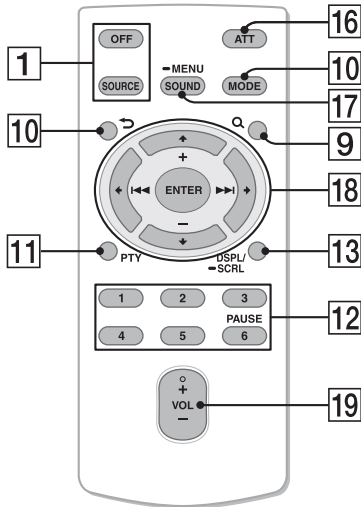

The VOL (volume) + button has a tactile dot.

Remove the insulation film before use.

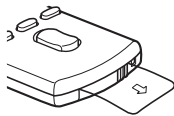

16 **ATT (attenuate)**

Attenuate the sound. Press again to cancel the attenuated sound.

17 **SOUND**

Open the SOUND menu directly.

-MENU

Press and hold to open the setup menu.

18 **← (|<<<)/↑ (+)/↓ (-)/→ (|>>|)/ENTER**

Setup items, etc. can be operated by ←/↑/↓/→.

19 **VOL (volume) +/-**

Getting Started

Detaching the Front Panel

You can detach the front panel of this unit to prevent theft.

- 1 Press and hold OFF ①.
The unit is turned off.
- 2 Press the front panel release button ②, then remove the panel by pulling it towards you.

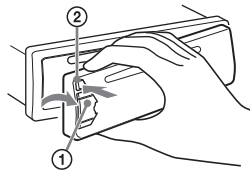

Caution alarm

If you turn the ignition switch to the OFF position without detaching the front panel, the caution alarm will sound for a few seconds. The alarm will only sound if the built-in amplifier is used.

Attaching the front panel

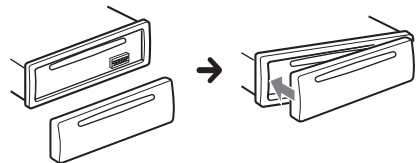

Switching the FM/AM Tuning Step

Set the FM/AM tuning step of your country. This setting appears when this unit is turned off.

- 1** Press MENU, rotate the control dial to select [GENERAL], then press it.
- 2** Rotate the control dial to select [TUNER-STP], then press it.
- 3** Rotate the control dial to select from [50K/9K], [100K/10K] or [200K/10K], then press it.

Setting the Clock

- 1** Press MENU, rotate the control dial to select [GENERAL], then press it.
- 2** Rotate the control dial to select [CLOCK-ADJ], then press it.
The hour indication flashes.
- 3** Rotate the control dial to set the hour and minute.
To move the digital indication, press SEEK +/-.
- 4** After setting the minute, press MENU.
The setup is complete and the clock starts.

To display the clock, press DSPL.

Connecting an iPod/USB Device

- 1** Turn down the volume on the unit.
- 2** Connect the iPod/USB device to the unit.
To connect an iPod/iPhone, use the USB connection cable for iPod (not supplied).

When connecting iPhone 5

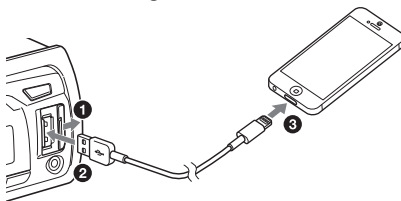

Connecting Other Portable Audio Device

- 1 Turn off the portable audio device.
- 2 Turn down the volume on the unit.
- 3 Connect the portable audio device to the AUX input jack (stereo mini jack) on the unit with a connecting cord* (not supplied).

* Be sure to use a straight type plug.

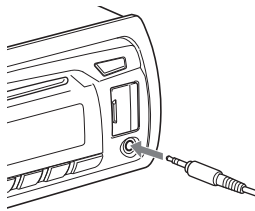

- 4 Press SRC to select [AUX].

To match the volume level of the connected device to other sources

Start playback of the portable audio device at a moderate volume, and set your usual listening volume on the unit.

Press MENU and rotate the control dial. Select [SOUND] → [AUX VOL] (page 13).

Listening to the Radio

Listening to the Radio

Tuning step setting is required (page 6).

To listen to the radio, press SRC to select [TUNER].

Storing automatically (BTM)

- 1 Press MODE to change the band (FM1, FM2, FM3, AM1 or AM2).
- 2 Press MENU, rotate the control dial to select [GENERAL], then press it.
- 3 Rotate the control dial to select [BTM], then press it.
The unit stores stations in order of frequency on the number buttons.

Tuning

- 1 Press MODE to change the band (FM1, FM2, FM3, AM1 or AM2).
- 2 Perform tuning.
To tune manually
Press and hold SEEK +/- to locate the approximate frequency, then press SEEK +/- repeatedly to fine adjust to the desired frequency.
To tune automatically
Press SEEK +/-.
Scanning stops when the unit receives a station. Repeat this procedure until the desired station is received.

Storing manually

- 1 While receiving the station that you want to store, press and hold a number button (1 to 6) to display [MEM].

Receiving the stored stations

- 1 Select the band, then press a number button (1 to 6).

Using Radio Data System (RDS)

Selecting program types (PTY)

Use PTY to display or search for a desired program type.

- 1 Press PTY during FM reception.
- 2 Rotate the control dial until the desired program type appears, then press it.
The unit starts to search for a station broadcasting the selected program type.

Type of programs

NEWS (News), **AFFAIRS** (Current Affairs), **INFO** (Information), **SPORT** (Sports), **EDUCATE** (Education), **DRAMA** (Drama), **CULTURE** (Culture), **SCIENCE** (Science), **VARIED** (Varied), **POP M** (Pop Music), **ROCK M** (Rock Music), **EASY M** (M.O.R. Music), **LIGHT M** (Light classical), **CLASSICS** (Serious classical), **OTHER M** (Other Music), **WEATHER** (Weather), **FINANCE** (Finance), **CHILDREN** (Children's program), **SOCIAL A** (Social Affairs), **RELIGION** (Religion), **PHONE IN** (Phone In), **TRAVEL** (Travel), **LEISURE** (Leisure), **JAZZ** (Jazz Music), **COUNTRY** (Country Music), **NATION M** (National Music), **OLDIES** (Oldies Music), **FOLK M** (Folk Music), **DOCUMENT** (Documentary)

Setting clock time (CT)

The CT data from the RDS transmission sets the clock.

- 1 Set [CT-ON] in **GENERAL** setup (page 12).

Playing a Disc

- 1 Insert the disc (label side up).

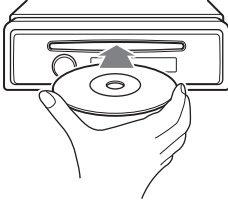

Playback starts automatically.

Playing an iPod/USB Device

In these Operating Instructions, “iPod” is used as a general reference for the iPod functions on an iPod and iPhone, unless otherwise specified by the text or illustrations.

For details on the compatibility of your iPod, see “About iPod” (page 15) or visit the support site on the back cover.

MSC (Mass Storage Class)-type USB devices (such as a USB flash drive, digital media player, Android™ phone) compliant with the USB standard can be used.

Depending on the digital media player or Android phone, setting the USB connection mode to MSC is required.

Notes

- For details on the compatibility of your USB device, visit the support site on the back cover.
- Playback of the following MP3/WMA files is not supported.
 - lossless compression files
 - copyright-protected files
 - DRM (Digital Rights Management) files
 - Multi-channel audio files

- 1 Connect an iPod/USB device to the USB port (page 6).

Playback starts.

If a device is already connected, to start playback, press SRC to select [USB] ([IPD] appears in the display when the iPod is recognized).

- 2 Adjust the volume on this unit.

To stop playback

Press and hold OFF for 1 second.

To remove the device

Stop playback, then remove the device.

Caution for iPhone

When you connect an iPhone via USB, phone call volume is controlled by the iPhone, not the unit. Do not inadvertently increase the volume on the unit during a call, as sudden loud sound may result when the call ends.

Operating an iPod directly (Passenger control)

Press and hold MODE during playback to display [MODE IPOD] to enable operation by the iPod directly.

Note that the volume can be adjusted only by the unit.

To exit passenger control

Press and hold MODE to display [MODE AUDIO].

Searching and Playing Tracks

Repeat play and shuffle play

- 1** During playback, press **↶** (repeat) for repeat play, or **SHUF** for shuffle play.
- 2** Press **↶** (repeat) or **SHUF** repeatedly to select the desired repeat or shuffle play mode.
Playback in selected play mode may take time to start.

Available play modes differ depending on the selected sound source.

Searching a track by name (Quick-BrowZer™)

- 1** During CD or USB playback, press **Q** (browse)* to display the list of search categories.
When the track list appears, press **↶** (back) repeatedly.
* During playback, press **Q** (browse) for more than 2 seconds to directly return to the beginning of the category list.
- 2** Rotate the control dial to select the desired search category, then press it to confirm.
- 3** Repeat step 2 to search the desired track.
Playback starts.

To exit the Quick-BrowZer mode

Press **Q** (browse).

Searching by skip items (Jump mode)

- 1** Press **Q** (browse)
- 2** Press **SEEK +**.
- 3** Rotate the control dial to select the item.
The list is jumped in steps of 10% of the total number of items.
- 4** Press **ENTER** to return to the Quick-BrowZer mode.
The selected item appears.
- 5** Rotate the control dial to select the desired item, then press it.
Playback starts.

Listening to Pandora®

Pandora® is available to stream music through your iPhone. You can control Pandora® on a USB-connected iPhone from this unit.

The Pandora® service is not available in some countries/regions.

Preparing for Pandora®

- 1 To check for compatible devices, visit the support site on the back cover.
- 2 Download the latest version of the Pandora® application from www.pandora.com

Streaming Pandora®

- 1 Connect the iPhone to this unit (page 6).
- 2 Press SRC to select [PANDORA USB].
- 3 Launch Pandora® application on the iPhone.

Available Operations in Pandora®

"Thumbs" feedback

"Thumbs Up" or "Thumbs Down" feedback allows you to personalize stations.

Thumbs Up

During playback, press ▲.

Thumbs Down

During playback, press ▼.

Using the station list

The station list allows you to easily select a desired station.

- 1 During playback, press Q (browse).
- 2 Press SEEK + to select the sorting order [BY DATE] or [A TO Z].
- 3 Rotate the control dial to select the desired station, then press it.
Playback starts.

Bookmarking

The track or artist currently being played can be bookmarked and stored in your Pandora® account.

- 1 During playback, press and hold MODE to select [BOOKMARK].
- 2 Rotate the control dial to select [TRK] (track) or [ART] (artist), then press it.

Canceling the DEMO Mode

You can cancel the demonstration display which appears while this unit is turned off.

- 1 Press MENU, rotate the control dial to select [DISPLAY], then press it.**
- 2 Rotate the control dial to select [DEMO], then press it.**
- 3 Rotate the control dial to select [DEMO-OFF], then press it.**
The setting is complete.
- 4 Press ↵ (back) twice.**
The display returns to normal reception/play mode.

Basic Setting Operation

You can set items in the menu to the following procedure.

The following items can be set depending on the source and setting.

- 1 Press MENU.**
- 2 Rotate the control dial to select the setup category, then press it.**
Setup categories are follows:
 - GENERAL setup (page 12)
 - SOUND setup (page 13)
 - DISPLAY setup (page 13)
- 3 Rotate the control dial to select the options, then press it.**

To return to the previous display

Press ↵ (back).

GENERAL Setup

CLOCK-ADJ (Clock Adjust) (page 6)

TUNER-STP (Tuner Step) (page 6)
(Available only when the unit is turned off.)

CAUT ALM (Caution Alarm)
Activates the caution alarm: [ON], [OFF] (page 5). (Available only when the unit is turned off.)

BEEP
Activates the beep sound: [ON], [OFF].

AUTO OFF
Shuts off automatically after a desired time when the unit is turned off: [NO], [30S] (30 seconds), [30M] (30 minutes), [60M] (60 minutes).

AUX-A (AUX Audio)
Activates the AUX source display: [ON], [OFF]. (Available only when the unit is turned off.)

CT (Clock Time)
Activates the CT function: [ON], [OFF].

BTM (page 7)

SOUND Setup

EQ3 PRESET

Selects an equalizer curve from the following equalizer curves or off: [XPLOD], [VOCAL], [EDGE], [CRUISE], [SPACE], [GRAVITY], [CUSTOM], [OFF].

The equalizer curve setting can be memorized for each source.

EQ3 SETTING

Sets [CUSTOM] of EQ3.

Selects the equalizer settings: [LOW], [MID], [HIGH].

To restore the factory-set equalizer curve, press and hold ENTER before the setting is complete.

BALANCE

Adjusts the sound balance: [RIGHT-15] – [CENTER] – [LEFT-15].

FADER

Adjusts the relative level: [FRONT-15] – [CENTER] – [REAR-15].

LOUDNESS (Dynamic Loudness)

Reinforces bass and treble for clear sound at low volume levels: [ON], [OFF].

SW LEVEL (Subwoofer Level)

Adjusts the subwoofer volume level: [+2 dB] - [0 dB] - [-2 dB].

AUX VOL (AUX Volume Level)

Adjusts the volume level for each connected auxiliary device: [+18 dB] - [0 dB] - [-8 dB].

This setting negates the need to adjust the volume level between sources.

DISPLAY Setup

DEMO (Demonstration)

Activates the demonstration: [ON], [OFF].

BLK OUT (Black Out)

Turns off the illumination automatically for any source (e.g., during radio reception/ CD playback, etc.) if no operation is performed for 5 seconds: [ON], [OFF].

To turn the light back on, press any button on the unit or the remote commander.

DIMMER

Changes the display brightness: [ON], [OFF].

COLOR (Preset Color - Dynamic Color Illuminator)

Sets a preset color for the display and buttons on the main unit.

Selects from 12 preset colors, 1 customized color and 5 preset patterns.

CUSTOM-C (Custom Color)

Registers a customized color for the display and buttons.

Selects a preset color as a basis for further customizing: [RGB RED], [RGB GRN], [RGB BLUE].

Adjustable color range: [0] - [32] ([0] cannot be set for all color ranges).

DAYNIGHT

Sets a different color for DAY/NIGHT mode according to the dimmer setting.

– [DAY]: [DIMMER] sets to [OFF].

– [NIGHT]: [DIMMER] sets to [ON].

AUTO SCR (Auto Scroll)

Scrolls long items automatically: [ON], [OFF].

M.DISPLAY (Motion Display)

Shows moving patterns: [ON], [OFF].

Additional Information

Precautions

- Cool off the unit beforehand if your car has been parked in direct sunlight.
- Do not leave the front panel or audio devices brought in inside the car, or it may cause malfunction due to high temperature in direct sunlight.
- Power antenna (aerial) extends automatically.

Moisture condensation

Should moisture condensation occur inside the unit, remove the disc and wait for about an hour for it to dry out; otherwise the unit will not operate properly.

To maintain high sound quality

Do not splash liquid onto the unit or discs.

Notes on discs

- Do not expose discs to direct sunlight or heat sources such as hot air ducts, nor leave it in a car parked in direct sunlight.
- Before playing, wipe the discs with a cleaning cloth from the center out. Do not use solvents such as benzine, thinner, commercially available cleaners.
- This unit is designed to play back discs that conform to the Compact Disc (CD) standard. DualDiscs and some of the music discs encoded with copyright protection technologies do not conform to the Compact Disc (CD) standard, therefore, these discs may not be playable by this unit.
- Discs that this unit CANNOT play
 - Discs with labels, stickers, or sticky tape or paper attached. Doing so may cause a malfunction, or may ruin the disc.



- Discs with non-standard shapes (e.g., heart, square, star). Attempting to do so may damage the unit.
- 8 cm (3 1/4 in) discs.

Notes on CD-R/CD-RW discs

- The maximum number of: (CD-R/CD-RW only)
 - folders (albums): 150 (including root folder)
 - files (tracks) and folders: 300 (may less than 300 if folder/file names contain many characters)
 - displayable characters for a folder/file name: 32 (Joliet)/64 (Romeo)
- If the multi-session disc begins with a CD-DA session, it is recognized as a CD-DA disc, and other sessions are not played back.
- Discs that this unit CANNOT play
 - CD-R/CD-RW of poor recording quality.
 - CD-R/CD-RW recorded with an incompatible recording device.
 - CD-R/CD-RW which is finalized incorrectly.
 - CD-R/CD-RW other than those recorded in music CD format or MP3 format conforming to ISO9660 Level 1/Level 2, Joliet/Romeo or multi-session.

Playback order of MP3/WMA files

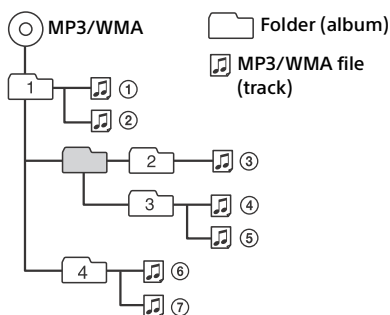

About iPod

- You can connect to the following iPod models. Update your iPod devices to the latest software before use.

Made for

- iPod touch (5th generation)
- iPod touch (4th generation)
- iPod touch (3rd generation)
- iPod touch (2nd generation)
- iPod classic
- iPod nano (7th generation)
- iPod nano (6th generation)
- iPod nano (5th generation)
- iPod nano (4th generation)
- iPod nano (3rd generation)
- iPod nano (2nd generation)
- iPod nano (1st generation)*
- iPhone 5
- iPhone 4S
- iPhone 4
- iPhone 3GS
- iPhone 3G

* Passenger control is not available for iPod nano (1st generation).

- “Made for iPod” and “Made for iPhone” mean that an electronic accessory has been designed to connect specifically to iPod or iPhone respectively and has been certified by the developer to meet Apple performance standards. Apple is not responsible for the operation of this device or its compliance with safety and regulatory standards. Please note that the use of this accessory with iPod or iPhone may affect wireless performance.

If you have any questions or problems concerning your unit that are not covered in this manual, consult your nearest Sony dealer.

Maintenance

Replacing the lithium battery of the remote commander

When the battery becomes weak, the range of the remote commander becomes shorter. Replace the battery with a new CR2025 lithium battery. Use of any other battery may present a risk of fire or explosion.

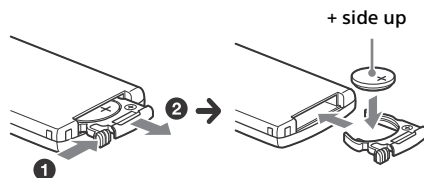

Notes on the lithium battery

- Keep the lithium battery out of the reach of children. Should the battery be swallowed, immediately consult a doctor.
- Wipe the battery with a dry cloth to assure a good contact.
- Be sure to observe the correct polarity when installing the battery.
- Do not hold the battery with metallic tweezers, otherwise a short-circuit may occur.

WARNING

Battery may explode if mistreated.
Do not recharge, disassemble, or dispose of in fire.

Cleaning the connectors

The unit may not function properly if the connectors between the unit and the front panel are not clean. In order to prevent this, detach the front panel (page 5) and clean the connectors with a cotton swab. Do not apply too much force. Otherwise, the connectors may be damaged.

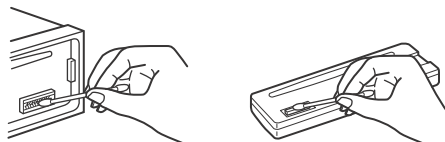

Notes

- For safety, turn off the ignition before cleaning the connectors, and remove the key from the ignition switch.
- Never touch the connectors directly with your fingers or with any metal device.

Specifications

Tuner section

FM

Tuning range:

- 87.5 – 108.0 MHz (at 50 kHz step)
- 87.5 – 108.0 MHz (at 100 kHz step)
- 87.5 – 107.9 MHz (at 200 kHz step)

FM tuning step:

50 kHz/100 kHz/200 kHz switchable

Antenna (aerial) terminal:

External antenna (aerial) connector

Intermediate frequency: 25 kHz

Usable sensitivity: 8 dBf

Selectivity: 75 dB at 400 kHz

Signal-to-noise ratio: 80 dB (stereo)

Separation: 50 dB at 1 kHz

Frequency response: 20 – 15,000 Hz

AM

Tuning range:

- 531 – 1,602 kHz (at 9 kHz step)
- 530 – 1,710 kHz (at 10 kHz step)

AM tuning step:

9 kHz/10 kHz switchable

Antenna (aerial) terminal:

External antenna (aerial) connector

Intermediate frequency:

- 9,124.5 kHz or 9,115.5 kHz/4.5 kHz (at 9 kHz step)
- 9,115 kHz or 9,125 kHz/5 kHz (at 10 kHz step)

Sensitivity: 26 μ V

CD Player section

Signal-to-noise ratio: 95 dB

Frequency response: 10 – 20,000 Hz

Wow and flutter: Below measurable limit

Corresponding codec:

MP3 (.mp3), and WMA (.wma)

USB Player section

Interface: USB (Full-speed)

Maximum current: 1 A

The maximum number of recognizable data:

- folders (albums): 128
- files (tracks) per folder: 512

Corresponding codec:

MP3 (.mp3), and WMA (.wma)

Power amplifier section

Output: Speaker outputs

Speaker impedance: 4 – 8 ohms

Maximum power output: 55 W \times 4 (at 4 ohms)

General

Outputs:

- Audio outputs terminal (rear, sub)
- Power antenna (aerial)/Power amplifier control terminal (REM OUT)

Inputs:

- Remote controller input terminal
- Antenna (aerial) input terminal
- AUX input jack (stereo mini jack)
- USB port

Power requirements: 12 V DC car battery (negative ground (earth))

Dimensions:

Approx. 178 mm \times 50 mm \times 177 mm
(7 1/8 in \times 2 in \times 7 in) (w/h/d)

Mounting dimensions:

Approx. 182 mm \times 53 mm \times 160 mm
(7 1/4 in \times 2 1/8 in \times 6 5/16 in) (w/h/d)

Mass: Approx. 1.2 kg (2 lb 11 oz)

Package contents:

- Main unit (1)
- Remote commander (1) : RM-X211
- Parts for installation and connections (1 set)

Your dealer may not handle some of the above listed accessories. Please ask the dealer for detailed information.

Design and specifications are subject to change without notice.

Copyrights

Quick-BrowZer is a trademark of Sony Corporation.

Windows Media is either a registered trademark or trademark of Microsoft Corporation in the United States and/or other countries.

This product is protected by certain intellectual property rights of Microsoft Corporation. Use or distribution of such technology outside of this product is prohibited without a license from Microsoft or an authorized Microsoft subsidiary.

iPhone, iPod, iPod classic, iPod nano, and iPod touch are trademarks of Apple Inc., registered in the U.S. and other countries.

MPEG Layer-3 audio coding technology and patents licensed from Fraunhofer IIS and Thomson.

Pandora, the Pandora logo, and the Pandora trade dress are trademarks or registered trademarks of Pandora Media, Inc., used with permission.

Android is a trademark of Google Inc. Use of this trademark is subject to Google Permissions.

Troubleshooting

The following checklist will help you remedy problems you may encounter with your unit. Before going through the checklist below, check the connection and operating procedures.

For details on using the fuse and removing the unit from the dashboard, refer to the installation/connections manual supplied with this unit.

If the problem is not solved, visit the support site on the back cover.

General

No power is being supplied to the unit.

- If the unit is turned off and the display disappears, the unit cannot be operated with the remote commander.
 - Turn on the unit.

No sound.

- The position of the fader control [FADER] is not set for a 2-speaker system.

No beep sound.

- An optional power amplifier is connected and you are not using the built-in amplifier.

The contents of the memory have been erased.

- The power supply lead or battery has been disconnected or not connected properly.

Stored stations and correct time are erased.

The fuse has blown.

Makes a noise when the position of the ignition is switched.

- The leads are not matched correctly with the car's accessory power connector.

During playback or reception, the demonstration mode starts.

- If no operation is performed for 5 minutes with [DEMO-ON] set, the demonstration mode starts.
 - Set [DEMO-OFF] (page 13).

The display disappears from/does not appear in the display window.

- The dimmer is set to [DIM-ON] (page 13).

- The display disappears if you press and hold OFF.
 - Press OFF on the unit until the display appears.
- The connectors are dirty (page 15).

The display disappears while the unit is operating.

- The Black Out function is set to on (page 13).

The operation buttons do not function. The disc will not eject.

- Press DSPL and ⬅ (back)/MODE for more than 2 seconds to reset the unit. The contents stored in memory are erased. For your safety, do not reset the unit while you are driving.

Radio reception

Stations cannot be received.

The sound is hampered by noises.

- The connection is not correct.
 - If your car has built-in radio antenna (aerial) in the rear/side glass, connect an REM OUT lead (blue/white striped) or accessory power supply lead (red) to the power supply lead of a car's antenna (aerial) booster.
 - Check the connection of the car antenna (aerial).
 - If the auto antenna (aerial) will not extend, check the connection of the power antenna (aerial) control lead.
- The tuning step setting has been erased.
 - Set the tuning step again (page 6).

Preset tuning is not possible.

- The broadcast signal is too weak.

RDS

PTY displays [- - - - -].

- The current station is not an RDS station.
- RDS data has not been received.
- The station does not specify the program type.

CD playback

The disc does not play back.

- Defective or dirty disc.

- The CD-R/CD-RW is not for audio use (page 14).

MP3/WMA files cannot be played back.

- The disc is incompatible with the MP3/WMA format and version. For details on playable discs and formats, visit the support site.

MP3/WMA files take longer to play back than others.

- The following discs take a longer time to start playback.
 - A disc recorded with a complicated tree structure.
 - A disc recorded in Multi Session.
 - A disc to which data can be added.

The sound skips.

- Defective or dirty disc.

USB playback

You cannot play back items via a USB hub.

- This unit cannot recognize USB devices via a USB hub.

A USB device takes longer to play back.

- The USB device contains files with a complicated tree structure.

The sound is intermittent.

- The sound may be intermittent at a high-bit-rate of more than 320 kbps.

Pandora® connection is not possible.

- Shut down the Pandora® application on the mobile device, and then launch it again.

Error displays/Messages

ERROR

- The disc is dirty or inserted upside down.
 - Clean or insert the disc correctly.
- A blank disc has been inserted.
- The disc cannot play due to a problem.
 - Insert another disc.
- USB device was not automatically recognized.
 - Connect it again.
- Press ▲ to remove the disc.

HUB NO SUPRT (hubs not supported)

- USB hub is not supported on this unit.

IPD STOP

- When repeat play is not set, playback of the last track in album finished.
The music application in the iPod/iPhone is terminated.
 - Press PAUSE to start playback again.

NO DEV (no device)

- [USB] or [PANDORA USB] is selected as source without a USB device connected. A USB device or a USB cable has been disconnected during playback.
 - Be sure to connect a USB device and USB cable.

NO MUSIC

- The disc or USB device does not contain a music file.
 - Insert a music CD.
 - Connect a USB device with a music file in it.

OVERLOAD

- USB device is overloaded.
 - Disconnect the USB device, then change the source by pressing SRC.
 - The USB device has a fault, or an unsupported device is connected.

PUSH EJT (push eject)

- The disc cannot be ejected.
 - Press ▲ (eject).

READ

- The unit is reading all track and album information on the disc.
 - Wait until reading is complete and playback starts automatically. Depending on the disc structure, it may take more than a minute.

USB NO SUPRT (USB not supported)

- The connected USB device is not supported.
 - For details on the compatibility of your USB device, visit the support site.

[LLLLL] or [RRRRR]

- During reverse or fast-forward, you have reached the beginning or the end of the disc and you cannot go any further.

[_]

- The character cannot be displayed.

For Pandora® operation:

CANNOT SKIP

- Skipping tracks on Pandora® is not allowed.
 - Wait until the commercial ends.
 - Pandora® limits the number of skips allowed on their service. Wait until the next track begins, or select another station on the list.

CHK DEV (check device)

- Pandora® does not launch.
 - Launch the Pandora® application and log into your account.

ERROR

- “Thumbs” feedback failed.
 - Try “Thumbs Up/Down” again.
- Bookmarking failed.
 - Try bookmarking again.

NO STATION

- There is no station on your Pandora® account.
 - Create the station on the mobile device.

NOT ALLOWED

- “Thumbs” feedback is not allowed.
 - Wait until the commercial ends.
 - Some functions, such as Shared Station, do not permit feedback. Wait until the next track begins, or select another station on the list.
- Bookmark is not allowed.
 - Wait until the commercial ends.
 - Select another track or station, then try it again.

OPEN APP (open application)

- Pandora® does not launch.
 - Launch the Pandora® application on the iPhone.

PAN NO SUPRT (Pandora® not supported)

- The connected device is not supported.
 - For details of compatible devices, visit the support site.

If these solutions do not help improve the situation, consult your nearest Sony dealer. If you take the unit to be repaired because of CD playback trouble, bring the disc that was used at the time the problem began.

Support site

If you have any questions or for the latest support information on this product, please visit the web site below:

<http://www.sony-asia.com/section/support>
<http://www.sony-asia.com/caraudio/>

<http://www.sony.net/>

©2013 Sony Corporation Printed in Thailand



* 4 4 6 6 7 6 5 5 1 * (1)