

Personal Audio System

Reference Guide **GB**

DREAM MACHINE



©2013 Sony Corporation Printed in China

<http://www.sony.net/>

ICF-DS15iPN



English

WARNING

To reduce the risk of fire or electric shock, do not expose this apparatus to rain or moisture.

To reduce the risk of fire or electric shock, do not cover the ventilation of the apparatus with newspapers, tablecloths, curtains, etc. And do not place lighted candles on the apparatus.

To reduce the risk of fire or electric shock, do not expose this apparatus to dripping or splashing, and do not place objects filled with liquids, such as vases, on the apparatus.

Do not install the appliance in a confined space, such as a bookcase or built-in cabinet.

Do not expose the batteries (battery pack or batteries installed) to excessive heat such as sunshine, fire or the like for a long time.

As the main plug is used to disconnect the unit from the mains, connect the unit to an easily accessible AC outlet. Should you notice an abnormality in the unit, disconnect the main plug from the AC outlet immediately.

The unit is not disconnected from the AC power source (mains) as long as it is connected to the wall outlet, even if the unit itself has been turned off.

The nameplate and important information concerning safety are located on the bottom exterior.

CAUTION

Danger of explosion if battery is incorrectly replaced. Replace only with the same type.

Precautions

- To disconnect AC power, grasp the plug itself, not the cord.
- Since a strong magnet is used for the speaker, keep credit cards using magnetic coding or spring-wound watches, CRT-based TVs, or projectors, etc., away from the unit to prevent possible damage from the magnet.
- Do not leave the unit in a location near a heat source such as a radiator or airduct, or in a place subject to direct sunlight, excessive dust, mechanical vibration, or shock.
- Allow adequate air circulation to prevent internal heat build-up. Do not place the unit on a surface (a rug, a blanket, etc.) or near materials (a curtain) which might block the ventilation holes.
- Should any solid object or liquid fall into the unit, unplug the unit and have it checked by qualified personnel before operating it any further.
- During a thunderstorm, do not touch the antenna (aerial) and plug.
- Do not touch the unit with wet hands.
- Do not place the unit anywhere near water.

NOTES ON LITHIUM BATTERY

- Wipe the battery with a dry cloth to assure a good contact.
- Be sure to observe the correct polarity when installing the battery.
- Do not hold the battery with metallic tweezers, otherwise a short-circuit may occur.

Note

- In the Reference Guide, "iPod" is used as a general reference to functions on an iPod or iPhone, unless otherwise specified by the text or illustrations.

If you have any questions or problems concerning your unit, please consult your nearest Sony dealer.

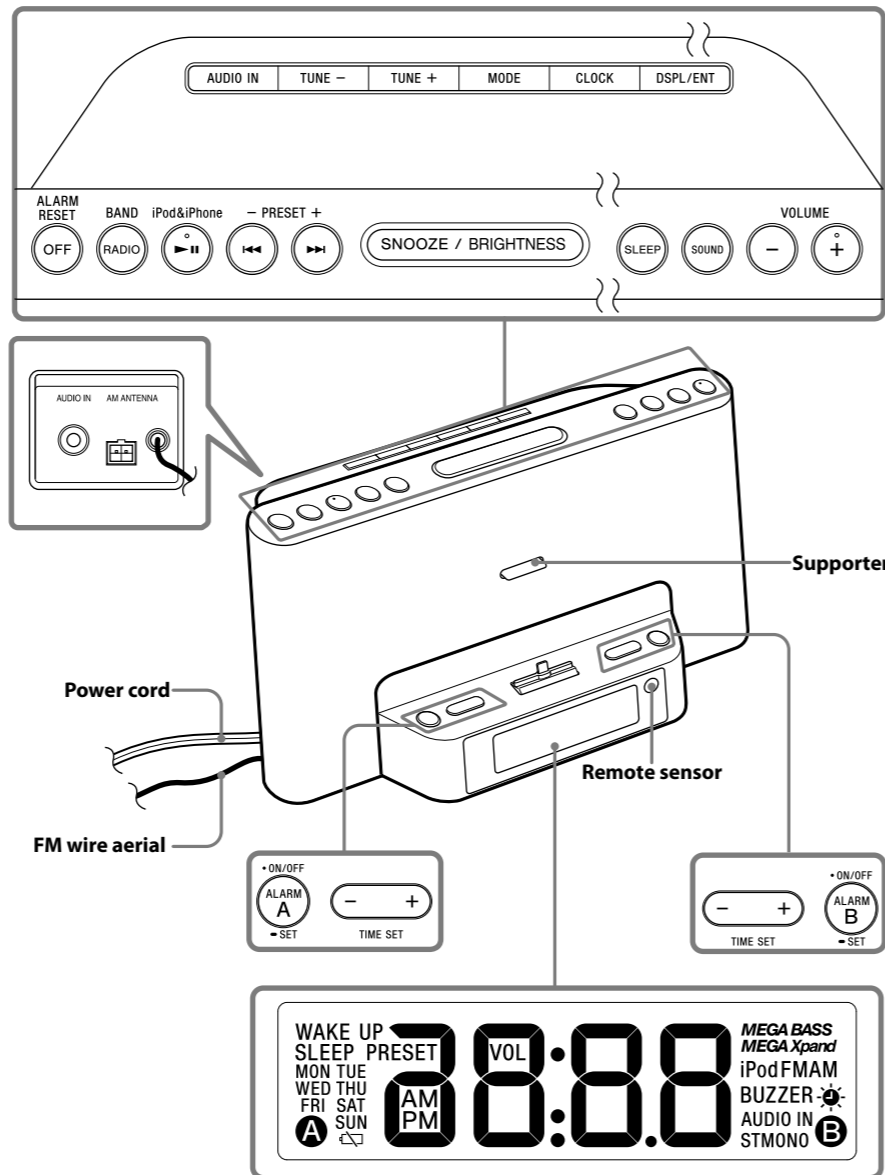

Display window (12-hour system)

The display differs depending on your country.

The **VOLUME +** and **▶II** buttons have a tactile dot.

Operations

Power source

This unit contains a CR2032 battery as a backup power source to keep the clock and the alarm operating during a power interruption (No Power No Problem system).

When to replace the battery

When the battery becomes weak, "⊖" appears in the display.

If a power interruption occurs while the battery is weak, the current time and alarm will be erased. Replace the battery with a Sony CR2032 lithium battery. Use of another battery may cause a fire or explosion.

To replace the battery

- 1 Keep the AC plug connected to the AC outlet and pry out the battery holder at the bottom of the unit using a thin tool, such as ballpoint pen, etc. (see Fig. ①).
- 2 Remove the old battery and insert a new one in the battery compartment with the ⊕ side facing up (see Fig. ②).
- 3 Replace the battery compartment lid.
- 4 Press **▶II**, **RADIO BAND**, **AUDIO IN** or **SNOOZE/BRIGHTNESS** on the unit to turn "⊖" off in the display.

Note

- When you replace the battery, do not disconnect the plug from the AC outlet. Otherwise, the current date, current time, alarm and station presets will be erased.

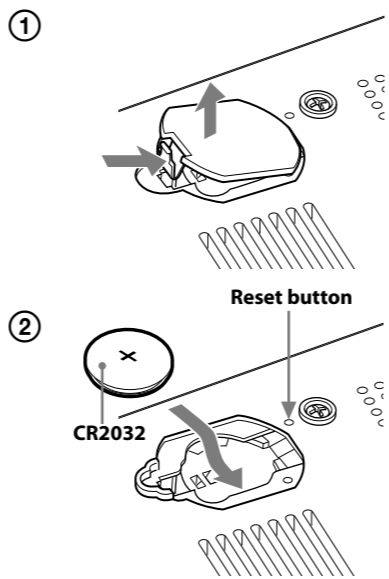

To reset the unit

Press the reset button with a pointed object if the unit fails to function properly. The current time, alarm and station presets, etc., will revert to their factory presets (see Fig. ②).

To charge your iPod

You can use the unit as a battery charger. Charging begins when the iPod is connected to the unit. The charging status appears in the display on iPod. For details, see the user's guide of your iPod.

Setting the clock

When using the unit for the first time after purchase, perform the following on the unit:

- 1 Remove the insulation film of the backup battery at the bottom of the unit.

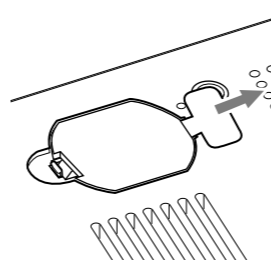

- 2 Plug in the unit.
- 3 Press and hold **CLOCK** until the year flashes in the display.
- 4 Press **TIME SET +** or **-** repeatedly to set the year, and then press **CLOCK**.
- 5 Repeat step 4 to set the month, day, hour and minute. The seconds start incrementing from zero.

Notes

- If you do not press any button for about 1 minute while setting the clock, the clock setting will be canceled.
- A 100-year calendar (2013 - 2112) is installed in the unit. When the date is set, the day of the week is automatically displayed. MON = Monday, TUE = Tuesday, WED = Wednesday, THU = Thursday, FRI = Friday, SAT = Saturday, SUN = Sunday
- The clock system varies depending on the model you own. 12-hour system: "AM 12:00" = midnight 24-hour system: "0:00" = midnight

To display the year and date

During clock display, press **CLOCK** on the unit once for the date, and press it again for the year. After a few seconds, the display will change back to the current time automatically.

To change the display to the summer time (daylight saving time) indication

Press and hold **CLOCK** and **SNOOZE/BRIGHTNESS** for at least 2 seconds.

"*" and "On" appear in the display and the time indication changes to the summer time (daylight saving time).

To deactivate the summer time (daylight saving time) adjustment, press and hold **CLOCK** and **SNOOZE/BRIGHTNESS** for at least 2 seconds again.

"*" and "OFF" appear in the display to show that summer time (daylight saving time) has been canceled.

Remote commander

Before using the supplied remote for the first time, remove the insulation film. Aim the remote at the (Remote sensor) of the unit.

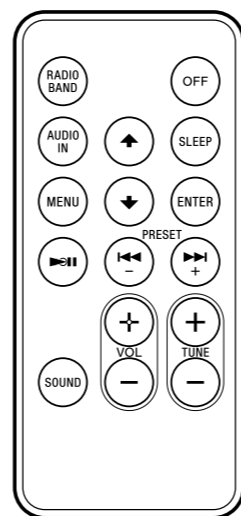

The **VOL +** and **▶II** buttons have a tactile dot.

OFF

- Terminate the current function and stop playback.
- Stop a currently sounding alarm/snooze timer.

▶II (Play/Pause)

- Start playing the iPod. Press again to pause/resume playback.

▶▶ (Forward)

- Go to the next track.
- Press and hold while listening to the sound to locate a desired point.

◀◀ (Backward)

- Go back to the previous track. During playback, this operation returns to the beginning of the current track. To go back to the previous track, press twice.
- Press and hold while listening to the sound to locate a desired point.

MENU

- Go back to the previous menu.

◆ (Up)/▼ (Down)

- Select a menu item or track for playback.

ENTER

- Execute the selected menu item or begin playback.

SOUND

- Select the desired sound effect(s). (For details, see "To enjoy the bass or expansion sound effect.")

VOL +/- (Volume plus/minus)

- Adjust the volume.

RADIO BAND

- Activate the radio and select a band.

PRESET +/-

- Select the preset number or preset station. (For details, see "Operating the radio.")

TUNE +/-

- Tune into a station when the radio is on.
- Press and hold to scan AM or FM stations.

AUDIO IN

- Activate the AUDIO IN function when an optional component is connected. (For details, see "Connecting optional components.")

SLEEP

- Set the sleep timer. (For details, see "Setting the sleep timer.")

Note

- Some operations may differ or may not be available on certain models of iPod.

When to replace the battery

With normal use, the battery (CR2025) should last for about 6 months. When the remote no longer operates the unit, replace the battery with a new one.

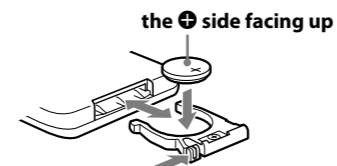

Notes

- If you are not going to use the remote for a long time, remove the battery to avoid any damage that may be caused by leakage and corrosion.
- **MENU**, **◆ (UP)**, **▼ (DOWN)**, and **ENTER** button on the main unit and/or on the supplied remote control will only work with the Apple devices (iPhone/iPod touch) installed up to iOS 6. It will not work with iOS 7 or later. In such case, please operate on the screen of Apple devices directly.

Operating an iPod

Compatible iPod/iPhone models

The compatible iPod/iPhone models are as follows.

Update software of your iPod/iPhone to the latest version before using it with this unit.

- iPhone 5s
- iPhone 5c
- iPhone 5
- iPod touch (5th generation)
- iPod nano (7th generation)*

* The remote command of "MENU," "◆," "▼," and "ENTER" will only work with iPhone and iPod touch.

On copyrights

iPhone, iPod, iPod nano, and iPod touch are trademarks of Apple Inc., registered in the U.S. and other countries. Lightning is a trademark of Apple Inc. "Made for iPod," and "Made for iPhone" mean that an electronic accessory has been designed to connect specifically to iPod or iPhone, respectively, and has been certified by the developer to meet Apple performance standards. Apple is not responsible for the operation of this device or its compliance with safety and regulatory standards. Please note that the use of this accessory with iPod or iPhone may affect wireless performance.

Note

- This unit is not specified for use with an iPad, and malfunction may result if used with one.

To play

- 1 Set an iPod on the dock connector. The dock connector can be tilted slightly.

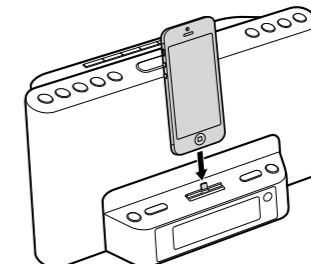

- 2 Press **▶II**. The iPod begins playback. You can operate the connected iPod via this unit or the iPod itself.
- 3 Adjust the volume using **VOLUME +** or **-** (**VOL +** or **-** on the remote).

To place and remove the iPod

When placing or removing the iPod, hold it at the same angle as the dock connector on the unit. Do not pull the iPod forward too far.

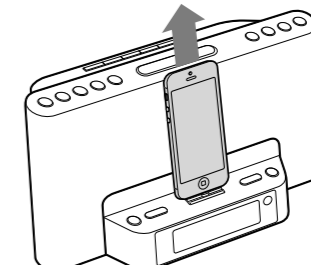

Notes

- If a pop-up message appears on the display of the iPod touch or iPhone, see "About App."
- An iPod in a case or cover can be set in this unit. However, if the case or cover interferes with the connection, remove the case or cover before setting the iPod on the dock connector.
- Do not twist or bend the iPod as this may result in connector damage.
- Remove the iPod when transporting it, otherwise a malfunction may result.
- When placing or removing the iPod, hold the unit securely.
- If the battery of your iPod is extremely low, charge it for a while before operation.
- If the iPod is already playing when set onto the unit, the sound from the iPod will be output from the unit speakers, even if the unit was playing sound from another function.
- Sony cannot accept responsibility in the event that data recorded to an iPod is lost or damaged when using an iPod connected to this unit.
- For details of environmental conditions for operating your iPod, check the website of Apple Inc.

Continued on the reverse side

