

Micro Hi-Fi Component System

Operating Instructions

Owner's Record

The model and serial numbers are located on the bottom. Record the serial number in the space provided below. Refer to them whenever you call upon your Sony dealer regarding this product.

Model No.

Serial No.



CMT-CQ1

WARNING

To prevent fire or shock hazard, do not expose the unit to rain or moisture.

To prevent fire, do not cover the ventilation of the apparatus with news papers, table-cloths, curtains, etc. And don't place lighted candles on the apparatus.

To prevent fire or shock hazard, do not place objects filled with liquids, such as vases, on the apparatus.

Do not install the appliance in a confined space, such as a bookcase or built-in cabinet.

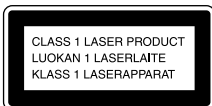

This appliance is classified as a CLASS 1 LASER product. This label is located on the rear exterior.



Don't throw away the battery with general house waste, dispose of it correctly as chemical waste.

Except for European model



ENERGY STAR[®] is a U.S. registered mark. As an ENERGY STAR[®] partner, Sony Corporation has determined that this product meets the ENERGY STAR[®] guidelines for energy efficiency.

NOTICE FOR THE CUSTOMERS IN THE U.S.A.

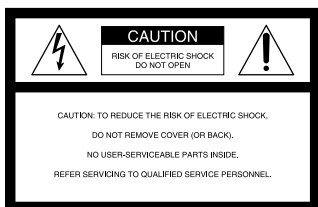

This symbol is intended to alert the user to the presence of uninsulated "dangerous voltage" within the product's enclosure that may be of sufficient magnitude to constitute a risk of electric shock to persons.



This symbol is intended to alert the user to the presence of important operating and maintenance (servicing) instructions in the literature accompanying the appliance.

CAUTION

The use of optical instruments with this product will increase eye hazard.

WARNING

This equipment has been tested and found to comply with the limits for a Class B digital device, pursuant to Part 15 of the FCC Rules. These limits are designed to provide reasonable protection against harmful interference in a residential installation. This equipment generates, uses, and can radiate radio frequency energy and, if not installed and used in accordance with the instructions, may cause harmful interference to radio communications. However, there is no guarantee that interference will not occur in a particular installation. If this equipment does cause harmful interference to radio or television reception, which can be determined by turning the equipment off and on, the user is encouraged to try to correct the interference by one or more of the following measures:

- Reorient or relocate the receiving antenna.
- Increase the separation between the equipment and receiver.
- Connect the equipment into an outlet on a circuit different from that to which the receiver is connected.
- Consult the dealer or an experienced radio/TV technician for help.

CAUTION

You are cautioned that any changes or modifications not expressly approved in this manual could void your authority to operate this equipment.

Note to CATV system installer:

This reminder is provided to call the CATV system installer's attention to Article 820-40 of the NEC that provides guidelines for proper grounding and, in particular, specifies that the cable ground shall be connected to the grounding system of the building, as close to the point of cable entry as practical.

NOTICE FOR THE CUSTOMERS IN CANADA

CAUTION

TO PREVENT ELECTRIC SHOCK, DO NOT USE THIS POLARIZED AC PLUG WITH AN EXTENSION CORD, RECEPTACLE OR OTHER OUTLET UNLESS THE BLADES CAN BE FULLY INSERTED TO PREVENT BLADE EXPOSURE.

How to use this manual

This manual mainly explains operations using the remote, but the same operations can also be performed using the buttons on the system having the same or similar names.

Table of Contents

How to use this manual.....	2
<hr/>	
Getting Started	
Hooking up the system.....	4
Setting the clock.....	5
<hr/>	
CD – Play	
Loading a disc	6
Playing a disc	6
— Normal Play/Shuffle Play	
Playing repeatedly.....	7
— Repeat Play	
Creating your own program	7
— Program Play	
<hr/>	
Tuner	
Presetting radio stations	8
Listening to the radio	10
— Preset Tuning	
— Manual Tuning	
<hr/>	
Sound Adjustment	
Adjusting the sound	10
<hr/>	
Timer	
Falling asleep to music.....	11
— Sleep Timer	
Waking up to music	11
— Daily Timer	
<hr/>	
Display	
Turning off the display.....	12
— Power Saving Mode	
Adjusting the brightness of the display's backlight	13
Viewing information about the disc in the display	13
<hr/>	
Optional Components	
Hooking up optional components	14
<hr/>	
Troubleshooting	
Problems and remedies	15
Messages	16

Additional Information

Precautions.....	17
Specifications.....	18
List of button locations and reference pages	20

Getting Started

Hooking up the system

Perform the following procedures **1** to **3** to hook up your system using the supplied cords and accessories.

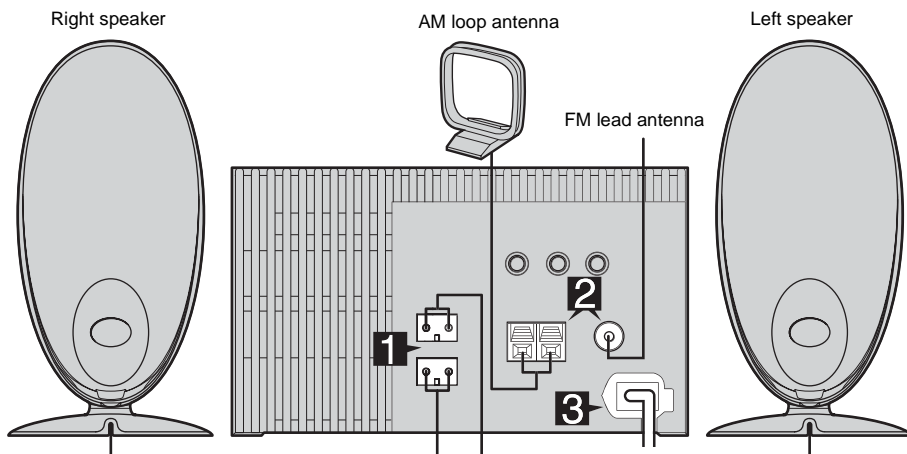

1 Connect the speakers.

Connect the right and left speaker cords to the SPEAKER terminals as shown below.

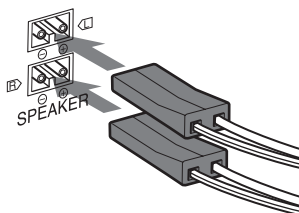

2 Connect the FM and AM antennas.

Set up the AM loop antenna, then connect it.

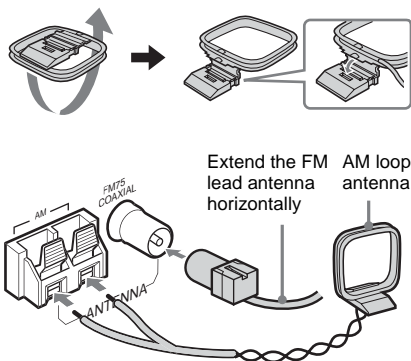

Note

Keep the antennas away from the speaker cords.

3 Connect the power cord to a wall outlet.

If the plug does not fit the wall socket, detach the supplied plug adaptor (only for models equipped with an adaptor).

To turn on the system, press I/O.

Inserting two R6 (size AA) batteries into the remote

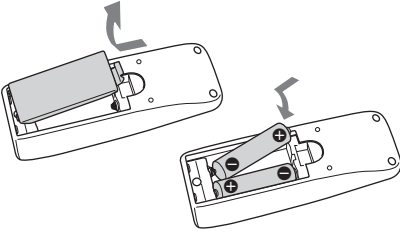

Note

If you do not use the remote for a long period of time, remove the batteries to avoid possible damage from battery leakage and corrosion.

Tip

When the remote no longer operates the system, replace both batteries with new ones.

Setting the clock

Use buttons on the remote for the operation.

- 1** Press I/⏻ to turn on the system.
- 2** Press CLOCK/TIMER SET.
- 3** Press ◀◀/▶▶ repeatedly to set the hour.
- 4** Press ENTER or ▶▶.
- 5** Press ◀◀/▶▶ repeatedly to set the minute.
- 6** Press ENTER.

The clock starts working.

To adjust the clock

- 1** Press CLOCK/TIMER SET.
- 2** Press ◀◀/▶▶ repeatedly to select "CLOCK", then press ENTER.
- 3** Do the same procedures as step 3 to 6 above.

CD – Play

Loading a disc

- 1 Press OPEN/CLOSE ▲.
- 2 Place a disc with the label side up on the disc tray.

When you play an 8 cm disc, place it on the inner circle of the tray.

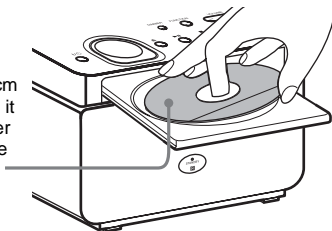

- 3 Press OPEN/CLOSE ▲ again to close the disc tray.

Notes

- Do not use a disc with tape, seals or paste on it as this may cause malfunction.
- Do not forcibly press the disc tray closed with your finger, as this may cause malfunction.
- Do not place any objects on top of the unit.

Playing a disc

— Normal Play/Shuffle Play

This system lets you play the disc in different play modes.

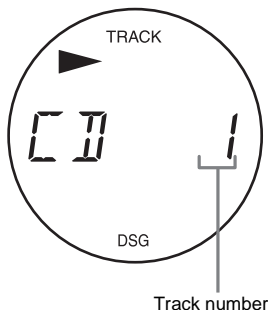

- 1 Press FUNCTION repeatedly to switch the function to CD.
- 2 Press PLAY MODE on the remote in stop mode repeatedly until the mode you want appears in the display.

Select	To play
No display (Normal Play)	The tracks on the disc in original order.
SHUF (Shuffle Play)	All tracks on the disc in random order.
PGM (Program Play)	The tracks on the disc in the order you want them to be played (see “Creating your own program” on page 7).

- 3 Press CD ►.

Note

You cannot change the play mode during playback.

Tip

When disc access takes a long time, set “CD POWER ON” by the CD power manage function (page 9).

Other operations

To	Do this
Stop play	Press ■.
Pause	Press II. Press again to resume play.
Select a track	Press I◀◀/▶▶ repeatedly.
Find a point in a track (Search)	Keep pressing ◀◀/▶▶ on the remote during playback and release it at the desired point.
Remove a disc	Press OPEN/CLOSE ▲.

Playing repeatedly

— Repeat Play

You can play all the tracks or a single track on a disc.

Press REPEAT on the remote during playback until “REP” or “REP1” appears.

REP: For all the tracks on the disc up to five times.

REP1: For a single track only.

To cancel Repeat Play

Press REPEAT on the remote repeatedly until both “REP” and “REP1” disappear.

Creating your own program

— Program Play

You can make a program of up to 25 steps.

- 1 Press **FUNCTION** repeatedly to switch the function to CD.
- 2 Press **PLAY MODE** on the remote in stop mode repeatedly until “PGM” appears.
- 3 Press I◀◀/▶▶I repeatedly until the desired track number appears.

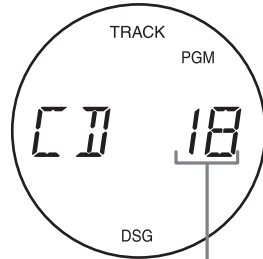

Selected track number

- 4 Press **ENTER** on the remote.

The track is programmed.

The last programmed track number appears, followed by the step number.

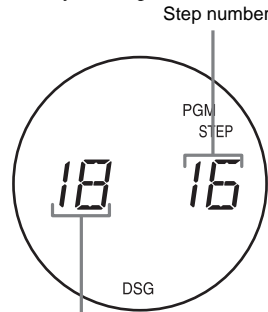

Last programmed track number

- 5 To program additional tracks, repeat steps 3 and 4.

- 6 Press **CD** ▶.

Program Play starts.

continued

Other operations

To	Do this
Check the program order	Press ◀◀/▶▶ repeatedly during program play.
Cancel Program Play	Press PLAY MODE on the remote in stop mode repeatedly until both “PGM” and “SHUF” disappear.
Add a track to the end of the program	Perform steps 1 – 4 in stop mode.
Erase the program	Press CLEAR on the remote in stop mode. Each time you press the button, a track is cleared from the end of the program.

Tips

- The program you made remains after Program Play finishes. To play the same program again, press **CD ▶**. However, the program is cleared when you open the disc tray.
- If you select “CD AL” in step 3, you can select all tracks on the disc at once.

Tuner

Presetting radio stations

You can preset up to 20 FM stations and 10 AM stations. You can then tune in any of those stations simply by selecting the corresponding preset number.

Use buttons on the remote for the operation.

Automatic tuning preset

You can automatically tune in all of the stations that can be received in your area and then store the radio frequency of the desired stations.

- 1 Press TUNER BAND repeatedly to select FM or AM.**
- 2 Press TUNING MODE repeatedly until “AUTO” and the frequency appear in the display.**
- 3 Press TUNING +/-.**

The frequency changes as the system scans for a station. Scanning stops automatically when a station is tuned in. At that time, “TUNED” and “STEREO” (for stereo program only) appear.

If “TUNED” does not appear and the scanning does not stop

Set the frequency of the desired radio station as described in steps 2 through 6 of “Manual tuning preset” (page 9).

- 4 Press TUNER MEMORY.**

The preset number flashes. The stations are stored from preset number 1.

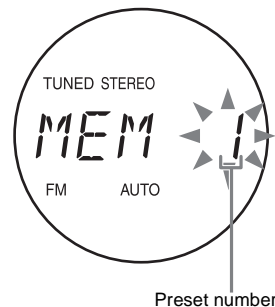

5 Press ENTER.

6 Repeat steps 1 through 5 to preset other stations.

Tip

Press TUNING MODE to stop scanning.

Manual tuning preset

You can manually tune in and store the radio frequency of the desired stations.

- 1 Press TUNER BAND repeatedly to select FM or AM.**
- 2 Press TUNING MODE repeatedly until "AUTO" and the preset number disappear from the display.**
- 3 Press TUNING +/- repeatedly to tune in the desired station.**
- 4 Press TUNER MEMORY.**
The preset number flashes. The stations are stored from preset number 1.
- 5 Press ENTER.**
- 6 Repeat steps 1 through 5 to preset other stations.**

Other Operations

To	Do this
Tune in a station with a weak signal	Follow the procedure described in "Manual tuning preset" (page 9).
Set another station to the existing preset number	After step 4, press TUNING +/- repeatedly to select the preset number you want to store the station and then press ENTER.

To improve tuner reception

When tuner reception is poor, set CD player power off by the CD power manage function. CD power is factory set to on.

- 1 Press FUNCTION repeatedly to switch the function to CD.**
- 2 Press I/⏻ to turn off the system.**
- 3 Press I/⏻ while holding ■.**
"CD POWER OFF" appears.

To set the CD power on

Repeat the procedure above and "CD POWER ON" appears.

Note

When "CD POWER OFF" is selected, CD access time is increased.

To change the AM tuning interval (except for European and Middle Eastern models)

The AM tuning interval is factory-preset to 9 kHz (or 10 kHz for some areas). To change the AM tuning interval, tune in any AM station first, then turn off the system. While holding ►►, press I/⏻. When you change the interval, all the AM preset stations are erased. To reset the interval, tune in any AM station first, then turn off the system. While holding ►►, press I/⏻.

Note

You cannot change the AM tuning interval in the Power Saving Mode.

Tips

- The preset stations are retained for about a day even if you disconnect the power cord or if a power failure occurs.
- To improve the reception, adjust the supplied antennas or connect an external antenna.

Listening to the radio

You can listen to a radio station either by selecting a preset station, or by manually tuning in the station.

Use buttons on the remote for the operation.

Listening to a preset station

— *Preset Tuning*

Preset radio stations in the tuner's memory first (see "Presetting radio stations" on page 8).

- 1 Press TUNER BAND repeatedly to select FM or AM.**
- 2 Press TUNING MODE repeatedly until the preset number appears in the display.**
- 3 Press TUNING +/- repeatedly to select the desired preset station.**

Listening to non-preset radio station

— *Manual Tuning*

- 1 Press TUNER BAND repeatedly to select FM or AM.**
- 2 Press TUNING MODE repeatedly until "AUTO" and the preset number disappear from the display.**
- 3 Press TUNING +/- repeatedly to tune in the desired station.**

Tips

- To improve broadcast reception, adjust the supplied antennas, or connect a commercially available external antenna.
- When an FM stereo program has static noise, press FM MODE until "MONO" appears. There will be no stereo effect, but the reception will improve.
- In step 2, press TUNING MODE repeatedly until "AUTO" and the frequency appear in the display, then press TUNING +/- . The frequency indication changes and scanning stops when the system tunes in a station (Automatic Tuning).

Sound Adjustment

Adjusting the sound

You can adjust the bass and treble to enjoy more powerful sound.

Use buttons on the remote for the operation.

Generating a more dynamic sound (Dynamic Sound Generator)

Press DSG.

To cancel the DSG, press DSG again.

Adjusting the bass and treble

- 1 Press BASS to adjust the bass, or TREBLE to adjust the treble.**
- 2 Press EQ +/- repeatedly to adjust the level.**

Tip

To cancel the bass or treble adjustment, press CENTER in step 2.

Adjusting the balance

You can adjust the left-right speaker balance.

- 1 Press BALANCE.**
- 2 Press EQ +/- repeatedly to adjust the balance.**

Tip

To cancel the balance adjustment, press CENTER in step 2.

Falling asleep to music

— Sleep Timer

You can set the system to turn off after a certain time, so that you can fall asleep to music. Use buttons on the remote for the operation.

Press SLEEP repeatedly.

Each time you press the button, the minute display (the turn-off time) changes cyclically as follows:

OFF → AUTO* → 90 → 80 → ... → 10

* The system automatically turns off in 100 minutes or after the current CD finishes playing.

Other operations

To	Press
Check the remaining time**	SLEEP once.
Change the time to turn off	SLEEP repeatedly to select the time you want.
Cancel the Sleep Timer function	SLEEP repeatedly until "OFF" appears.

**You cannot check the remaining time if you select "AUTO".

Tip

You can use the Sleep Timer, even if you have not set the clock.

Waking up to music

— Daily Timer

You can wake up to music at a preset time. Make sure you have set the clock (see "Setting the clock" on page 5).

Use buttons on the remote for the operation.

1 Prepare the sound source you want to play.

- CD: Load a disc. To start from a specific track, make a program (see "Creating your own program" on page 7).
- TUNER: Tune in a radio station (see "Listening to the radio" on page 10).

2 Press VOL +/- repeatedly to adjust the volume.

3 Press CLOCK/TIMER SET.

"SET" appears.

4 Press ◀▶ repeatedly to select "DAILY", then press ENTER.

"ON" appears and the hour indication flashes.

5 Set the time to start playing.

Press ◀▶ repeatedly to set the hour, then press ENTER.

The minute indication flashes.

Press ◀▶ repeatedly to set the minute, then press ENTER.

6 Set the time to stop playing following the same procedure as step 5.

7 Press ◀▶ to select the desired sound source.

Each time you press the button, the display changes as follows:

TUNER ↔ CD

8 Press ENTER.

The start time, the stop time, and the sound source appear in turn, before the original display returns.

9 Press I/⏻ to turn off the system.

Other operations

To	Do this
Change the setting	Start over from step 1.
Check the setting/ activate the timer	<ol style="list-style-type: none">1 Press CLOCK/TIMER SELECT.2 Press ◀◀/▶▶ until "DAILY" appears, then press ENTER.
Cancel the timer	<ol style="list-style-type: none">1 Press CLOCK/TIMER SELECT.2 Press ◀◀/▶▶ until "OFF" appears, then press ENTER.

Notes

- If you use the Daily Timer and the Sleep Timer at the same time, the Sleep Timer has priority.
- Do not operate the system from the time the system turns on until the play starts (about 15 seconds before the preset time).
- If the system is on about 15 seconds before the preset time, the Daily Timer will not be activated.
- You cannot use the optional component connected to PC/MD/TAPE IN jack as sound sources for the Daily Timer.

Display

Turning off the display

— Power Saving Mode

The clock display can be turned off to minimize the amount of power consumed during standby (Power Saving Mode).

Press DISPLAY on the remote when the system is off.

To cancel Power Saving Mode

Press DISPLAY on the remote.

Tip

The timer continues to operate in Power Saving Mode.

Note

You cannot perform the following operations in Power Saving Mode.

- setting the clock
- changing the AM tuning interval (except for European and Middle Eastern models)
- turning on the system by pressing the function buttons

Adjusting the brightness of the display's backlight

You can change the brightness of the display's backlight.

Press DIMMER on the unit repeatedly.

The backlight's brightness changes cyclically.

Tip

The brightness level is factory set at high.

Viewing information about the disc in the display

You can check the playing time and remaining time of the current track or that of the disc.

Checking the remaining time (CD)

Press DISPLAY on the remote repeatedly during playback.

Each time you press the button, the display changes cyclically as follows:

Track number → Elapsed playing time on the current track → Remaining time on the current track → Remaining time on the current disc* → Clock display → BASS level → TREBLE level

* “-.-” appears during Program Play.

Checking the total playing time (CD)

Press DISPLAY on the remote repeatedly in stop mode.

Each time you press the button, the display changes cyclically as follows:

■ During Program Play with a program

Last track number → Total playing time of the program** → Total number of programmed tracks → Clock display → BASS level → TREBLE level

**“-.-” appears when the total playing time of the disc exceeds 100 minutes or when the selected track number is 21 or above for a disc with 21 tracks or more.

■ During other times

Total number of tracks → Total playing time → Clock display → BASS level → TREBLE level

Optional Components

Hooking up optional components

To enhance your system, you can connect optional components. Refer to the operating instructions provided with each component.

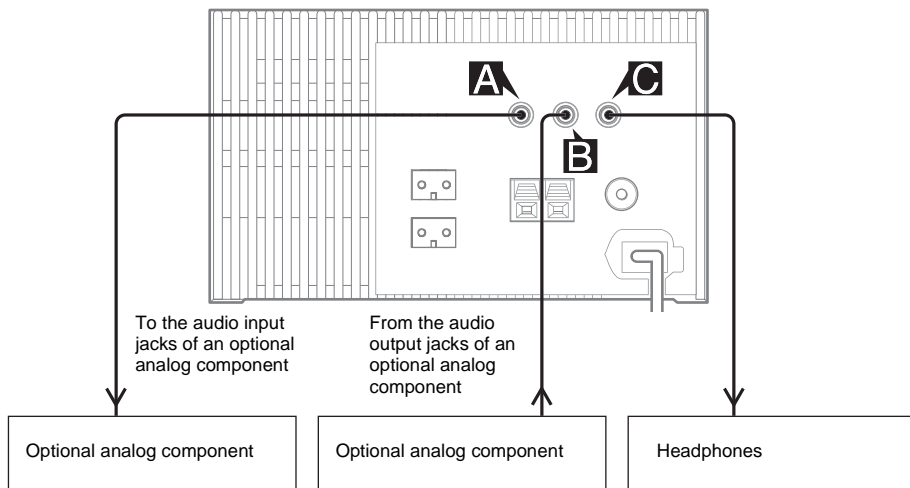

A PC/MD/TAPE OUT jack

Use an audio cord (not supplied) to connect an optional component (MD deck, etc.) to this jack. You can then output sound to that component from this system.

B PC/MD/TAPE IN jack

Use an audio cord (not supplied) to connect an optional component (MD deck, etc.) to this jack. You can then listen to the sound from that component through this system.

C PHONES jack

Connect headphones to this jack.

Listening to audio from a connected component

- 1 Connect the audio cord.
See "Hooking up optional components" on page 14.
- 2 Press **FUNCTION** repeatedly until "PC" (or "MD" or "TAPE") appears.
- 3 While pressing and holding **■** on the unit, press **I/⏻** on the unit repeatedly until the desired sound source ("PC", "MD" or "TAPE") appears.
Start playing the connected component.

Recording on a connected component

Making an analog recording

- 1 Connect the audio cord.
- 2 Start recording.
Refer to the operating instructions provided with connected component.

Problems and remedies

Should you encounter a problem with your system, do the following:

- 1 Make sure the power cord and speaker cords are correctly and firmly connected.
- 2 Find your problem in the troubleshooting checklist below and take the indicated corrective action.

If the problem persists after doing all of the above, consult your nearest Sony dealer.

General

The clock indication does not show the correct time.

- A power interruption has occurred. Set the clock (page 5) and timer setting (page 11) again.

There is no sound.

- Press VOL + repeatedly.
- Make sure the headphones are not connected.
- Check the speaker connections (page 4).

Sound comes from one channel, or unbalanced left and right volume.

- Check the speaker connection and speaker placement.
- Connect the supplied speakers.

There is severe hum or noise.

- Move the system away from the source of noise.
- Connect the system to a different wall outlet.
- Install a noise filter (commercially available) to the power line.

The timer cannot be set.

- Set the clock correctly (page 5).

The timer does not function.

- Activate the timer (page 12).
- Check the timer setting and set the correct time (page 11).
- Cancel the Sleep Timer function (page 11).

The remote does not function.

- Remove the obstacle.
- Move the remote closer to the system.
- Point the remote at the system's sensor.
- Replace the batteries (R6/size AA).
- Locate the system away from the fluorescent light.

The color irregularity on a TV screen persists.

- Turn off the TV set once, then turn it on after 15 to 30 minutes. If the color irregularity still persists, place the speakers farther away from the TV set.

CD player

The disc tray does not open and "LOCK" appears in the display.

- Consult your nearest Sony dealer or local authorized Sony service facility.

The disc tray does not close.

- Place the disc correctly in the center of the tray.
- Always close the tray by pressing OPEN/CLOSE . Trying to press the tray closed with your fingers may cause problems with the player.

The disc does not eject.

- Consult your nearest Sony dealer.

Play does not start.

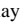
- Open the disc tray and check whether a disc is loaded.
- Wipe the disc clean (page 17).
- Replace the disc.
- Place the disc that this system can play.
- Place the disc correctly in the center of the tray.
- Place the disc in the tray with the label side up.
- Remove the disc and wipe away the moisture on the disc, then leave the system turned on for a few hours until the moisture evaporates.
- Press CD  to start play.

Disc access takes a long time.

- Set "CD POWER ON" by the CD power manage function (page 9).

The sound skips.

- Wipe the disc clean (page 17).
- Replace the disc.
- Try moving the system to a place without vibration (e.g., on top of a stable stand).
- Try moving the speakers away from the system, or placing them on separate stands. When you listen to a track with bass sounds at high volume, the speaker vibration may cause the sound to skip.

Play does not start from the first track.

- Press PLAY MODE on the remote repeatedly until both "PGM" and "SHUF" disappear to return to Normal Play.

Tuner

Severe hum or noise/stations cannot be received.

- Set the proper band and frequency (page 10).
- Connect the antenna properly (page 4).
- Find a place and an orientation that provide good reception, then set up the antenna again. If you cannot obtain good reception, we recommend you connect a commercially available external antenna.
- The supplied FM lead antenna receives signals along its entire length, so make sure you extend it fully.
- Locate the antennas as far away from the speaker cords as possible.
- Consult your nearest Sony dealer if the supplied AM antenna has come off the plastic stand.
- Try turning off surrounding electrical equipment.
- Set “CD POWER OFF” by the CD power manage function (page 9).

A stereo FM program cannot be received in stereo.

- Press FM MODE on the remote until “FM ST” appears in the display.

Optional components

There is no sound.

- Refer to General item “There is no sound.” (page 15) and check the condition of the system.
- Connect the component properly (page 14) while checking:
 - if the cords are connected properly.
 - if the cord plugs are firmly inserted all the way.
- Turn on the connected component.
- Refer to the operating instructions supplied with the connected component and start playing.
- Press FUNCTION repeatedly until “PC” (or “MD” or “TAPE”) appears (page 14).

The sound is distorted.

- Set the volume of the connected component lower.
 - The external input may be excessively large. Set the external function to “MD” (page 14).
-

If the system still does not operate properly after performing the above measures, reset the system as follows:

With the system turned on, press ■, FUNCTION and I/⏪ at the same time. The system is reset to the factory settings. You should set the settings you made, such as the preset stations, clock, and timer.

Messages

One of the following messages may appear or flash in the display during operation.

CD

NO CD

There is no disc in the player.

OVER

You have reached the end of the disc while pressing and holding ►► on the remote during playing pause.

READ

The CD player is reading the TOC information of the CD.

PUSH/STOP

You pressed PLAY MODE on the remote during playback. “PUSH” and “STOP” alternately appear in the display.

Precautions

On operating voltage

Before operating the system, check that the operating voltage of your system is identical with the voltage of your local power supply.

On safety

- The unit is not disconnected from the AC power source (mains) as long as it is connected to the wall outlet, even if the unit itself has been turned off.
- Unplug the system from the wall outlet (mains) if it is not to be used for an extended period of time. To disconnect the power cord (mains lead), pull it out by the plug. Never pull the cord itself.
- Should any solid object or liquid fall into the system, unplug the system and have it checked by qualified personnel before operating it any further.
- AC power cord must be changed only at the qualified service shop.
- The nameplate is located on the bottom exterior.

On placement

- Do not place the system in an inclined position.
- Do not place the system in locations where it is;
 - Extremely hot or cold
 - Dusty or dirty
 - Very humid
 - Subject to vibrations
 - Subject to direct sunlight.
- Use caution when placing the unit or speakers on surfaces that have been specially treated (with wax, oil, polish, etc.) as staining or discoloration of the surface may result.

On heat buildup

- Although the system heats up during operation, this is not a malfunction.
- Place the system in a location with adequate ventilation to prevent heat build-up in the system.
- If you continuously use this system at a high volume, the cabinet temperature of the top, side and bottom rises considerably. To avoid burning yourself, do not touch the cabinet.
- To prevent a malfunction, do not cover the ventilation hole.

On the speaker system

This speaker system is not magnetically shielded and the picture on TV sets may become magnetically distorted. In such a case, turn off the TV set once, and after 15 to 30 minutes turn it on again.

If there seems to be no improvement, locate the speaker system further away from the TV set. Also, be sure not to place objects in which magnets are attached or used near the speaker system, such as audio racks, TV stands and toys. These way cause magnetic distortion to the picture due to their interaction with the system.

On operation

- If the system is brought directly from a cold to a warm location, or is placed in a very damp room, moisture may condense on the lens inside the CD player. Should this occur, the system will not operate properly. Remove the disc and leave the system turned on for about an hour until the moisture evaporates.
- When you move the system, take out any disc.

If you have any questions or problems concerning your system, please consult your nearest Sony dealer.

Notes on discs

- Before playing, clean the disc with a cleaning cloth. Wipe the disc from the center out.
- Do not use solvents such as benzene, thinner, commercially available cleaners or anti-static spray intended for vinyl LPs.
- Do not expose the disc to direct sunlight or heat sources such as hot air ducts, nor leave it in a car parked in direct sunlight.
- Do not use discs encircled with a protection ring. This may cause a malfunction to the system.
- When using discs that have glue or similar tacky substance on the label side of the disc or that used a special ink when the label was printed, there is a chance that the disc or label may become attached to parts inside this unit. When this occurs, it may not be possible to remove the disc, and may also cause this unit to malfunction. Be sure to check that the label side of the disc is not sticky before using.
The following types of disc should not be used:
 - Rental or used discs with attached seals where the glue extends beyond the seal. The perimeter of the seal on the disc is tacky.
 - Discs that have labels printed using a special ink that feels tacky when touched.
- Discs with non-standard shapes (e.g., heart, square, star) cannot be played on this unit. Attempting to do so may damage the unit. Do not use such discs.

Note on CD-R/CD-RW playback

Discs recorded on CD-R/CD-RW drives may not be played back because of scratches, dirt, recording condition or the drive's characteristics. Besides, the discs, which are not yet finalized at the end of recording, cannot be played back.

Music discs encoded with copyright protection technologies

This product is designed to playback discs that conform to the Compact Disc (CD) standard. Recently, various music discs encoded with copyright protection technologies are marketed by some record companies. Please be aware that among those discs, there are some that do not conform to the CD standard and may not be playable by this product.

Cleaning the cabinet

Clean the cabinet, panel and controls with a soft cloth slightly moistened with mild detergent solution. Do not use any type of abrasive pad, scouring powder or solvent such as thinner, benzene or alcohol.

Specifications

Main unit

Amplifier section

AUDIO POWER SPECIFICATIONS:
(U.S.A. model only)

POWER OUTPUT AND TOTAL HARMONIC
DISTORTION:

With 6-ohm loads, both channels driven, from 120 -
10,000 Hz; rated 10 watts per channel minimum RMS
power, with no more than 10% total harmonic
distortion from 250 milliwatts to rated output.

North American model:

Continuous RMS power output (reference):

10 + 10 W

(6 ohms at 1 kHz, 10%
THD)

European and Australian models:

DIN power output (rated): 8 + 8 W

(6 ohms at 1 kHz, DIN)

Continuous RMS power output (reference):

10 + 10 W

(6 ohms at 1 kHz, 10%
THD)

Music power output (reference):

20 + 20 W

Other models:

The following measured at AC 220 V, 50/60 Hz

DIN power output (rated): 8 + 8 W

(6 ohms at 1 kHz, DIN)

Continuous RMS power output (reference):

10 + 10 W

(6 ohms at 1 kHz, 10%
THD)

The following measured at AC 240 V, 50/60 Hz

DIN power output (rated): 8 + 8 W

(6 ohms at 1 kHz, DIN)

Continuous RMS power output (reference):

10 + 10 W

(6 ohms at 1 kHz, 10%
THD)

Inputs
 PC/MD/TAPE IN (stereo minijack):
 Voltage 1.3 V (MD)/820 mV (PC/TAPE),
 impedance 47 kilohms

Outputs
 PC/MD/TAPE OUT (stereo minijack):
 Sensitivity 250 mV,
 impedance 1 kilohm

PHONES (stereo minijack):
 Accepts headphones with
 an impedance of 8 ohms or
 more

SPEAKER:
 Use the supplied speakers

CD player section

System Compact disc and digital audio system

Laser Semiconductor laser
 ($\lambda=780$ nm)
 Emission duration:
 continuous

Frequency response 2 Hz – 20 kHz

Tuner section

FM stereo, FM/AM superheterodyne tuner

FM tuner section

Tuning range

North American model: 87.5 – 108.0 MHz (100-kHz step)

Other models: 87.5 – 108.0 MHz (50-kHz step)

Antenna FM lead antenna

Antenna terminals 75 ohms unbalanced

Intermediate frequency 10.7 MHz

AM tuner section

Tuning range

Pan-American model: 530 – 1,710 kHz
 (with the tuning interval set at 10 kHz)
 531 – 1,710 kHz
 (with the tuning interval set at 9 kHz)

European model: 531 – 1,602 kHz
 (with the tuning interval set at 9 kHz)

Other models: 530 – 1,710 kHz
 (with the tuning interval set at 10 kHz)
 531 – 1,602 kHz
 (with the tuning interval set at 9 kHz)

Antenna AM loop antenna, external antenna terminal

Intermediate frequency 450 kHz

Speaker

Speaker system 2 way, bass-reflex type

Speaker units

Woofer: 10 cm dia., cone type

Tweeter: 2.5 cm dia., balanced dome type

Nominal impedance 6 ohms

Dimensions (w/h/d) Approx. 140 × 275 × 235 mm

Mass Approx. 1.3 kg net per speaker

General

Power requirements

North American model: 120 V AC, 60 Hz

European model: 230 V AC, 50/60 Hz

Australian model: 230 V AC, 50/60 Hz

Mexican model: 120 V AC, 60 Hz

Korean model: 220 V AC, 60 Hz

Taiwanese model: 120 V AC, 50/60 Hz

Hong Kong model: 220 V AC, 50/60 Hz

Other models: 230 V AC, 50/60 Hz

Power consumption

North American and Mexican models: 40 watts

European model: 40 watts
 0.35 watts (in the standby mode)

Korean model: See the name plate

Other models: 40 watts

Dimensions (w/h/d) Approx. 190 × 120 × 235 mm incl. projecting parts and controls

Mass Approx. 3.5 kg

Supplied accessories Remote (1)
 R6 (size AA) batteries (2)
 AM loop antenna (1)
 FM lead antenna (1)

Design and specifications are subject to change without notice.

List of button locations and reference pages

How to use this page

Use this page to find the location of buttons and other parts of the system that are mentioned in the text.

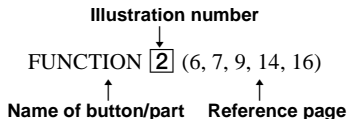

Main unit

ALPHABETICAL ORDER

A - F

DIMMER **1** (13)

Display window **8**

FUNCTION **2** (6, 7, 9, 14, 16)

R - Z

Remote sensor **10**

TUNING +/- **4** (8, 10)

VOLUME +/- **3** (11)

BUTTON DESCRIPTIONS

I/⏻ (power) **9** (4, 5, 9, 11, 14, 16)

⏮/⏭ (go back/go forward) **4** (5, 7, 9, 11)

■ (stop) **5** (7, 9, 14, 16)

▶|| (play/pause) **6** (6, 7)

▲ (open/close) **7** (6, 7)

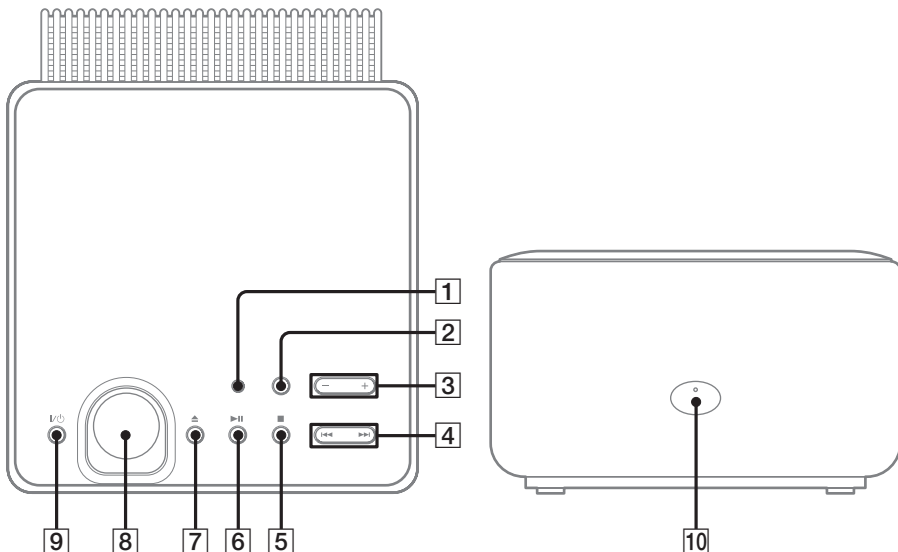

Remote control

ALPHABETICAL ORDER

A - E

- BALANCE **10** (10)
- BASS **6** (10)
- CENTER **7** (10)
- CLEAR **26** (8)
- CLOCK/TIMER SELECT **27** (12)
- CLOCK/TIMER SET **15** (5, 11)
- DISPLAY **13** (12, 13)
- DSG **8** (10)
- ENTER **16** (5, 7, 9, 11)
- EQ + **5** (10)
- EQ - **9** (10)

F - Z

- FM MODE **18** (10)
- FUNCTION **22** (6, 7, 9, 14, 16)
- PLAY MODE **23** (6, 7)
- REPEAT **18** (7)
- SLEEP **14** (11)
- TREBLE **4** (10)
- TUNER BAND **11** (8, 10)
- TUNER MEMORY **19** (8)
- TUNING MODE **23** (8, 10)
- TUNING +/- **3** (8, 10)
- VOL + **20** (11)
- VOL - **21** (11)

BUTTON DESCRIPTIONS

- I/⏻ (power) **1** (4, 5, 9, 11, 16)
- ◀▶ (fast forward/rewind) **2** (5, 7)
- ◀◀/▶▶ (go back/go forward) **3** (5, 7, 9, 11)
- (stop) **17** (7, 9, 16)
- ⏸ (pause) **25** (7)
- CD ▶ (play) **24** (6, 7)
- OPEN/CLOSE ▲ (open/close) **12** (6, 7)

