

WARNING

To reduce the risk of fire or electric shock, do not expose this apparatus to rain or moisture.

To reduce the risk of electrical shock, do not open the cabinet. Refer servicing to qualified personnel only.

You are cautioned that any changes or modifications not expressly approved in this manual could void your authority to operate this equipment.

The validity of the CE marking is restricted to only those countries where it is legally enforced, mainly in the countries EEA (European Economic Area).

Features

- Noise canceling headphones reduce unwanted ambient noise, providing a quieter environment to enhance your listening experience. A microphone inside each earpiece works with an electronic circuit to create an opposite sound wave to cancel out the noise
- Noise canceling headphones reduce approx. 90% of ambient noise by the electronic circuit (under the Sony measurement standard)
- Closed type vertical in-the-ear headphones for wearing comfort and secure fitting
- Hybrid silicone earbuds for secure fitting and long-term wearing comfort
- Built-in monitor function lets you minimize the audio to listen to outside
- Long battery life-approximately 100 hours with AAA battery
- Dual-use capability allows option to listen to music with or without noise cancellation
- Supplied plug adaptor for easy connectivity to stereo or dual jack for in-flight music services

Installing a battery

- Push and slide the battery lid on the rear of the control box fully, and open. Before opening the battery lid, check that the claws of the lid are seen.

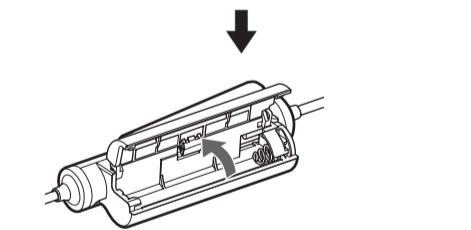
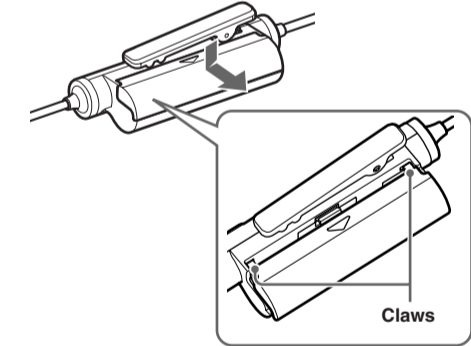

- Insert one R03 (size AAA) battery in the battery compartment. Observe the correct polarity when installing battery.

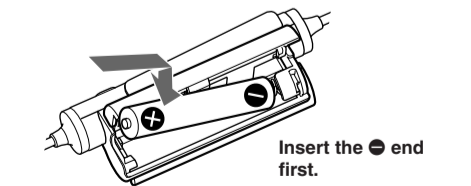

- Align the battery lid with the control box correctly, then slide to close the battery lid.

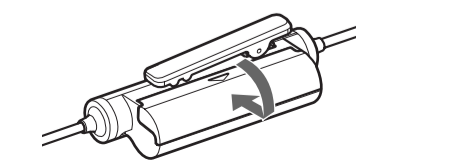

Battery	Approx. hours* ¹
Sony alkaline battery LR03 SIZE AAA	100 hours* ²
Sony manganese battery R03 SIZE AAA	50 hours* ²

*¹ 1 kHz, 0.1 mW + 0.1 mW output
*² Time stated above may vary, depending on the temperature or conditions of use.

Note

The supplied battery was included in the package during manufacturing (as a convenience to the user), it is possible that the battery life may be depleted by the time of purchase. The actual life of the supplied battery may be shorter than the standard time described in this manual when using a fresh battery.

When to replace the battery

Replace the battery with a new one when the POWER indicator flashes or lights off.

Note

The noise canceling feature may not work correctly if battery power is low.

Installing the earbuds

If the earbuds do not fit your ears correctly, the noise canceling effect will not be optimal. To optimize noise canceling and to enjoy better sound quality, change the earbuds to another size, or adjust the earbuds position to fit your ears comfortably and snugly. The M size earbuds are attached to the headphones before shipment. If you feel the M size earbuds do not suit your ears, replace them with the supplied S or L size earbuds. Confirm the size of the earbuds by checking color inside. When you change the earbuds, turn to install them firmly on the headphones to prevent the earbud from detaching and remaining in your ear.

Earbud sizes (inside color)

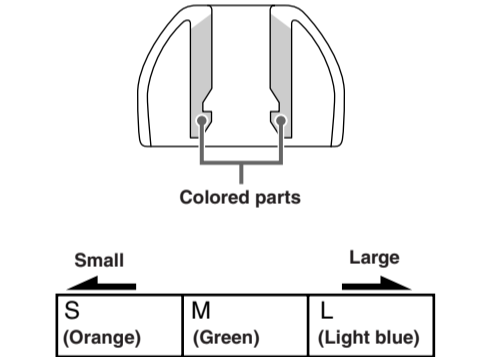

To detach an earbud

While holding the headphone, twist and pull the earbud off.

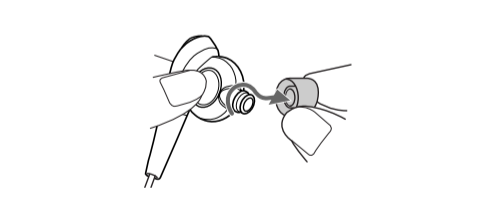

Tip

If the earbud slips and cannot be detached, wrap it in a dry soft cloth.

To attach an earbud

Twist and push the inside parts of the earbud into the headphone until the projecting part of the headphone is fully covered.

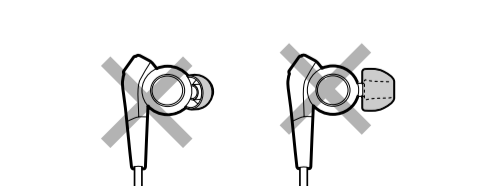
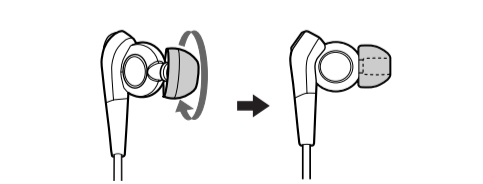

Listening to the music

- Connect the headphones to the AV equipment.

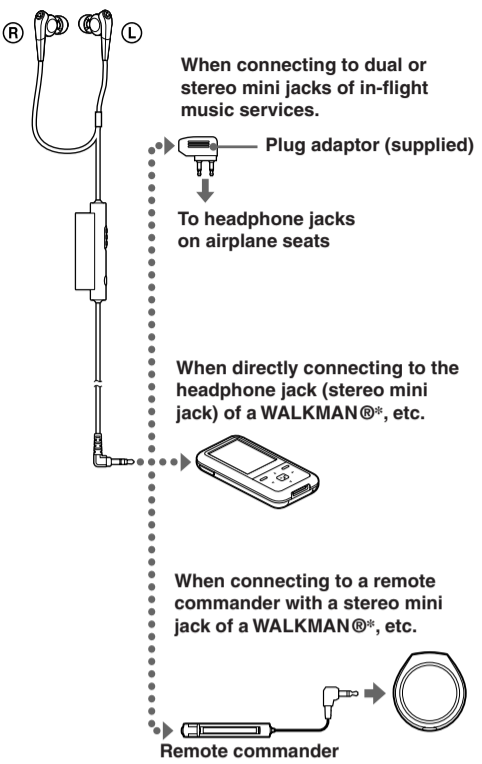

* “WALKMAN” and “WALKMAN” logo are registered trademarks of Sony Corporation.

- Wear the headphones marked **R** in your right ear and the one marked **L** in your left ear. Push the earbud into your ear carefully so that the earbud fits the hole of your ear snugly.

Note

Be sure the earbuds fit your ears correctly, otherwise noise canceling will not function properly. Adjust the earbuds position to sit on your ear comfortably so that they fit your ears snugly. You may hear a rubbing sound when you wear the headphones. This is not a malfunction.

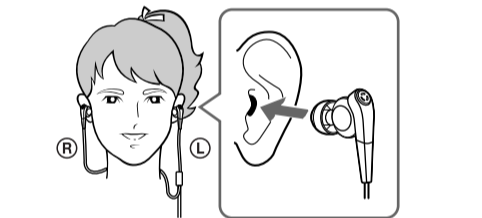

- Turn on the power of the headphones. The POWER indicator lights in red. When power is turned on, ambient noise is reduced, and you can listen to music more clearly at a lower volume.

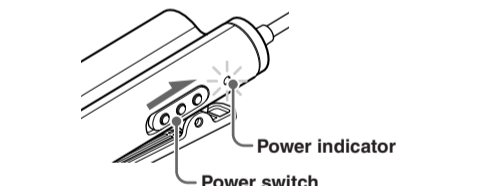

- Turn on the power of the AV equipment.

To hear ambient sound for safety

Hold down the MONITOR button when the power is turned on. The audio is minimized and you can hear the surrounding environment. Release the MONITOR button to enjoy the noise canceling function again.

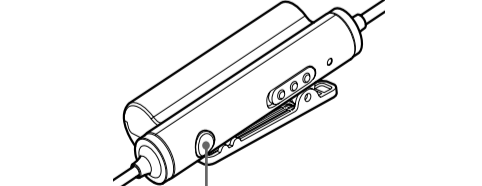

Notes on using on the airplane

- The supplied plug adaptor can be connected to the dual or stereo mini jacks of in-flight music services.

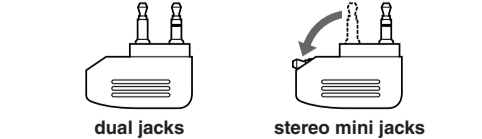

- Do not use the headphones when use of electronic equipment is prohibited or when use of personal headphones for in-flight music services is prohibited.

If you have any questions or problems concerning the system that are not covered in this manual, please consult the nearest Sony dealer.

After listening to the music

Turn off the power of the headphones.

Notes

- The noise canceling function is only effective for noise in the low frequency band. Although noise is reduced, it is not canceled completely.
- Do not cover the microphone of the headphones with your hands. The noise canceling function may not work properly.

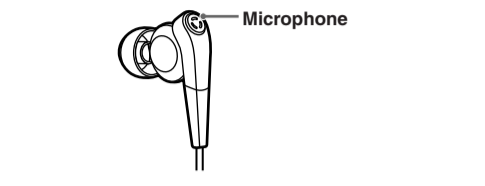

- The noise canceling function may not work properly unless the headphones are put on firmly.
- You can use the headphones even without turning on the power. In this case, the noise canceling function is not active, and the headphones operate as passive headphones.
- After you turn on the power of the headphones, you may hear a slight hiss. This is the operating sound of the noise canceling function, not a malfunction.
- In a quiet place, or depending on certain noises, you may feel that the noise canceling function is not effective, or that noise is accentuated. In this case, turn off the power of the headphones.
- Interference noise can occur from nearby cellular phones. Should this occur, locate the headphones further away from the cellular phone(s).

Using the clip

You can fasten the control box by its clip on a shirt pocket.

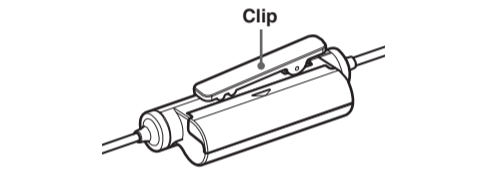

Using the supplied cord adjuster

You can adjust the cord length by winding the cord on the cord adjuster. (The cord can be wound to the cord adjuster up to 40 cm. If you wind more, the cord comes off from the cord adjuster easily.)

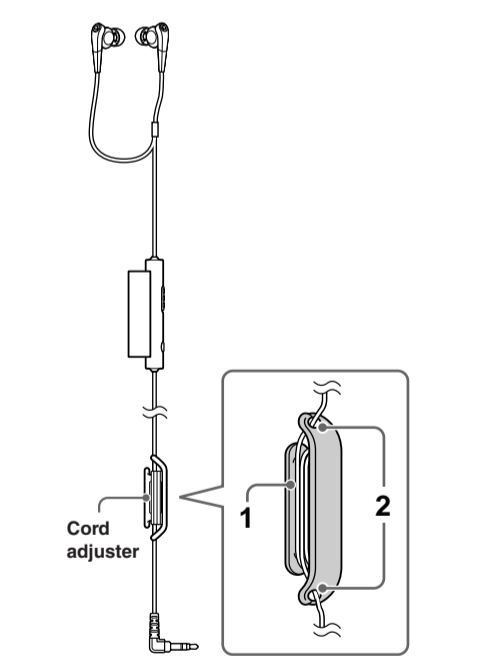

- Wind the cord.
- Push cord into slot hole to secure in place.

When carrying the headphones

The headphones and the control box can also be separately stored in the partitioned carrying pouch (supplied).

Precautions

- Clean the headphones with a soft dry cloth.
- Do not leave the jack plug dirty otherwise the sound may be distorted.
- Be sure to bring the headphones to the Sony dealer when requiring a change of earbuds or repair work.
- Do not leave the headphones in a location subject to direct sunlight, heat or moisture.
- Do not subject the headphones to excessive shock.
- Handle the driver units carefully.
- To clean the earbuds, first remove them from the headphones, and then clean them with water and mild detergent. After cleaning, dry each earbud carefully before use.
- The earbuds will need to be replaced from time to time. If they are worn out by daily use or longtime storage, replace them with new ones.
- If you fell drowsy or sick while using these headphones, stop use immediately.
- Install the earbuds firmly onto the headphones. If an earbud accidentally detaches and is left in your ear, it may cause injury.

Notes on headphones Preventing hearing damage

Avoid using headphones at high volume. Hearing experts advise against continuous, loud and extended play. If you experience a ringing in your ears, reduce the volume or discontinue use.

Do not use headphones while driving and cycling, etc.

As headphones reduce outside sounds, they may cause a traffic accident. Also, avoid listening with your headphones in situations where hearing must not be impaired, for example, a railroad crossing, a construction site, etc.

Note on static electricity

In particularly dry air conditions, mild tingling may be felt on your ears. This is a result of static electricity accumulated in the body, and not a malfunction of the headphones.

The effect can be minimized by wearing clothes made from natural materials.

Troubleshooting

No sound

- Check the connection of the headphones and the AV equipment.
- Check that the connected AV equipment is turned on.
- Turn up the volume of the connected AV equipment.

Power does not turn on

- Check if the battery has expired (the POWER indicator lights off). Replace the battery with a new one.

Specifications

General	
Type	Dynamic, closed
Driver units	13.5 mm, dome type (CCAW adopted)
Power handling capacity	50 mW
Impedance	16 Ω at 1 kHz (when the power is on) 16 Ω at 1 kHz (when the power is off)
Sensitivity	98 dB/mW (when the power is on) 99 dB/mW (when the power is off)
Frequency response	10 – 22,000 Hz
Total Noise Suppression Ratio ^{*1}	Approx. 10 dB ^{*2}
Cord	Approx. 1.5 m (59 1/8 in) OFC Litz cord, neck-chain (including control box)
Plug	Gold-plated L type stereo mini plug
Power source	DC 1.5 V, 1 × R03 (size AAA) battery
Mass	Approx. 7 g (0.3 oz) headphones (not including cord) Approx.19 g (0.7 oz) control box (including battery, not including cord)

Supplied accessories

Sony R03 (size AAA) battery (1)
Earbuds (S × 2, M × 2, L × 2)
Carrying pouch (1)
Plug adaptor for in-flight use*³ (single/dual) (1)
Cord adjuster (1)
Operating Instructions (1)
Warranty card (1)

*¹ Under the Sony measurement standard.

*² Equivalent to approx. 90% reduction of energy of sound compared with not wearing headphones.

*³ May not be compatible with some in-flight music services.

Design and specifications are subject to change without notice.