

Precautions

- Do not tamper with the four holes on the upper surface of the unit. They are used for tuner adjustments to be made only by service technicians.
- There must be a distance of at least 15 cm between the cassette slot of the unit and shift lever to insert cassettes easily. Choose the installation location carefully so the unit will not interfere with driving.
- Choose the mounting location carefully so the unit will not interfere with driving.
- Avoid installing the unit where it would be subject to high temperatures, such as from direct sunlight or hot air from the heater, or where it would be subject to dust, dirt or excessive vibration.
- Use only the supplied mounting hardware for safe and secure installation.

Mounting angle adjustment

Adjust the mounting angle to less than 20°.

How to Detach and Attach the Front Panel

Before installing the unit, detach the front panel.

To detach

Press **RELEASE** to detach the front panel then gently pull it out.

To attach

Align parts **A** and **B**, and push the front panel in until it clicks.

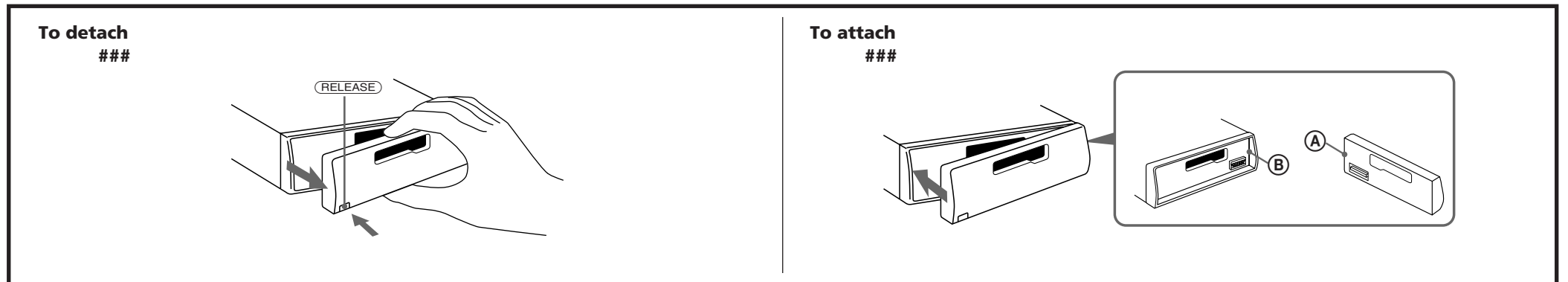

Mounting Example

Installation in the dashboard

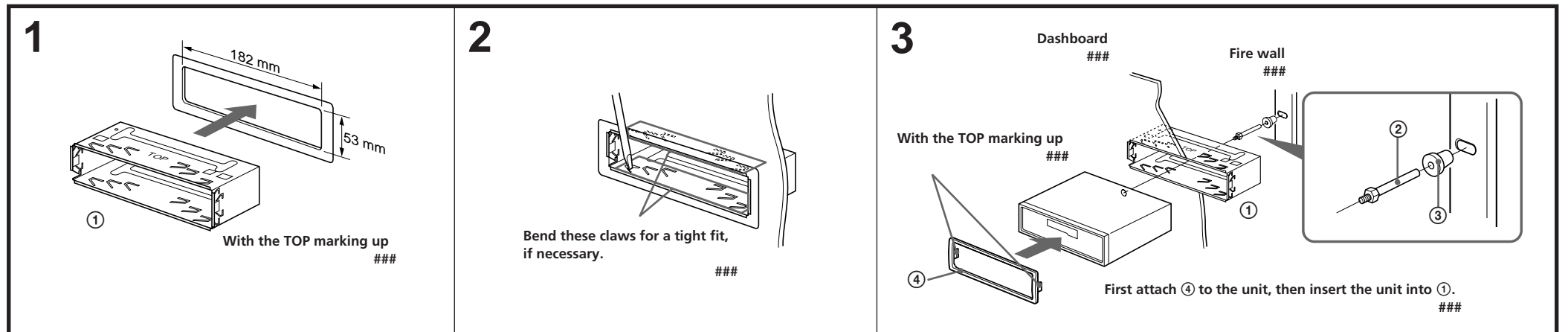

Mounting the Unit in a Japanese Car

You may not be able to install this unit in some makes of Japanese cars. In such a case, consult your Sony dealer.

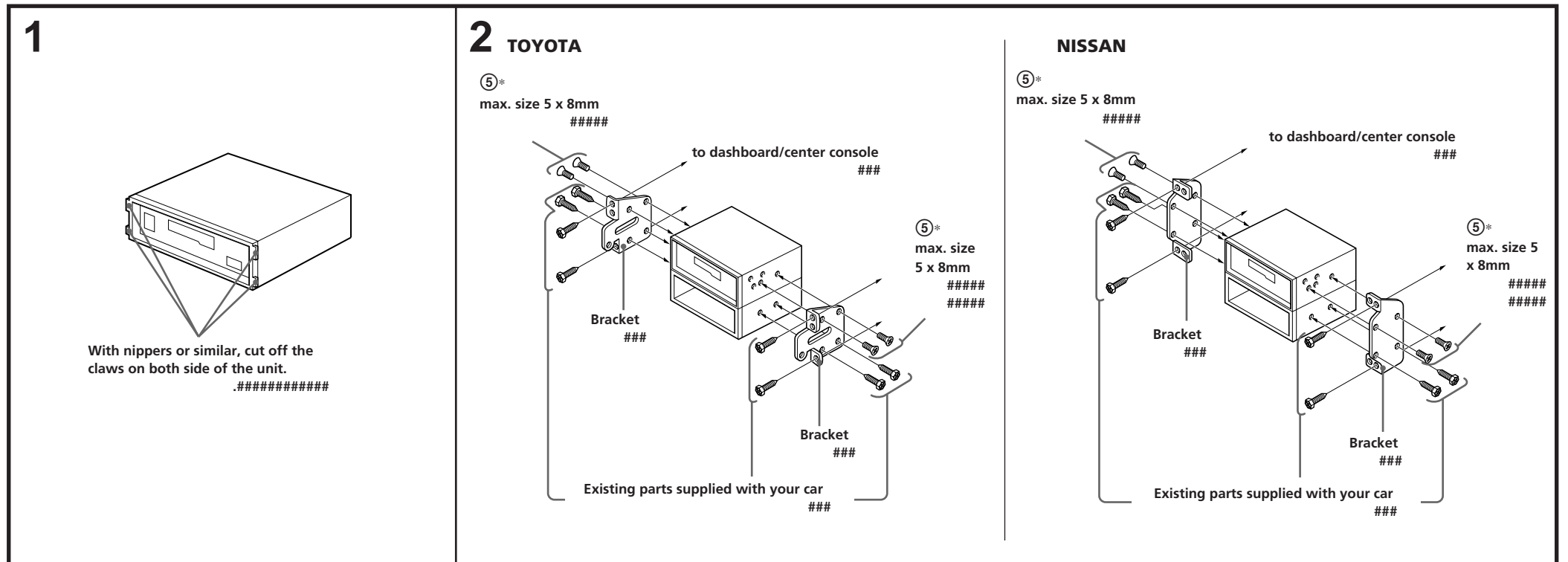

Note
To prevent malfunction, install only with the supplied screws ⑤.

#####

Installing the rotary commander

Notes

- Choose the mounting location carefully so the rotary commander will not interfere with operating the car.
- Do not install the rotary commander in a place where it may jeopardize the safety of the (front) passenger in any way.
- When installing the rotary commander, be sure not to damage any electrical cables etc. on the other side of the mounting surface.
- Avoid installing the rotary commander where it may be subject to high temperatures, such as from direct sunlight or hot air from the heater etc.

###

• ###

Example of a mounting location

###

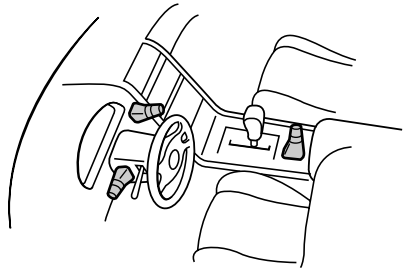

1 Choose the exact location for mounting the rotary commander, then clean the mounting surface.

Dirt and oil impair the adhesive strength of the double-sided adhesive tape.



2 Mark the position for the supplied screw.

Use the screw holes on the mounting hardware ⑨ to mark the position.

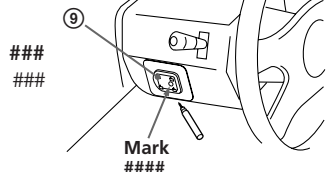

3 Remove the steering wheel column cover, and drill 2 mm diameter hole at the marked position.

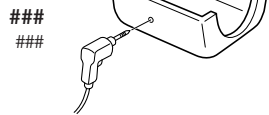

4 Warm the mounting surface and the double-sided adhesive tape on the mounting hardware ⑨ to a temperature of 20°C to 30°C, and attach the mounting hardware to the mounting surface applying even pressure. Use the supplied screw ⑧ to set into secure position.

Attach a piece of heavy duty tape etc. on the other side of the mounting surface to cover the protruding tips of the screws so they will not interfere with any electrical cables etc. inside the steering wheel column.

###

Cut the mounting hardware ⑨, if necessary.

####

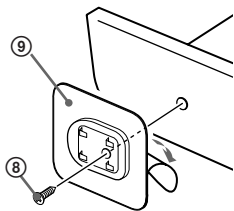

Heavy duty tape etc.
###

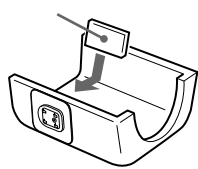

5 After reinstalling the steering wheel column cover, attach the rotary commander to the mounting hardware by aligning the four holes on the bottom of the rotary commander with the four catches on the mounting hardware and sliding the rotary commander until it locks into place as illustrated.

Note

If you are mounting the rotary commander on the steering wheel column, make sure that the protruding tips of the screws on the inner surface of the column do not in any way hinder or interfere with the movement of the rotating shaft, operative parts of the switches or the electrical cables etc. inside the column.

###

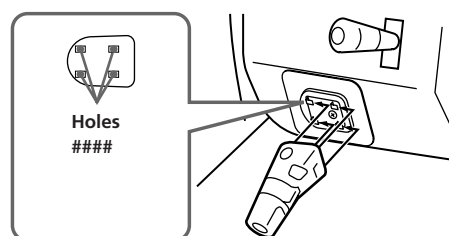

Holes
####

SONY®

FM/MW/SW Cassette Car Stereo

Installation/Connections

###

XR-7850

Sony Corporation © 1998 Printed in Japan

Parts for Installation and Connections

The numbers in the list are keyed to those in the instructions.

###

###

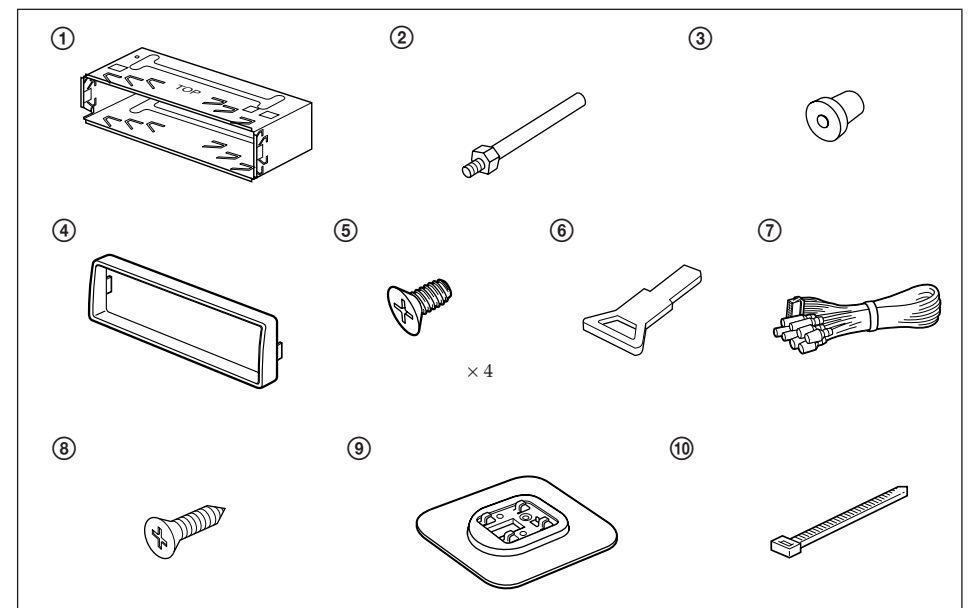

The release key ⑥ is used for dismounting the unit. See the Operating Instructions manual for details.
.#####

Caution

- Cautionary notice for handling the bracket 1.
Handle the bracket carefully to avoid injuring your fingers.

#####

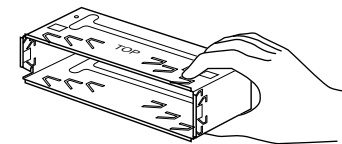

- Remove the protection collar 4 before installing

###

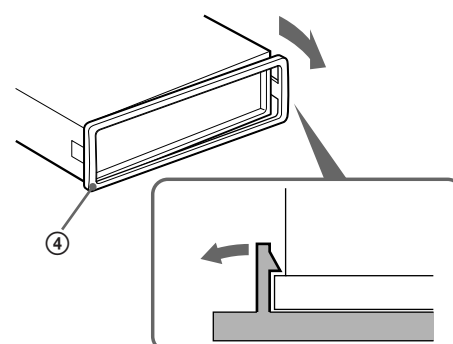

Release the catch lock as illustrated.
.#####



Caution

- This unit is designed for negative ground 12 V DC operation only.
- Before making connections, disconnect the ground terminal of the car battery to avoid short circuits.
- Connect the **yellow** and **red** power input leads only after all other leads have been connected.
- Be sure to connect the red power input lead to the positive 12 V power terminal which is energized when the ignition key switch is in the accessory position.
- **Run all ground wires to a common ground point.**
- Connect the yellow cord to a free car circuit rated higher than unit's fuse rating.
If you connect this unit in combination with other stereo components, the car circuit they are connected to must be rated higher than the sum of the individual components' fuse rating.
If there are no car circuits rated as high as the unit's fuse rating, connect the unit directly to the battery.
If no car circuits are available for connecting this unit, connect the unit to a car circuit rated higher than the unit's fuse rating in such a way that if the unit blows its fuse, no other circuits will be cut off.

###

- ### •
- ### •
- ### •
- ### •
- ### •
- ### •

If Your Car has No Accessory Position on the Ignition Key Switch — POWER SELECT Switch

The illumination on the front panel is factory set to be turned on even while the unit is not in use. However, this setting may cause some car battery wear **if your car has no accessory position on the ignition key switch**. To avoid this battery wear, **set the POWER SELECT switch located on the bottom of the unit to the **ⓐ** position, then press the reset button**. The illumination is reset to stay off while the unit is not in use.

Note
The caution alarm for the front panel is not activated when the POWER SELECT switch is set to the **ⓐ** position.

##

—

###

###

###

###

Frequency select switch

The MW (FM) tuning interval is factory-set to the 9K (50 K) position.
If the frequency allocation system of your country is based on 10 kHz (200 kHz) interval, set the switch on the bottom of the unit the 10 K (200 K) position before making connections.

####

#####

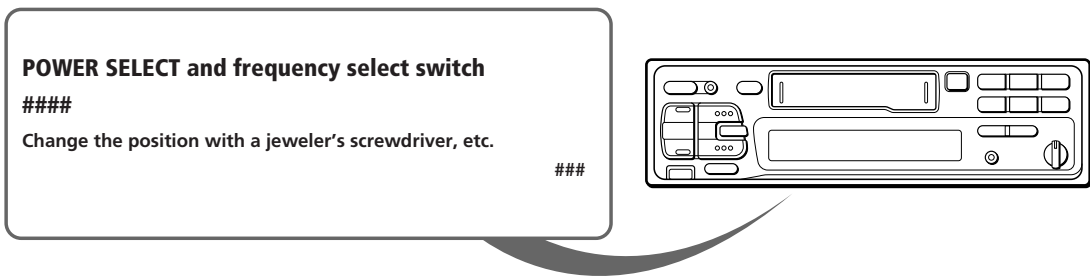

When you change the position of the switch, be sure to press the reset button after the connections are complete.

#####

Reset Button

When the installation and connections are complete, be sure to press the reset button with a ball-point pen etc.

###

###

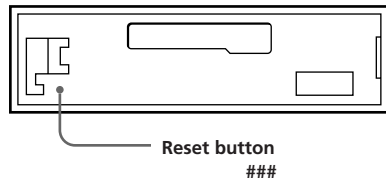

Connection Diagram

###

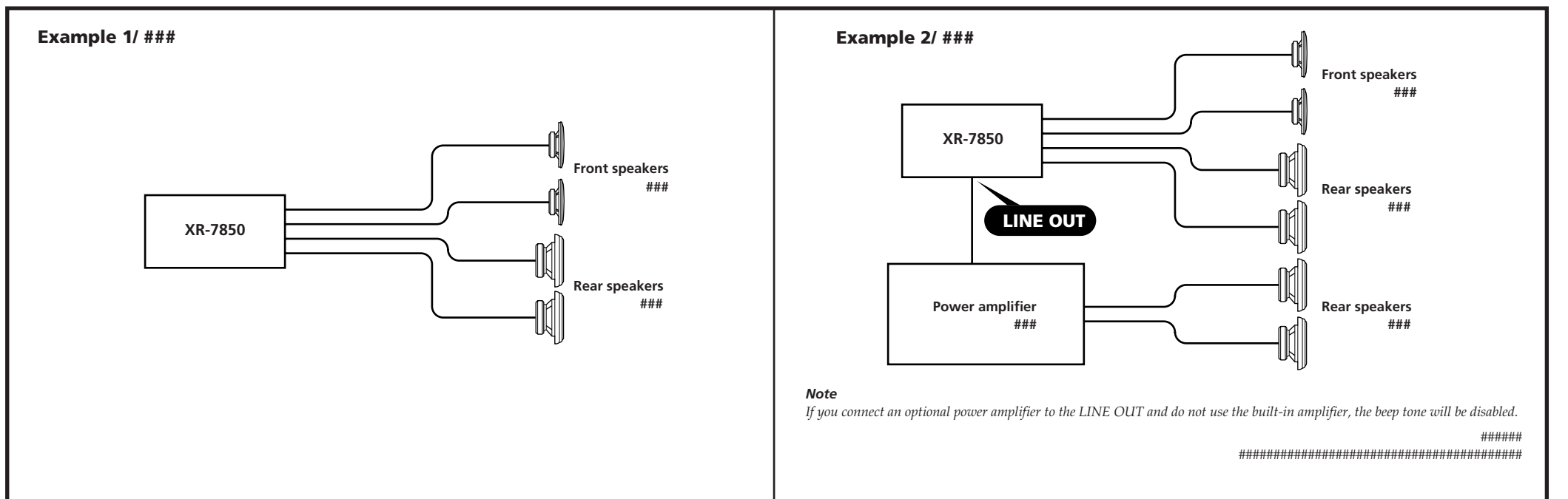

#####

#####

Connection example

###

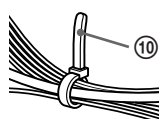
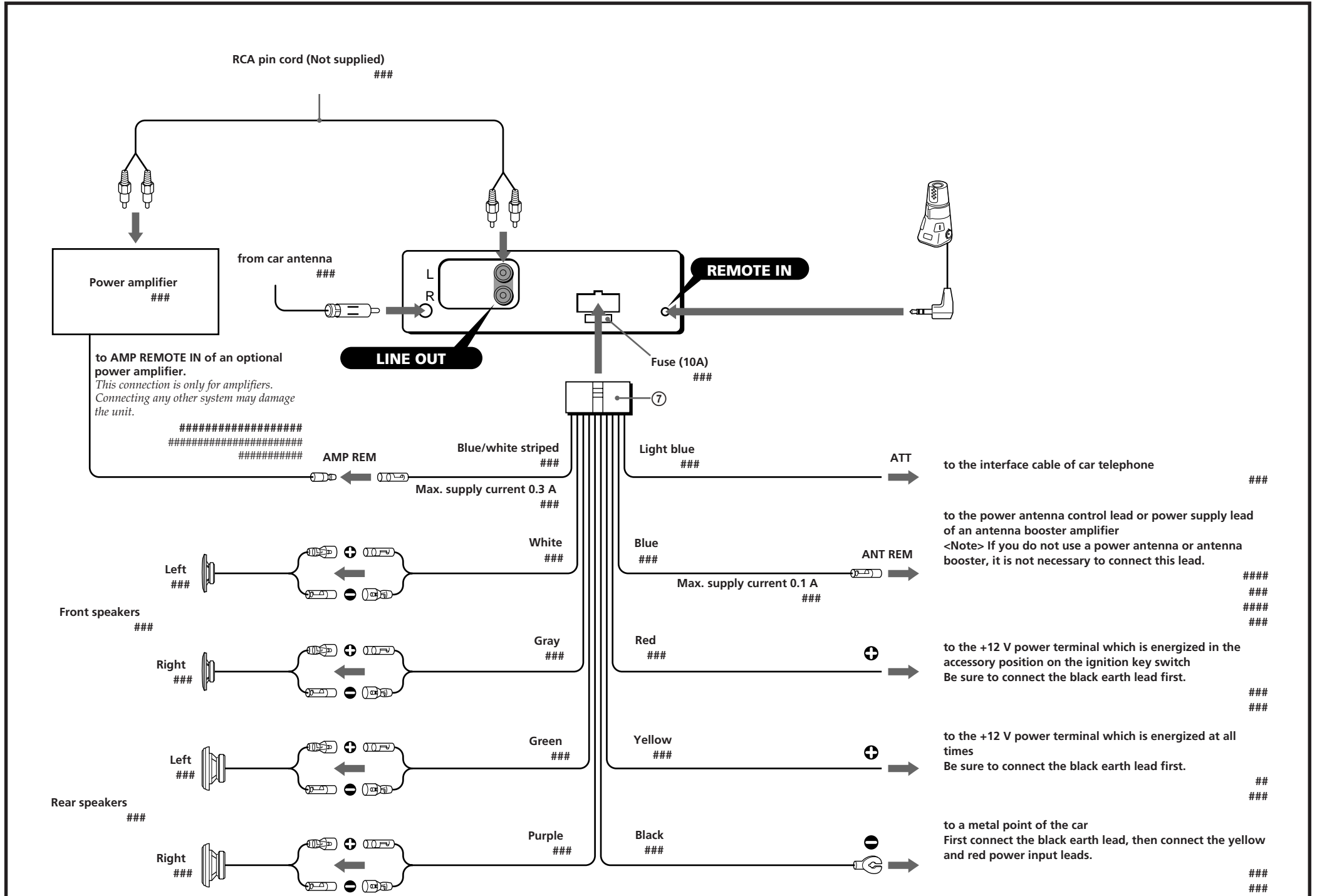

After connecting, bundle up the connecting cord of the rotary commander with other connecting cords of the audio equipment by attaching the supplied crammer ⑩. Be sure to leave some slack in the connecting cord between the plug and the crammer.

####.

Notes on the control leads

- The power antenna control lead (blue) supplies +12 V DC when you turn on the tuner or when you activate the ATA (Automatic Tuner Activation) function.
- A power antenna without a relay box cannot be used with this unit.

###

Memory hold connection

When the yellow power input lead is connected, power will always be supplied to the memory circuit even when the ignition key is turned off.

###

Notes on speaker connection

- Before connecting the speakers, turn the unit off.
- Use speakers with an impedance of 4 to 8 ohms, and with adequate power handling capacities. Otherwise, the speakers may be damaged.
- Do not connect the terminals of the speaker system to the car chassis, and do not connect the terminals of the right speaker with those of the left speaker.
- Do not attempt to connect the speakers in parallel.
- Do not connect any active speakers (with built-in amplifiers) to the speaker terminals of the unit. Doing so may damage the active speakers. Therefore, be sure to connect passive speakers to these terminals.

###