

# ***Trinitron<sup>®</sup> Color TV***

---

Operating Instructions

***KV-T21TF2***

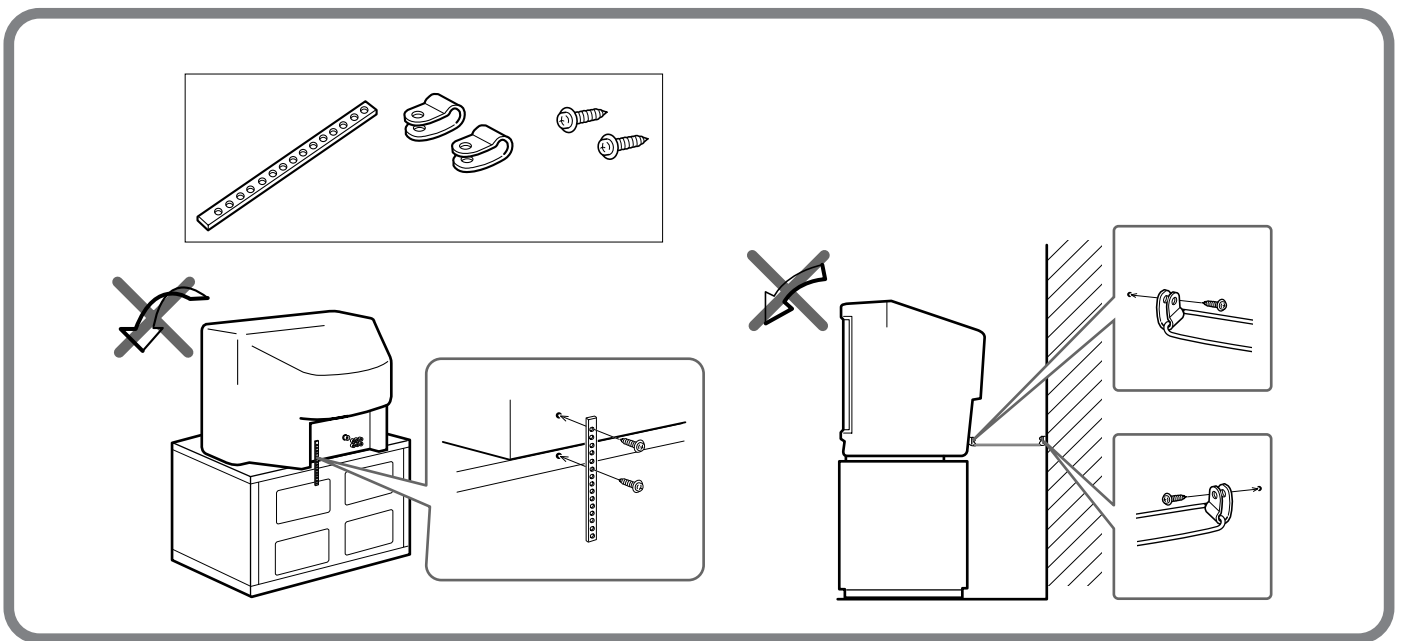
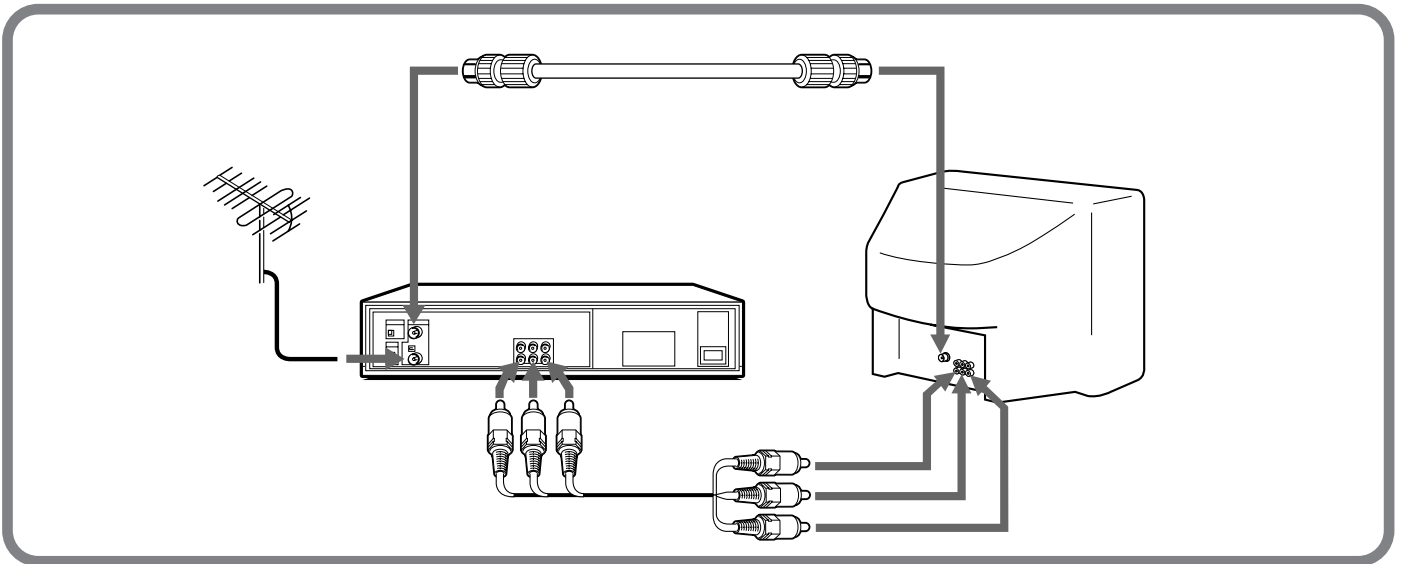
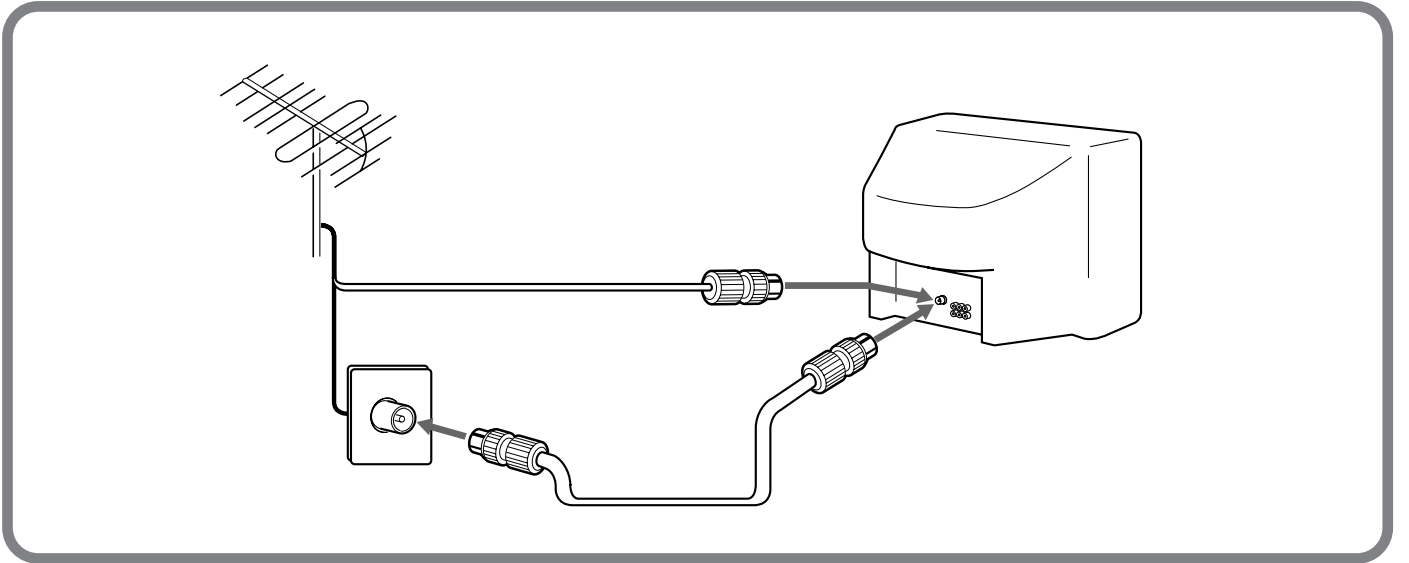

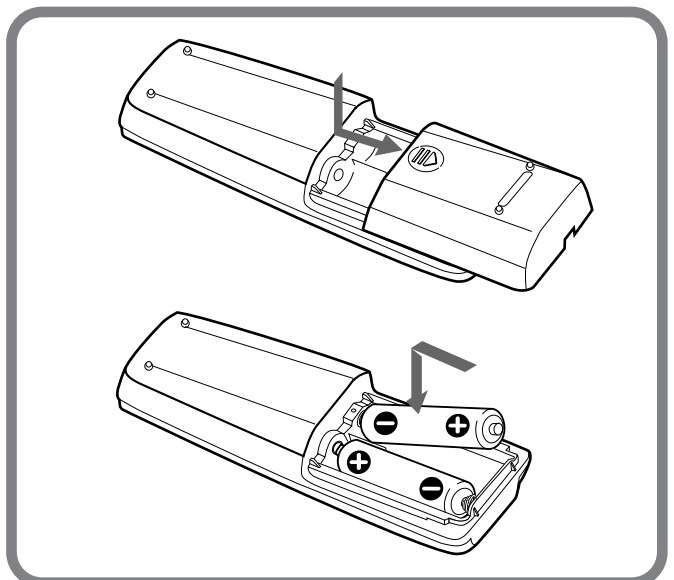
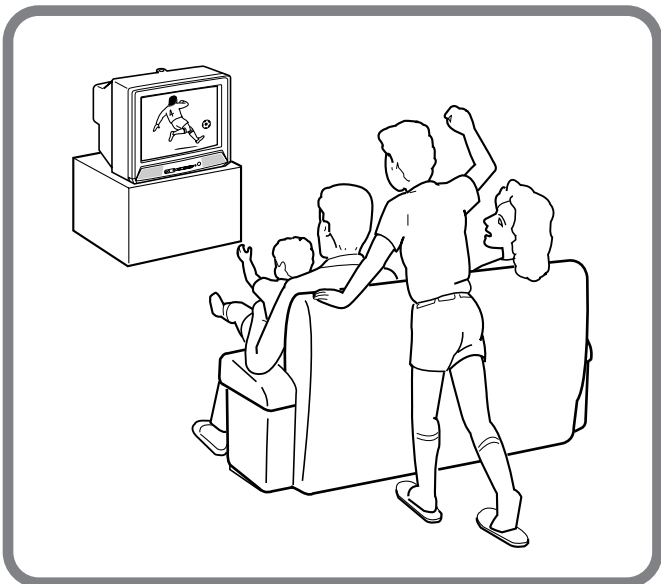
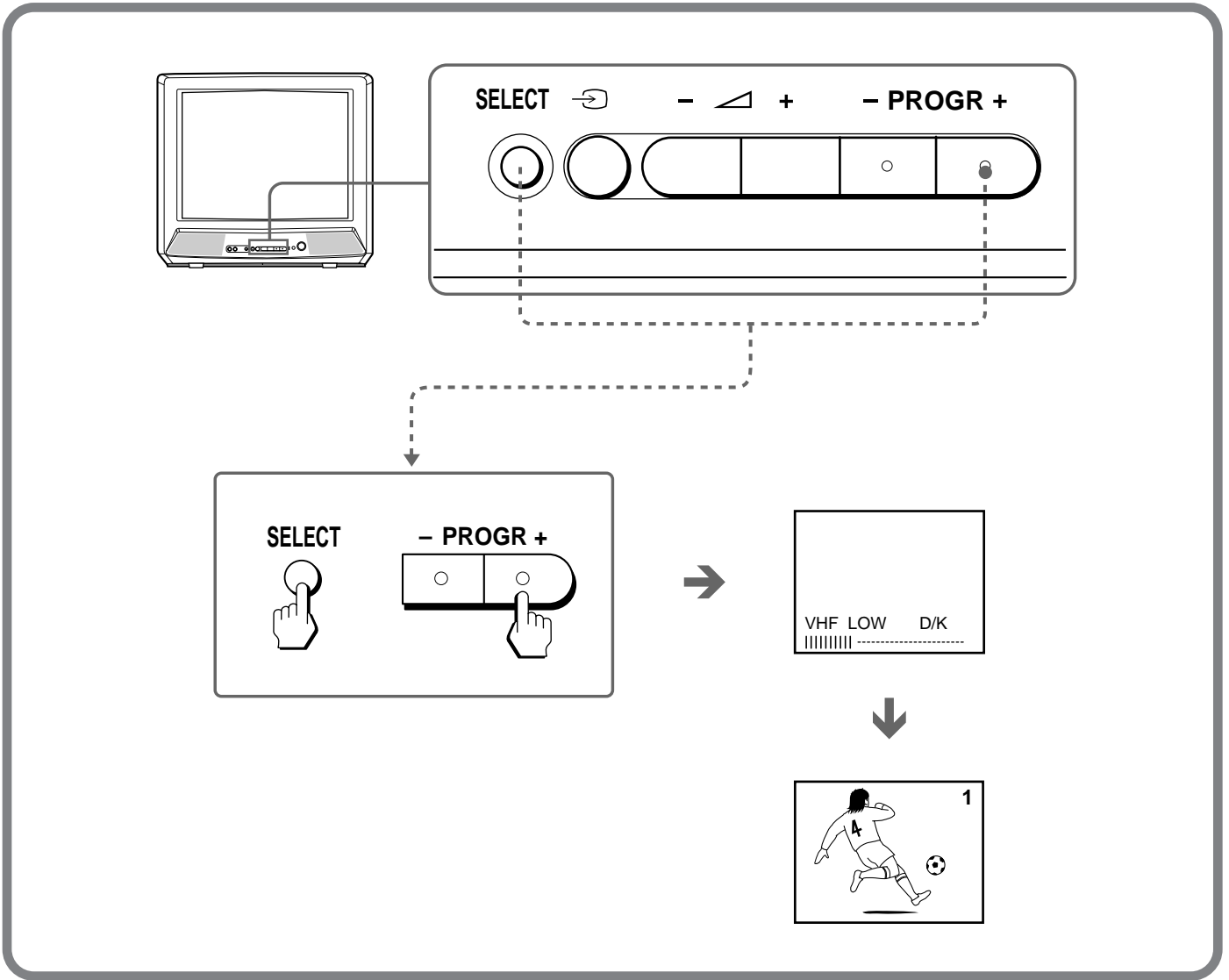

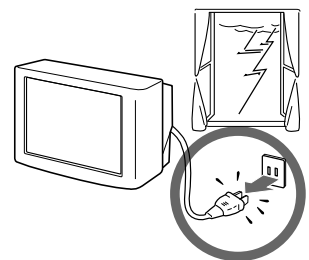
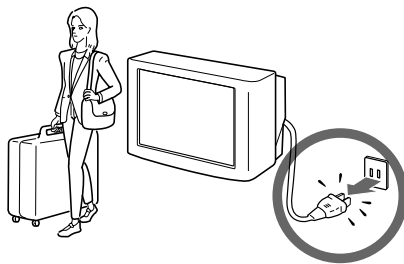
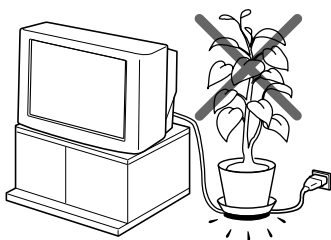
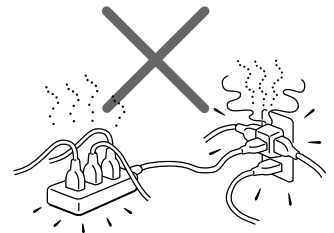
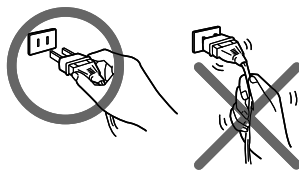
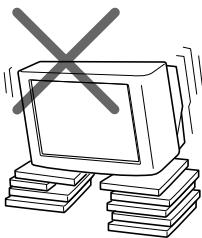
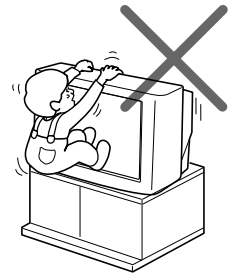
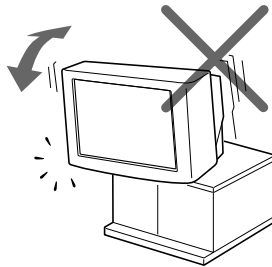
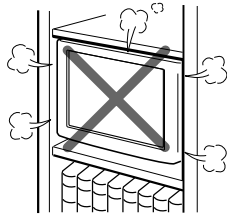
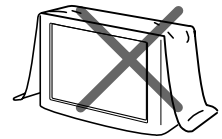
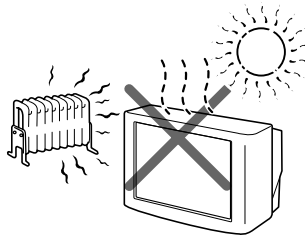
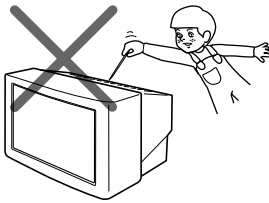
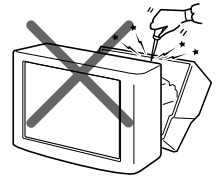
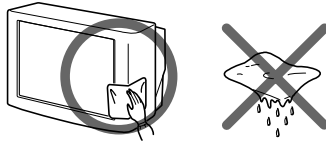
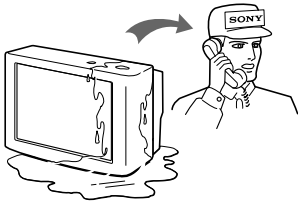
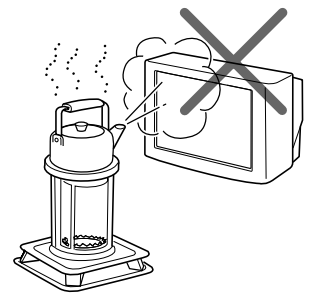
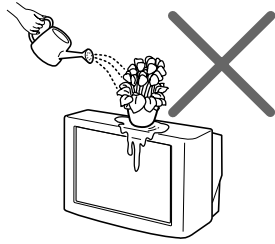
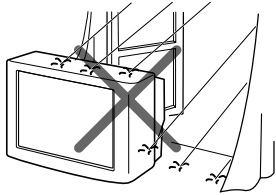



# WARNING

- Dangerously high voltages are present inside the TV.
- Operate the TV only at 110-240 V AC.
- Do not open the cabinet and the rear cover of the TV. Refer servicing to qualified personnel.
- To prevent fire or shock hazard, do not expose the TV to rain or moisture.
- Do not operate the TV if any liquid or solid object falls into it. Have it checked immediately by qualified personnel only.
- Do not block the ventilation openings.
- Do not install the appliance in a confined space, such as a bookcase or built-in cabinet.
- Do not install the TV in hot, humid or excessively dusty places.
- Do not install the TV where it may be exposed to mechanical vibrations.
- Do not keep the TV plugged in if you are not going to use it for several days.
- Do not pull the power cord to disconnect the TV. Pull it out by the plug.
- Use only the supplied screws (as shown on page 2) to fasten the TV to the TV stand or to stabilize the TV against a wall or a pillar. Use of other screws may damage the TV.

## Note on the remote commander

- The supplied remote commander is used on several models of the TV. If you do not find instructions for some controls that are on the remote commander, that means your TV does not employ the features of those controls, e.g. .

## Notes

- When you turn on the TV, you may hear the “boon” sound that is caused by the demagnetization of the TV. This does not indicate a malfunction.
- The picture color may become abnormal if you change the direction of your TV. To obtain the normal picture color, press  on the TV to turn off the TV for five minutes and then turn it on again.
- Design and specifications are subject to change without notice.

# Table of contents

---

## Getting Started

- 6 Connections
- 8 Presetting channels

---

## Operations

- 10 Watching the TV
- 12 Adjusting the picture and the sound

---

## Additional Information

- 13 Troubleshooting
- Back cover
  - Specifications

All contents are subject to change without notice.

# Connections

## Connecting a VHF antenna or a combination VHF/UHF antenna — 75-ohm coaxial cable (round)

Attach an optional IEC antenna connector to the 75-ohm coaxial cable.  
Plug the connector into the  $\Gamma$  (antenna) socket at the rear of the TV.

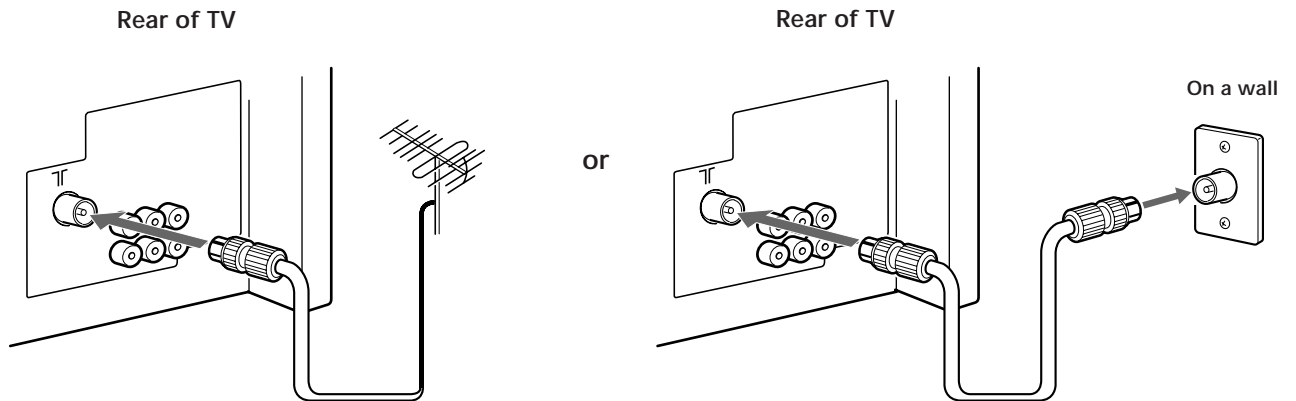

## Connecting optional equipment

You can connect optional audio/video equipment to your TV such as a VCR, multi disc player, camcorder, video game, or stereo system.

### Connecting video equipment using video input jacks

#### Front of TV

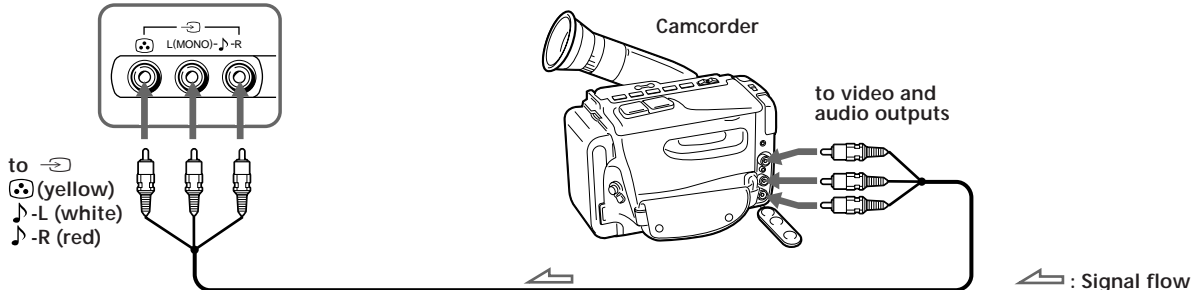

#### Rear of TV

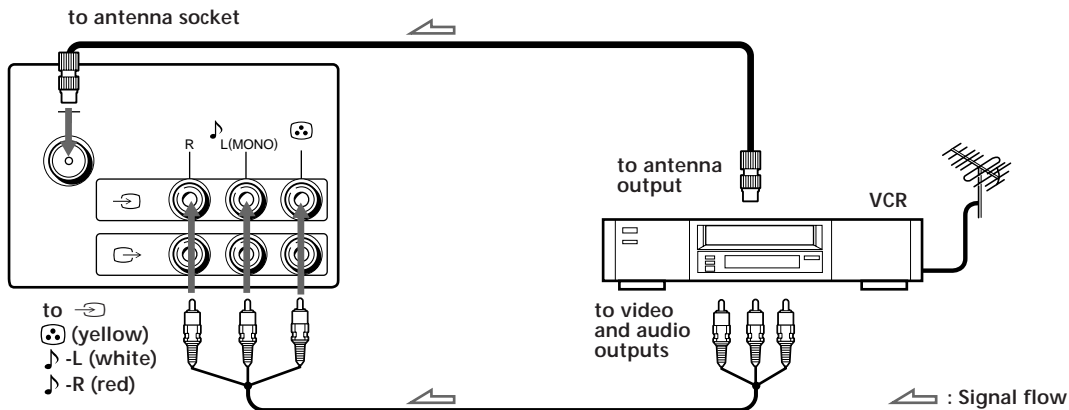

#### When connecting a monaural VCR

Connect the yellow plug to VIDEO IN (VIDEO) and the black plug to AUDIO-L MONO (AUDIO-L MONO).

#### When connecting a VCR to the ANTENNA terminal

Preset the signal output from the VCR to the program position 0.

#### When connecting video equipment to the VIDEO INPUT jacks or the VIDEO IN jacks

Do not connect video equipment to the VIDEO INPUT jacks at the front and the VIDEO IN jacks at the rear of your TV simultaneously; otherwise the picture will not be displayed properly on the screen.

### Connecting audio/video equipment using MONITOR/TV OUT jacks

#### Rear of TV

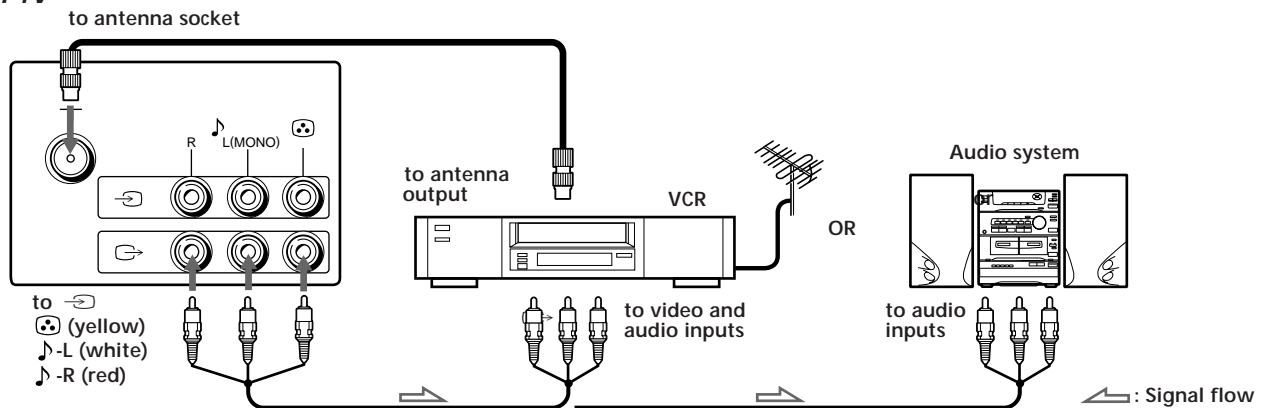

#### When recording through the MONITOR/TV OUT jacks

If you change the channel or video input while recording with a VCR, the channel or video input you are recording will also be changed.

# Presetting channels

You can preset up to 100 TV channels in numerical sequence from program position 1 using the buttons on the remote commander or the TV.

You can preset TV channels quickly, automatically or manually.

## Remote commander

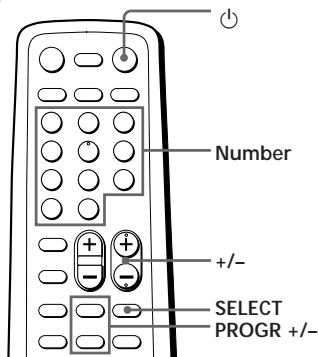

## Front of TV

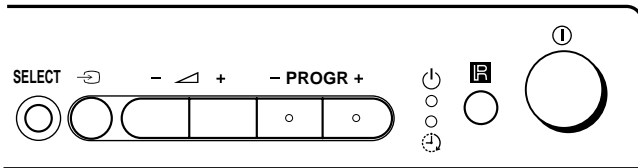

## Quick channel presetting

- 1 Press ① on the TV.



When the TV is turned on in standby mode, press ① on the remote commander.

- 2 Press SELECT and PROGR + on the TV simultaneously for one to two seconds.

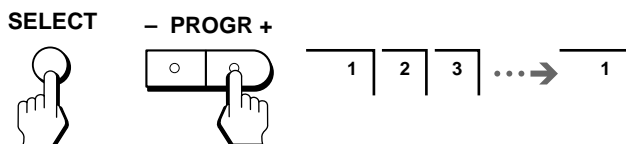

## If the picture color is poor and/or the sound is noisy

Select the appropriate TV system as follows:

- 1 Press SELECT on the remote commander or the TV until TV SYSTEM appears.
- 2 Press +/- on the remote commander or  $\triangle$ +/- on the TV until the picture and sound become normal.

## Notes

- If you do not know your local TV system, consult your nearest authorized service center or dealer.
- The setting of the TV SYSTEM is memorized for each program position.

## Presetting channels manually

- 1 Press SELECT on the remote commander or the TV until TV SYSTEM appears on the screen.

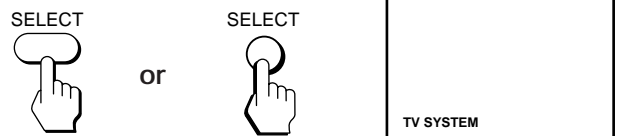

- 2 Press +/- on the remote commander or  $\triangle$ +/- on the TV to select the TV system.

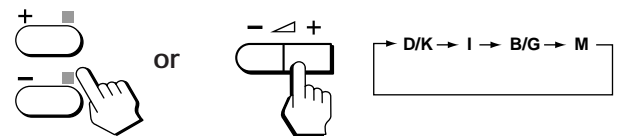

- 3 Press SELECT on the remote commander or the TV until AUTO PROGRAM appears on the screen.

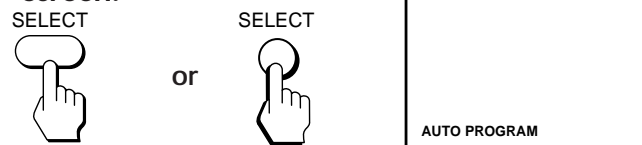

- 4 Press +/- on the remote commander or  $\triangle$ +/- on the TV.

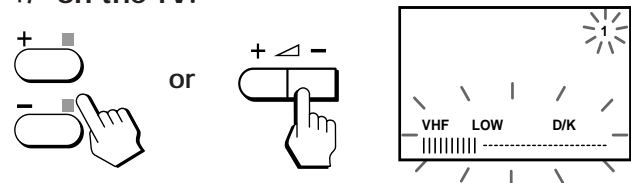

- 5 Press +/- on the remote commander or  $\triangle$ +/- on the TV again.

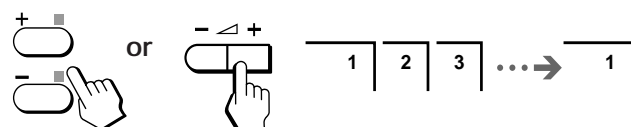



## To start presetting channels automatically from the specified program position

Press **PROGR +/-** or number buttons on the remote commander or **PROGR +/-** on the TV until the required program position appears on the screen after step 4.

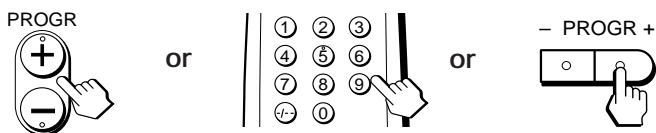

## Presetting channels manually

- 1 Press **SELECT** on the remote commander or the TV until "TV SYSTEM" appears on the screen.

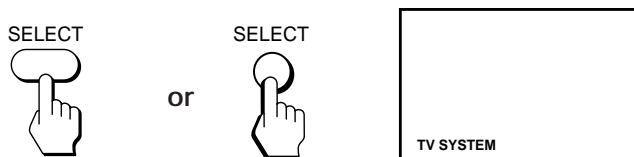

- 2 Press **+/-** on the remote commander or **△ +/-** on the TV to select the TV system.

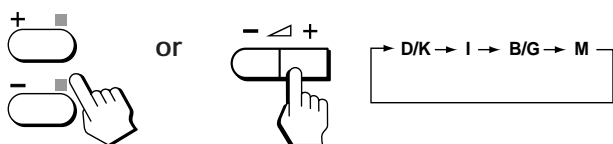

- 3 Press **SELECT** on the remote commander or the TV until **MANUAL PROGRAM** appears on the screen.

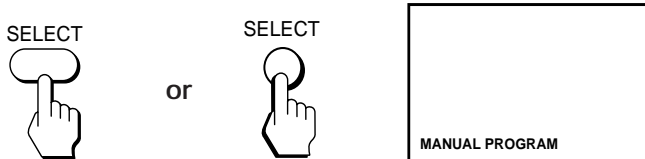

- 4 Press **+/-** on the remote commander or **△ +/-** on the TV.

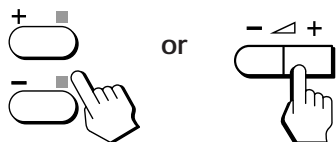

- 5 Press **PROGR +/-** or number buttons on the remote commander or **PROGR +/-** on the TV until the required program position appears on the screen.

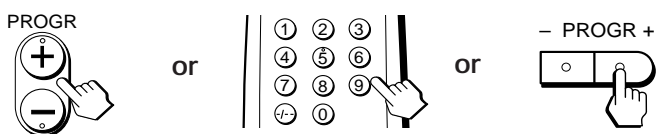

- 6 Press **+/-** on the remote commander or **△ +/-** on the TV until the required channel picture appears on the screen.

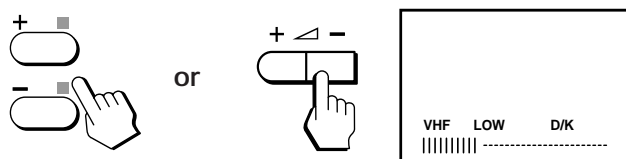

- 7 Press **SELECT** on the remote commander or the TV.

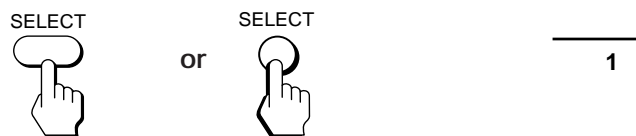

## Disabling program positions

- 1 Press **PROGR +/-** or number buttons on the remote commander or **PROGR +/-** on the TV until the unused or unwanted program position appears on the screen.

- 2 Press **SELECT** on the remote commander or the TV until "MANUAL PROGRAM" appears on the screen.

- 3 Press **+/-** on the remote commander or **△ +/-** on the TV.

- 4 Press **PIC MODE** on the remote commander.

- 5 Press **SELECT** on the remote commander or the TV.

To preset the disabled program position again  
Preset the channel quickly, automatically or manually.

# Watching the TV

**1** Press ① to turn on the TV.



When the TV is turned on in standby mode, press ① on the remote commander.

**2** Select the TV program you want to watch.

**To select a program position directly**

Press the number button.

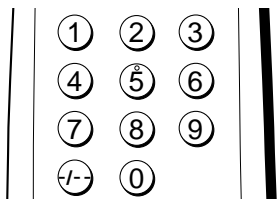

To select a two-digit program position, press “-/--” before the number buttons.

For example: to select program position 25, press “-/--,” and then “2” and “5.”



**To scan through program positions**

Press **PROGR +/-** until the program position you want appears.



**3** Press **▲ +/-** to adjust the volume.



## Turning off the TV

**To turn off the TV temporarily**

Press ① on the remote commander. The ① indicator lights up.

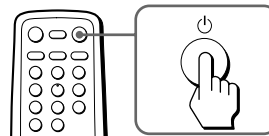

**To turn off the TV completely**

Press ① on the TV.

If the power on the TV is turned off in standby mode, the ① indicator may remain alight for a while.



## Watching the video input

Press **→** **⊕**.

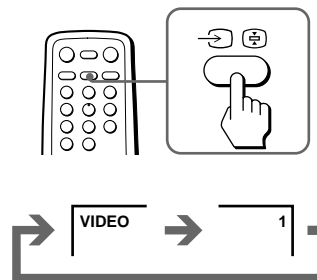

**To watch TV**

Press **□**.

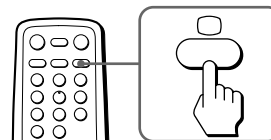

## Muting the sound

Press **⊗**.

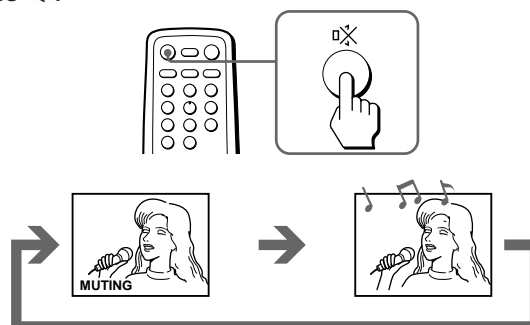



# Adjusting the picture

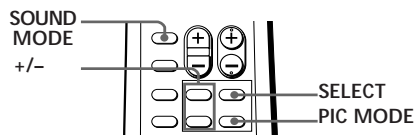

## Selecting the picture mode

Press PIC MODE until the mode you want appears.

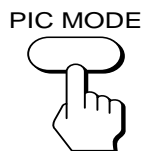

Each time you press PIC MODE, the screen changes as follows:

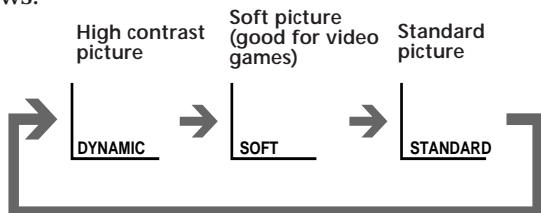

### Note

- If you change the picture mode after the following adjustments, the adjustment changes in accordance with the picture mode.

## Adjusting the picture setting

- Press SELECT until the item you want to adjust appears.



Each time you press SELECT, the screen changes as follows:

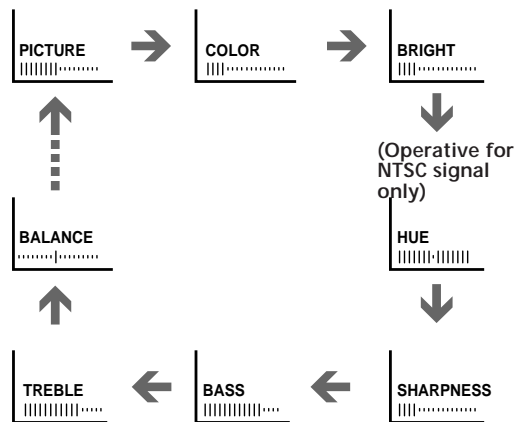

- Press +/- to adjust the item.

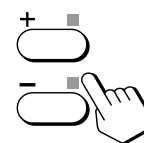

- To adjust other items, repeat steps 1 and 2.

### Note

- You can also use SELECT and  $\triangle$  +/- on the TV to adjust the picture setting.

### Front of TV

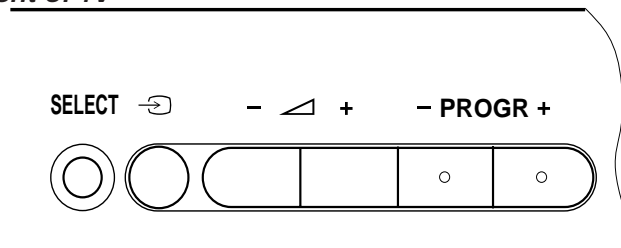

### If the color of the picture is abnormal

When receiving programs through the  $\Pi$  (antenna) terminal:

Change the "TV SYSTEM" or "COLOR SYSTEM" setting or adjust the "COLOR" level in the on-screen display until the color becomes normal.

### If the color of the picture is abnormal

When receiving programs through the  $\rightarrow$  (VIDEO INPUT) jacks:

Change the "COLOR SYSTEM" setting or adjust the "COLOR" level in the on-screen display until the color becomes normal.

### Note

- Normally set "COLOR SYSTEM" to "AUTO".

### If the sound is distorted or noisy

When receiving programs through the ㄗ (antenna) terminal:

Change the “TV SYSTEM“ setting level in the on-screen display until the sound becomes clear.

---

## Selecting the sound mode

Press **SOUND MODE** until the mode you want appears.

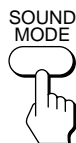

Each time you press **SOUND MODE**, the screen changes as follows:

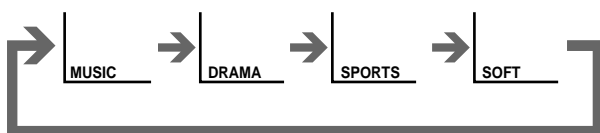

# Troubleshooting

If you have any problems, read this manual again and check the countermeasure for each of the symptoms listed below.

If the problem persists after trying the methods below, contact your nearest authorized service center or dealer.

## Snowy picture Noisy sound

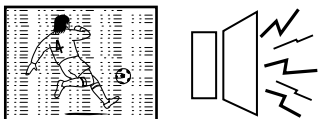

- ➔ Check the antenna.
- ➔ Check the antenna connection on the TV and on the wall.
- ➔ Check the "TV SYSTEM" setting.

## Dotted lines or stripes



- ➔ This may be caused by local interference (e.g. cars, neon signs and hair dryers). Adjust the antenna for minimum interference.

## Double images or "ghosts"



- ➔ This may be caused by reflections from nearby mountains or buildings. A highly directional antenna may improve the picture.

## Good picture Noisy sound

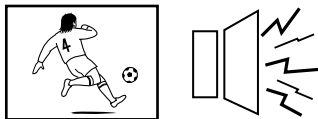

- ➔ Check the "TV SYSTEM" setting.

## No picture No sound

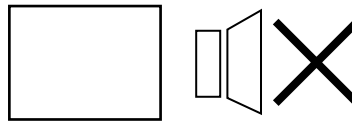

- ➔ Press ①.
- ➔ Check the antenna connection.
- ➔ Check the VCR connections.
- ➔ Check the power cord connection.
- ➔ Check the standby mode.

## Good picture No sound

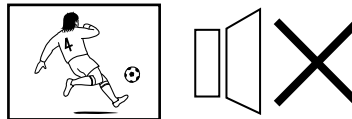

- ➔ Press +.
- ➔ Press .

## No color



- ➔ Adjust the COLOR level in the on-screen display.
- ➔ Check the "COLOR SYSTEM" setting.

## TV cabinet creaks

- ➔ Even if the picture or the sound is normal, changes in the room temperature sometimes make the TV cabinet expand or contract, making a noise. This does not indicate a malfunction.

# Specifications

	KV-T21TF2
<b>Power requirements</b>	110-240 V AC, 50/60 Hz
<b>Power consumption (W)</b>	Indicated on the rear of the TV
<b>Television system</b>	D/K, I, BG, M
<b>Color system</b>	PAL, PAL 60, NTSC4.43, NTSC3.58, SECAM
<b>Channel coverage</b>	VHF: C1 to C12, R1 to R12 / UHF: C13 to C57, R21 to R60 /
<b>D/K</b>	CATV: S01 to S03, S1 to S41, Z1 to Z39
<b>I</b>	UHF: B21 to B68 / CATV: S01 to S03, S1 to S41
<b>BG</b>	VHF: E2 to E12 / UHF: E21 to E69 / CATV: S01 to S03, S1 to S41
<b>M</b>	VHF: A2 to A13 / UHF: A14 to A79 / CATV: A-8 to A-2, A to W+4, W+6 to W+84
<b>Audio output (speaker)</b>	3W + 3W
<b>Inputs</b>	⏏ (Antenna): 75 ohms external terminal ⊖ (VIDEO IN) jacks: phono jacks Ⓜ (Video): 1 Vp-p, 75 ohms ♪ (Audio): 500 mVrms, high impedance
<b>Outputs</b>	Ⓜ (Headhone jack) ⊕ (MONITOR OUT) jacks: phono jacks Ⓜ (Video): 1 Vp-p, 75 ohms ♪ (Audio): 500 mVrms
<b>Picture tube</b>	22 in.
<b>Tube size (cm)</b>	54
<b>Screen size (cm)</b>	51
<b>Dimensions (w/h/d, mm)</b>	516 × 464 × 478
<b>Mass (kg)</b>	21

Design and specifications are subject to change without notice.

