

Trinitron[®] Color TV

#####

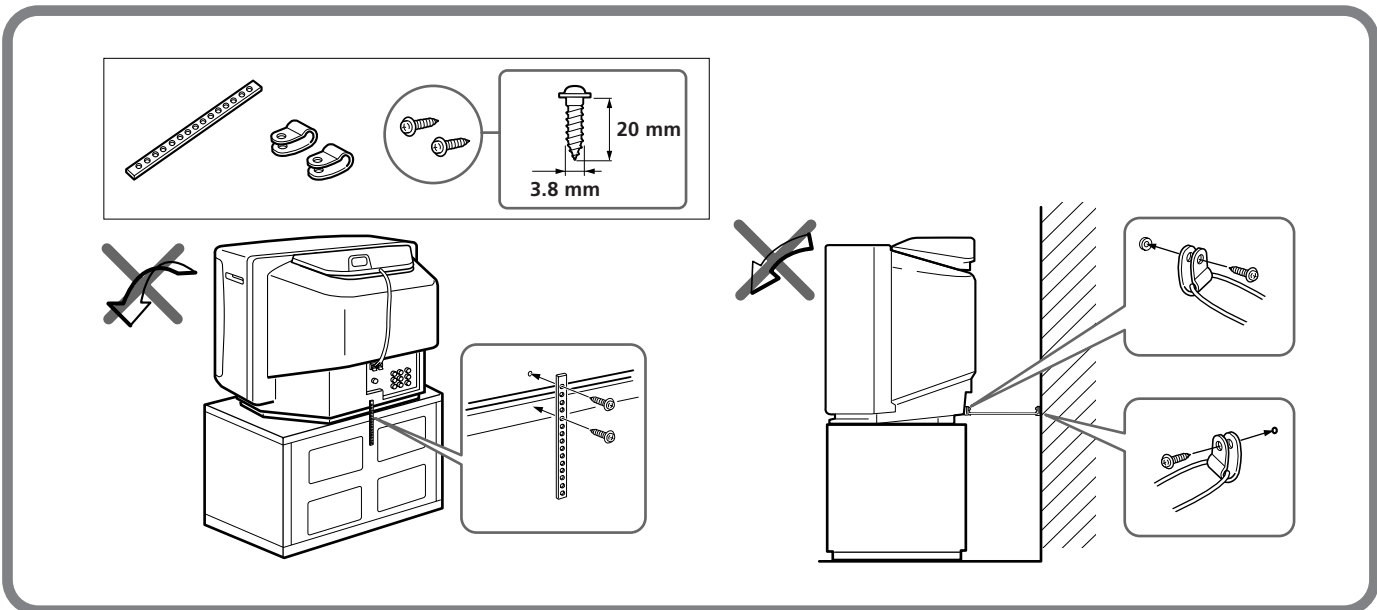

KV-H29TF

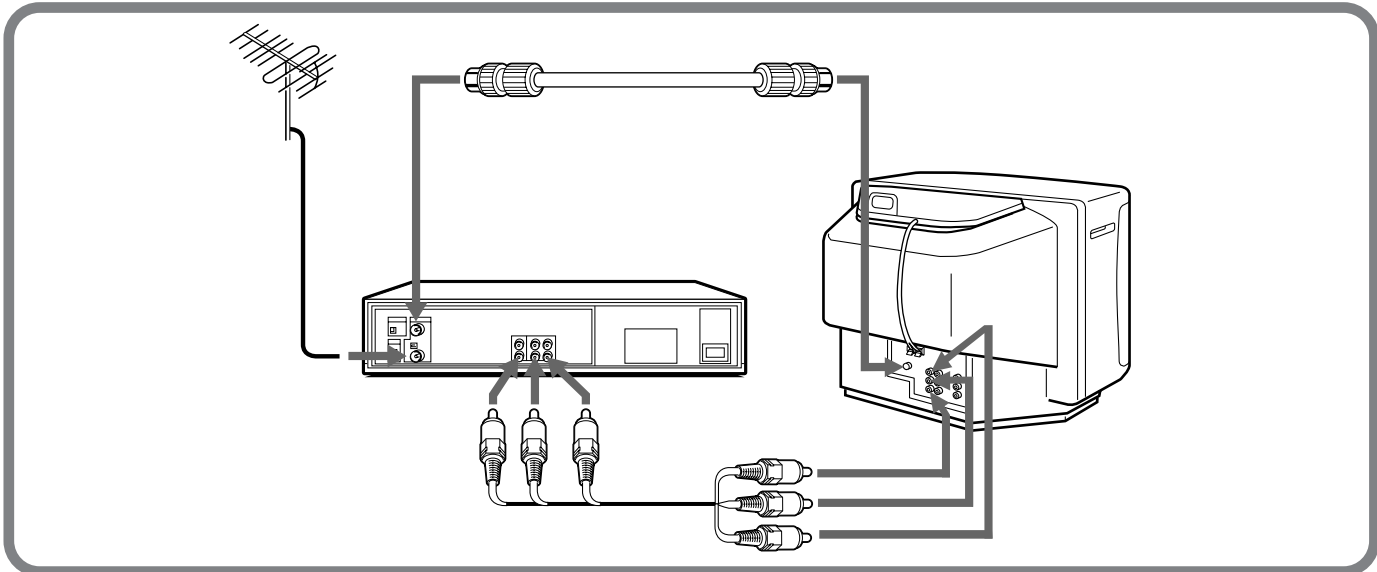
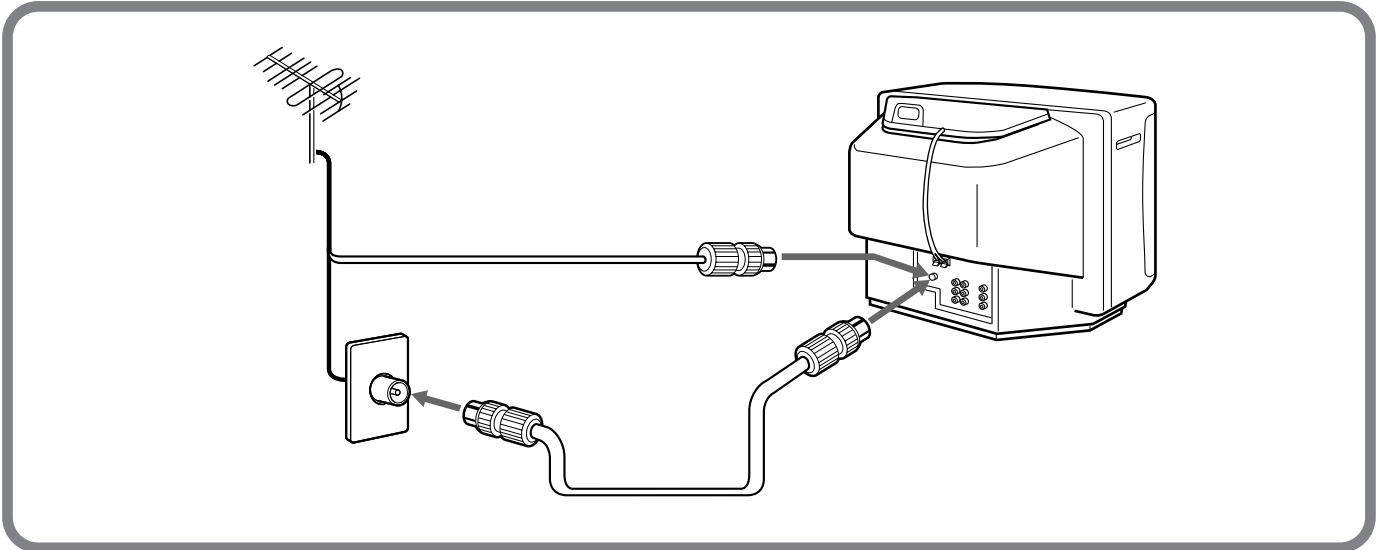

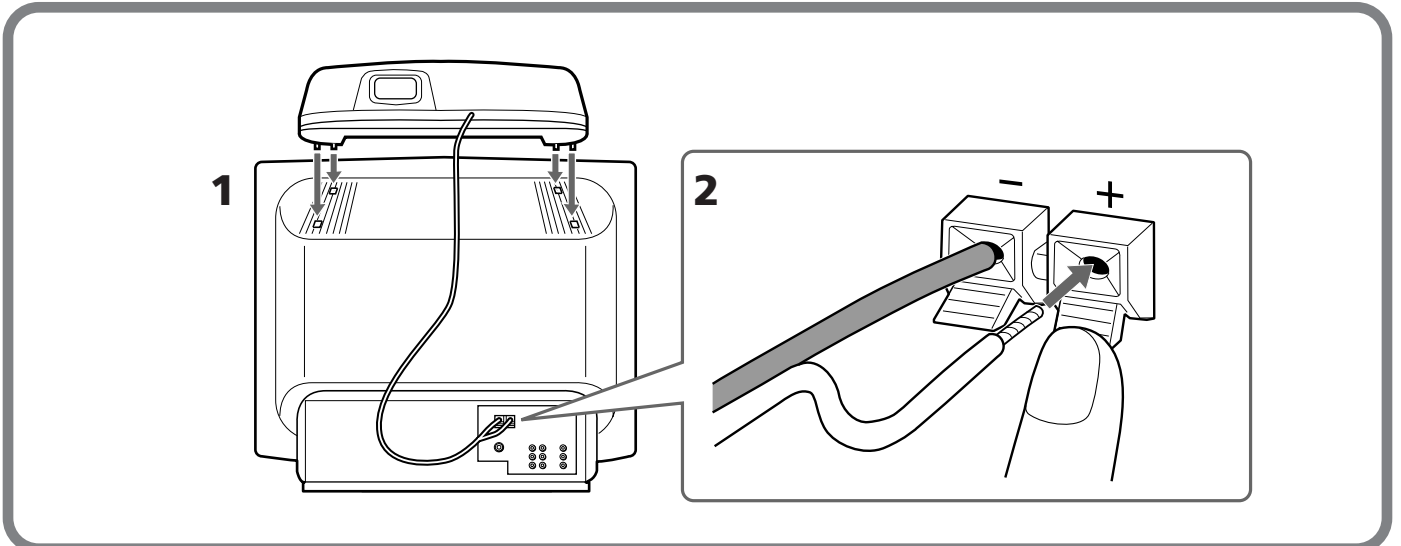
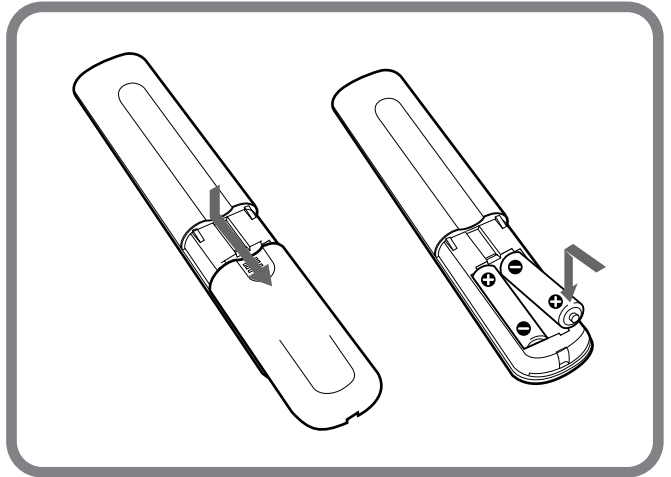
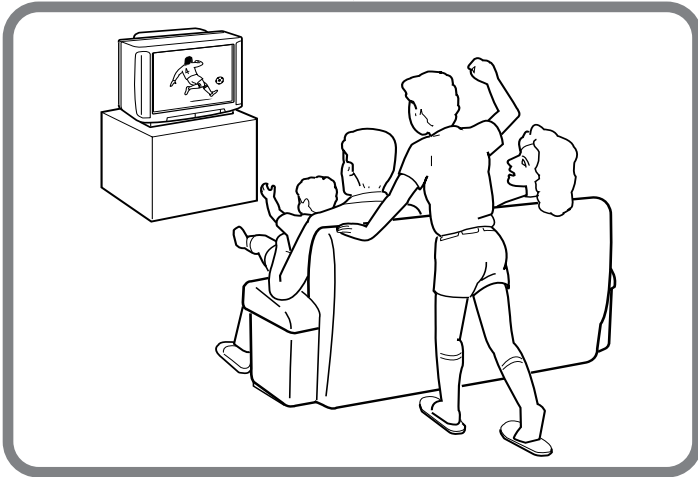
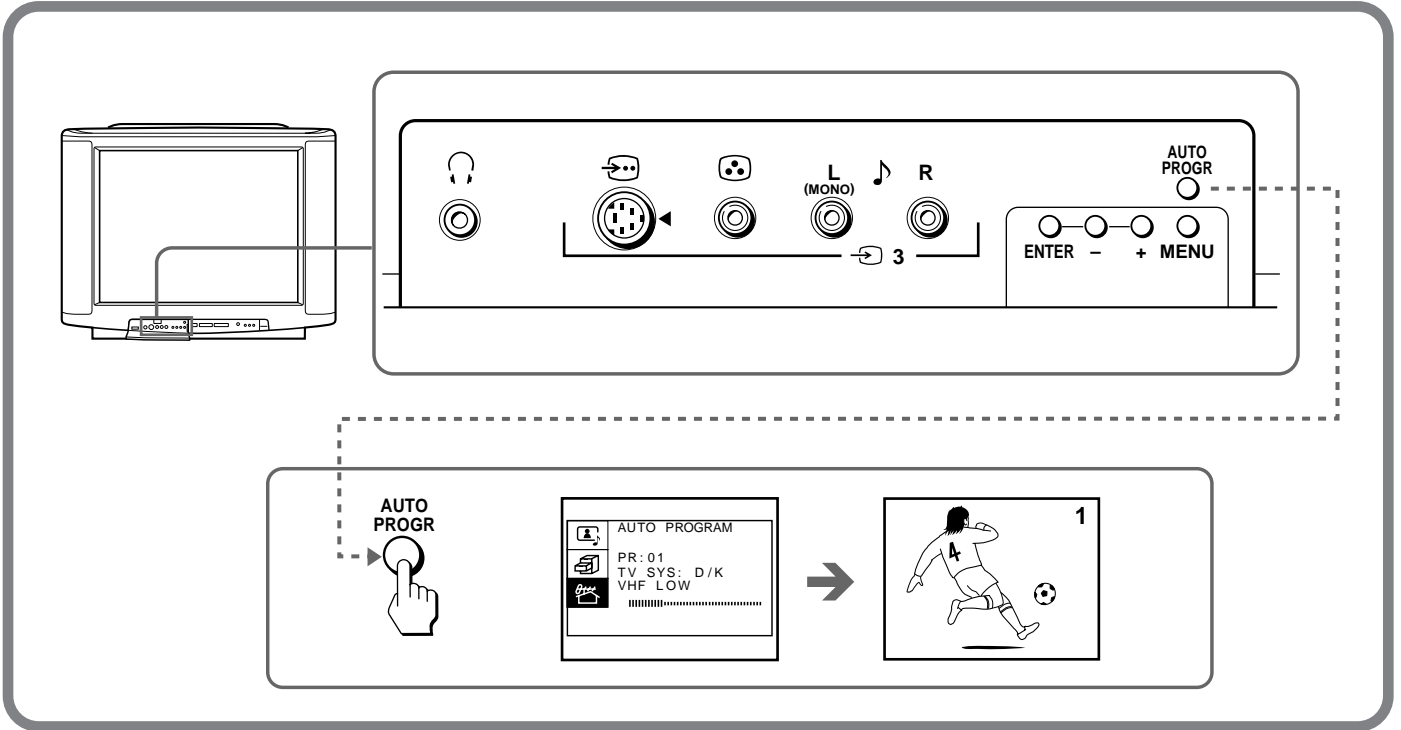

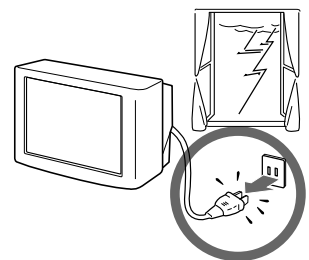
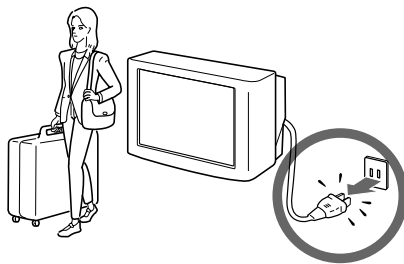
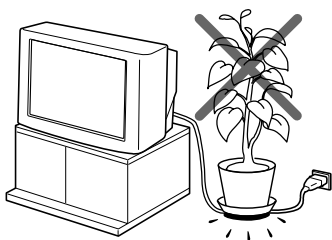
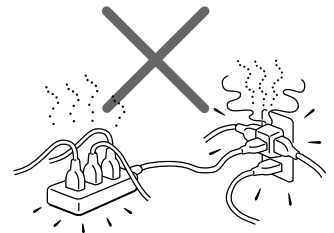
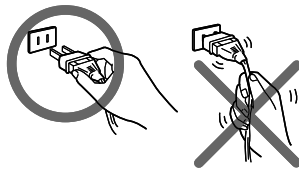
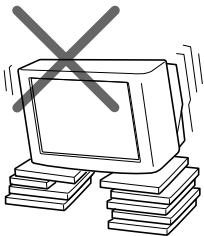
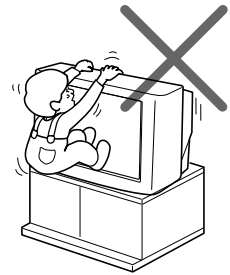
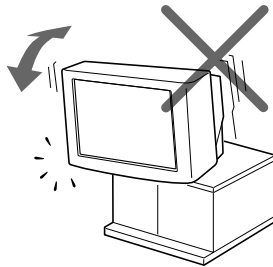
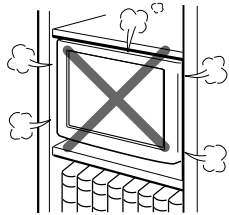
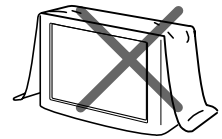
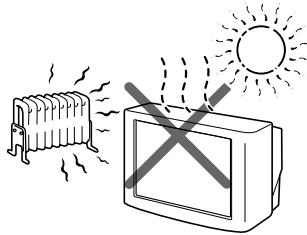
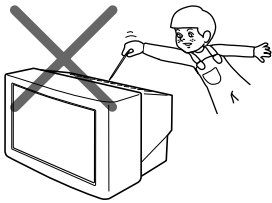
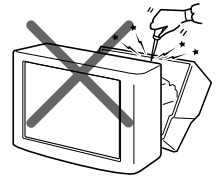
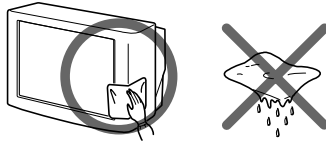
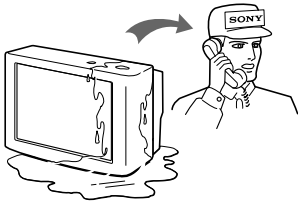
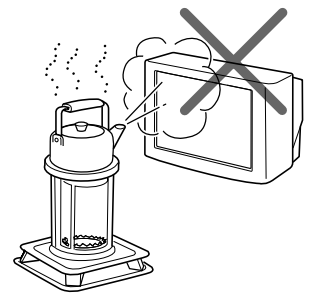
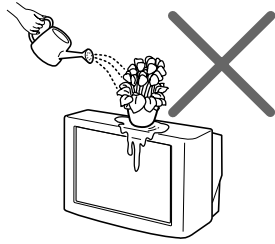
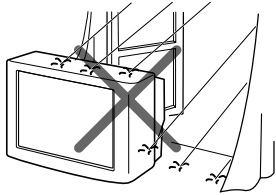

WARNING

- Dangerously high voltages are present inside the TV.
- Operate the TV only at 110-240 V AC.
- Do not open the cabinet and the rear cover of the TV. Refer servicing to qualified personnel.
- To prevent fire or shock hazard, do not expose the TV to rain or moisture.
- Do not operate the TV if any liquid or solid object falls into it. Have it checked immediately by qualified personnel only.
- Do not block the ventilation openings.
- Do not install the appliance in a confined space, such as a bookcase or built-in cabinet.
- Do not install the TV in hot, humid or excessively dusty places.
- Do not install the TV where it may be exposed to mechanical vibrations.
- Do not keep the TV plugged in if you are not going to use it for several days.
- Do not pull the power cord to disconnect the TV. Pull it out by the plug.
- Use only the supplied screws (as shown on page 2) to fasten the TV to the TV stand or to stabilize the TV against a wall or a pillar. Use of other screws may damage the TV.

Note on the remote commander

- The supplied remote commander is used on several models of the TV. If you do not find instructions for some controls that are on the remote commander, that means your TV does not employ the features of those controls, e.g. .

Notes

- When you turn on the TV, you may hear the “boon” sound that is caused by the demagnetization of the TV. This does not indicate a malfunction.
- The picture color may become abnormal if you change the direction of your TV. To obtain the normal picture color, press  on the TV to turn off the TV for five minutes and then turn it on again.

Table of contents

Getting Started

- 6 Connections
- 8 Introducing the menus
- 9 Changing the menu language
- 10 Presetting channels

Operations

- 12 Watching the TV
- 14 Adjusting the picture and sound
- 16 Listening to the woofer sound (3D WOOFER)
- 17 Listening to the surround sound (SURROUND)
- 18 Customizing the TV

Additional Information

- 19 Troubleshooting
- Back cover Specifications

All contents are subject to change without notice.
Design and specifications are subject to change without notice.

Connections

Connecting the 3D WOOFER

1 Attach the 3D WOOFER into the footholds on the top of the TV.

2 Connect the wires to the 3D WOOFER (8Ω) terminals at the rear of the TV.

The red wire should be connected to the ⊕ red terminal and the black wire to the ⊖ black terminal.

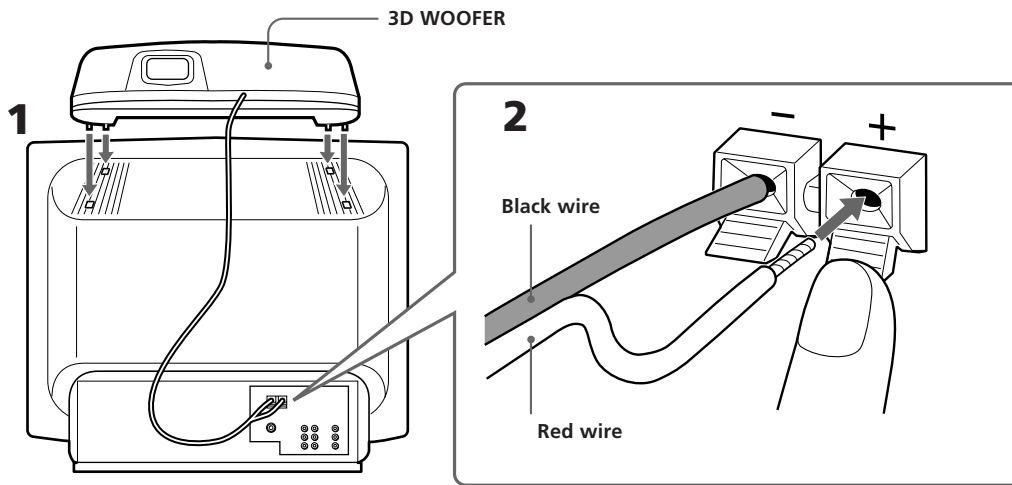

Notes

- Connect only the supplied 3D WOOFER; otherwise the TV may malfunction.
- Unplug the TV from the wall outlet when connecting the 3D WOOFER.
- Make sure that none of the 3D WOOFER wire strands stick out, making contact with the neighbouring speaker terminal, to prevent a malfunction caused by a short circuit of the terminals.

Connecting a VHF antenna or a combination VHF/UHF antenna — 75-ohm coaxial cable (round)

Attach an optional IEC antenna connector to the 75-ohm coaxial cable.

Plug the connector into the ⌈ (antenna) socket at the rear of the TV.

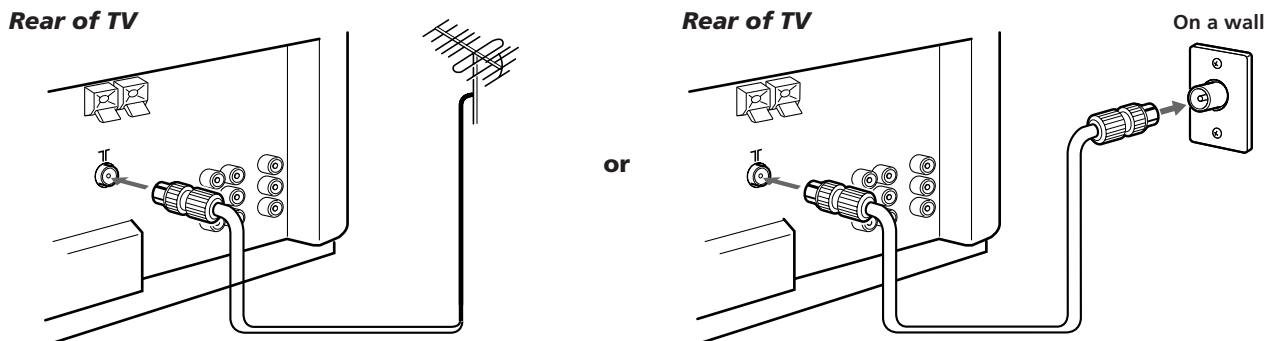

Connecting optional equipment

You can connect optional audio/video equipment to your TV such as a VCR, multi disc player, camcorder, video game, or stereo system.

Connecting video equipment using video input jacks

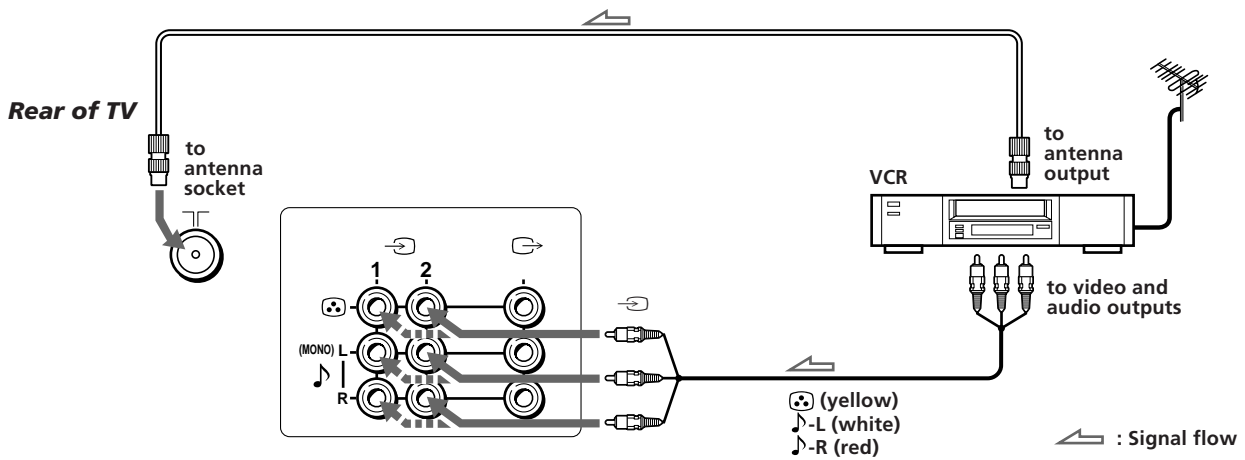

Front of TV

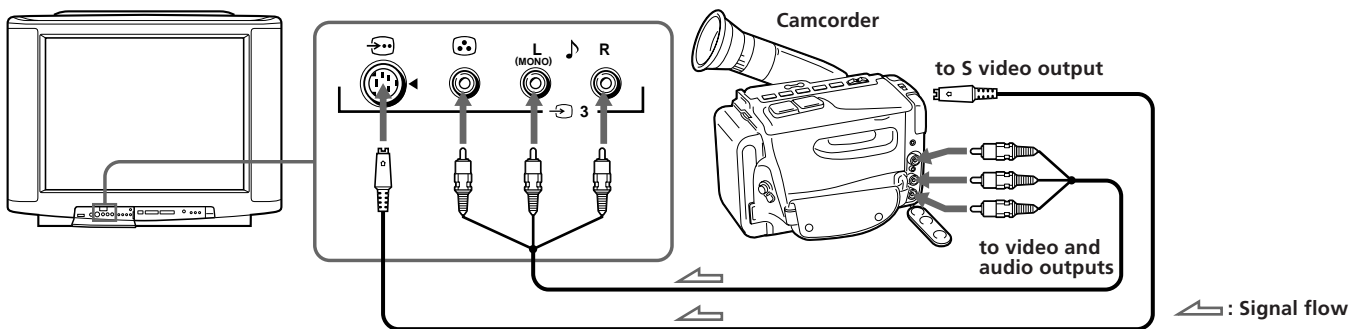

When connecting a monaural VCR

Connect the yellow plug to (VIDEO) and the black plug to ♪ (AUDIO)-L (MONO).

When connecting a VCR to the ㄇ (antenna) terminal

Preset the signal output from the VCR to the program position 0.

If both S Video and video signals are input simultaneously

The S Video input signal is selected. To view a video input signal, disconnect the (S Video) connection.

Note on the video input

When no signal is input, the screen becomes blue.

Connecting audio/video equipment using (MONITOR/TV OUT) jacks

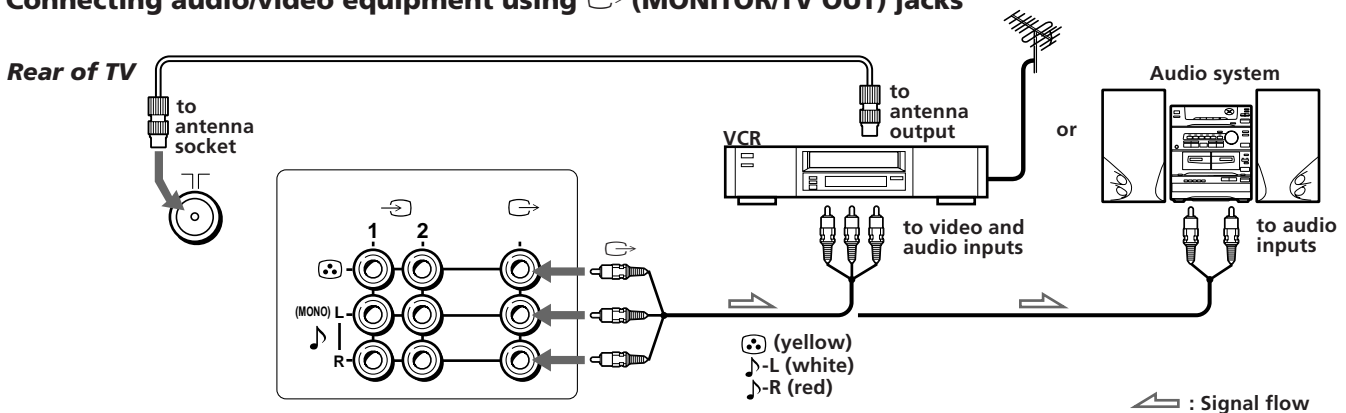

Introducing the menus

You can preset TV channels, adjust the picture and sound qualities, and select some settings using the on-screen menus. You can use the buttons on both the remote commander and the TV to operate the menus.

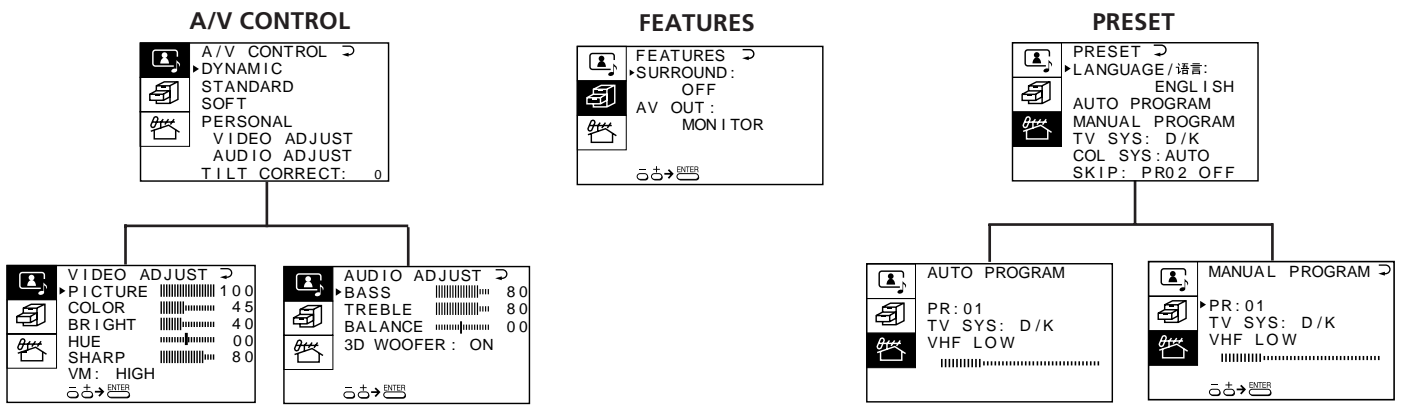

Getting back to the previous menu (except for AUTO PROGRAM)

Press + or - to move the cursor (▶) to the first line (▷) of each menu, and press ENTER.

Cancelling the menu screen

Press MENU.

Notes (except for AUTO PROGRAM)

- When a menu is selected after pressing ENTER, the color of both the menu and the menu symbol change and the cursor (▶) appears beside the first item of the menu.
- When an item on the menu is selected after pressing ENTER, the color of the item changes.
- You can refer to the guide (◀▶→ENTER) at the bottom of the menus (except for the A/V CONTROL and PRESET menus) for the basic operations of the menu.
- If more than approximately 60 seconds elapse after you press a button, the menu screen disappears automatically.

Changing the menu language

If you prefer English to Chinese, you can change the menu language. You can use buttons on the remote commander or the TV.

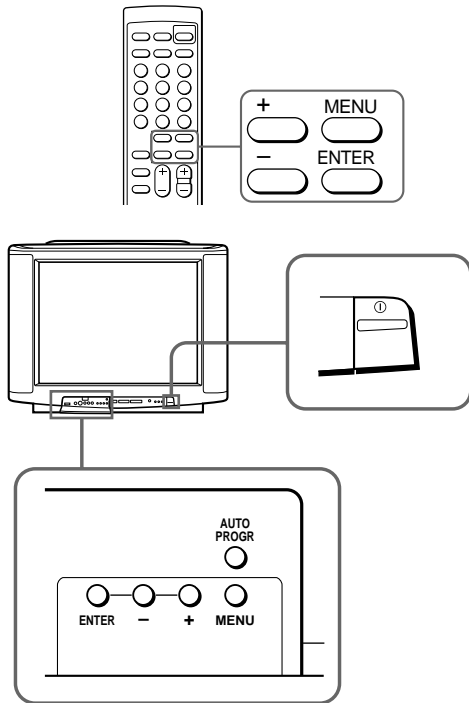

1 Press ① to turn on the TV.

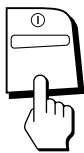

2 Press MENU.

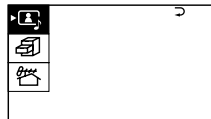

3 Press + or - to move the cursor (▶) to the PRESET menu (PRESET), and press ENTER.

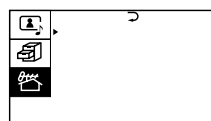
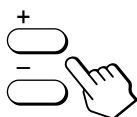

4 Make sure the cursor (▶) appears beside ###/LANGUAGE, and press ENTER.

5 Press + or - to select "ENGLISH", and press ENTER.

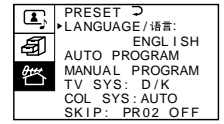
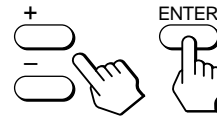

All of the menus change to English.

6 Press MENU to return to the normal screen.



Presetting channels

You can preset TV channels easily by storing all the receivable channels automatically. You can also preset channels manually or disable program positions (see page 11).

Presetting channels automatically

You can preset up to 100 TV channels in numerical sequence from the program position 1. You can preset channels automatically using the button on the TV or the menu.

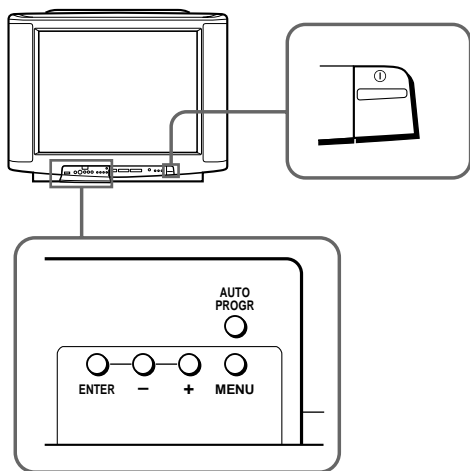

1 Press ① to turn on the TV.

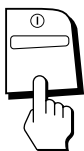

2 Press **AUTO PROGR**.

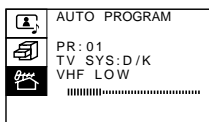

The TV starts scanning and presetting channels automatically. When all of the receivable channels are stored, the first preset TV program appears on the screen.

To preset channels automatically using the menu

- 1** Press **MENU**.
- 2** Press **+** or **-** to move the cursor (▶) to the **PRESET** menu (📺), and press **ENTER**.
- 3** Press **+** or **-** to move the cursor (▶) to **AUTO PROGRAM**, and press **ENTER**.

Presetting channels manually

To change the program position for a channel or to receive a channel with a weak signal which you cannot receive by automatic presetting, preset the channel manually.

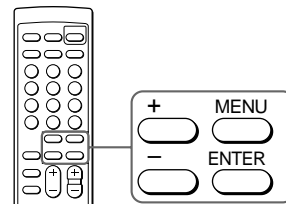

1 Press **MENU**.

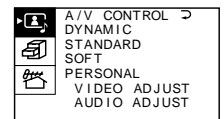

2 Press **+** or **-** to move the cursor (▶) to the **PRESET** menu (📺), and press **ENTER**.

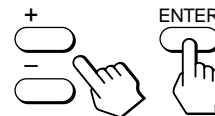

3 Select your local TV system.

- (1) Press **+** or **-** to move the cursor (▶) to **TV SYS**, and press **ENTER**.
- (2) Press **+** or **-** until your local TV system appears on the menu, and press **ENTER**.

4 Press **+** or **-** to move the cursor (▶) to **MANUAL PROGRAM**, and press **ENTER**.

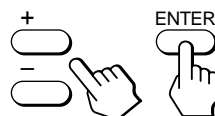

5 Select the program position to which you want to preset a channel.

- (1) Make sure the cursor (▶) appears beside PR, and press ENTER.
- (2) Press + or – until the program position you want appears on the menu, and press ENTER.

6 Select the desired channel.

- (1) Press + or – to move the cursor (▶) to VHF LOW, and press ENTER.
- (2) Press + or – until the desired channel picture appears on the TV screen, and press ENTER.

7 Press MENU to return to the normal screen.

If the TV system is not properly selected

The picture color may be poor and/or the sound may be noisy. In this case, select the appropriate TV system.

- 1 Press PROGR +/- or the number buttons to select the program position.
- 2 Display the PRESET menu.
- 3 Press + or – to move the cursor (▶) to TV SYS, and press ENTER.
- 4 Press + or – until the appropriate TV system appears, and press ENTER.

Notes

- The TV system setting is memorized for each program position.
- If you do not know your local TV system, consult your nearest Sony dealer or authorized service center.

Disabling program positions

By disabling unused or unwanted program positions, you can skip those positions when you press PROGR +/-.

1 Press MENU.

2 Press + or – to move the cursor (▶) to the PRESET menu (), and press ENTER.

3 Press + or – to move the cursor (▶) to SKIP, and press ENTER.

4 Press + or – until the unused or unwanted program position appears on the menu, and press ENTER.

5 Press + or – to select ON, and press ENTER.

6 To disable other program positions, repeat steps 4 and 5.

7 Press MENU to return to the normal screen.

To cancel the skip setting

- 1 Display the PRESET menu.
- 2 Press + or – to move the cursor (▶) to SKIP, and press ENTER.
- 3 Press + or – until the program position you want to cancel the skip setting appears, and press ENTER.
- 4 Press + or – to select OFF, and press ENTER.

Watching the TV

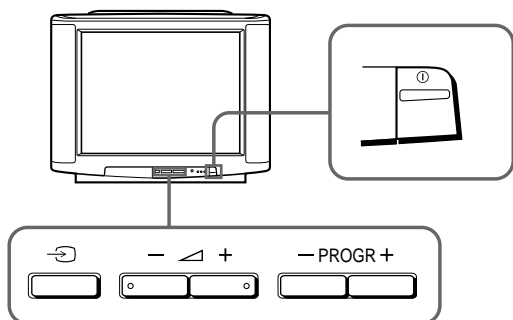

1 Press ① to turn on the TV.

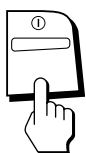

When the TV is turned on in the standby mode after pressing ① on the TV, press ⏻ on the remote commander.

2 Select the TV program you want to watch.

To select a program position directly

Press the number button.

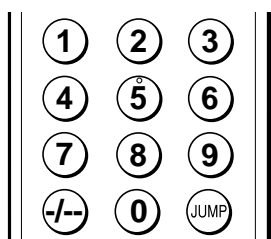

To select a two-digit program position, press “-/-” before the number buttons.

For example: to select program position 25, press “-/-,” then “2” and “5.”



To scan through program positions

Press PROGR +/- on the remote commander or the TV until the program position you want appears.

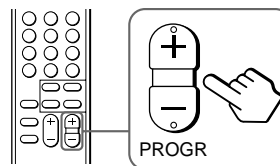

3 Press ▲ +/- on the remote commander or the TV to adjust the volume.

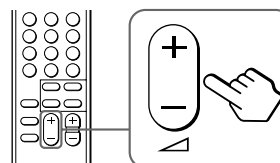

Turning off the TV

To turn off the TV temporarily

Press ① on the remote commander. The ⏻ indicator lights up.

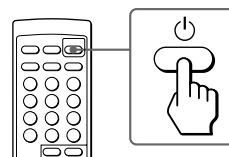

To turn off the TV completely

Press ① on the TV.

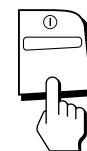

Watching the video input

Press → ⊕ on the remote commander or → on the TV.

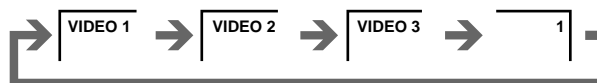
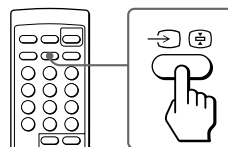

To watch TV

Press  on the remote commander or  on the TV.

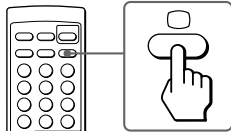

Switching back quickly to the previous channel

Press **JUMP**.

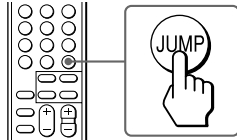

Muting the sound

Press .

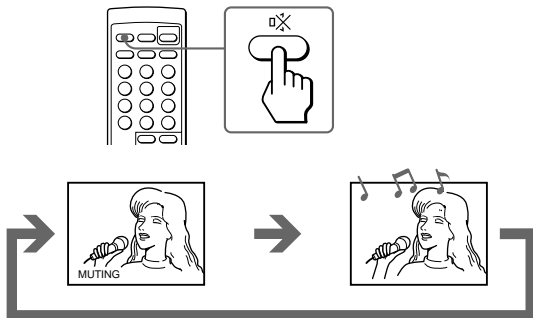

Displaying the on-screen information

Press  .

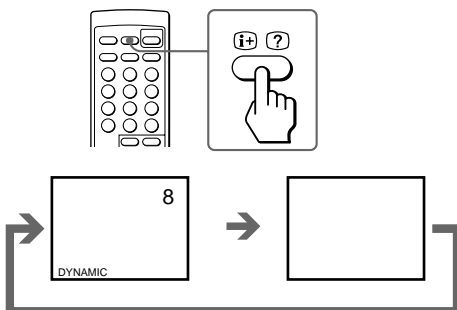

Note

The on-screen display shows the program position or the video mode and the picture and sound information. The on-screen display for the picture and sound information disappear after being displayed for approximately three seconds.

Setting the Wake Up Timer

You can set the TV to turn on automatically after the period of time you want.

1 Press repeatedly to set the timer.

The on-screen display appears.

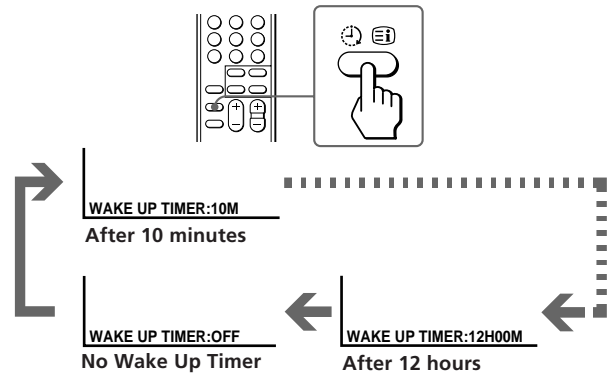

2 If you want a particular TV program or video mode to be displayed using the Wake Up Timer, select the TV program or video mode.

3 Press on the remote commander or set the Sleep Timer to turn off the TV in the standby mode.

The  indicator lights up in amber color.

To cancel the Wake Up Timer, press  repeatedly until “WAKE UP TIMER: OFF” appears, or turn off the main power of the TV.

Notes



- The Wake Up Timer starts immediately after the on-screen display disappears.
- The last TV program position or video mode just before the TV turns into the standby mode will appear when the TV is turned on using the Wake Up Timer.
- If no buttons or controls are pressed for more than two hours after the TV is turned on using the Wake Up Timer, the TV automatically turns into the standby mode. If you want to continue watching the TV, press any button or control on the TV or remote commander.

Setting the Sleep Timer

You can set the TV to turn off automatically after the period of time you want.

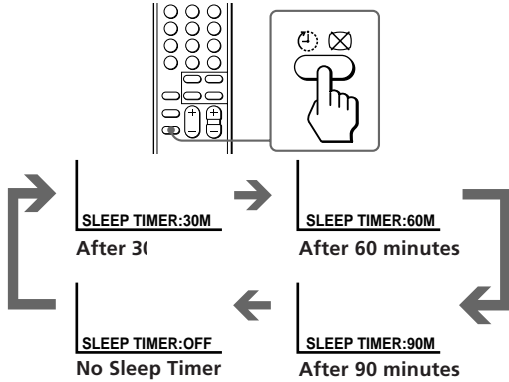
Press  .



To cancel the Sleep Timer, press   repeatedly until "SLEEP TIMER: OFF" appears, or turn the TV off.

Adjusting the picture and sound

Selecting the picture and sound modes

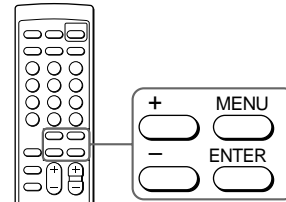

1 Press MENU.

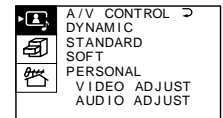

2 Make sure the cursor (▶) appears in the A/V CONTROL menu (A), and press ENTER.

3 Press + or - to move the cursor (▶) to DYNAMIC, STANDARD, SOFT, or PERSONAL, and press ENTER.

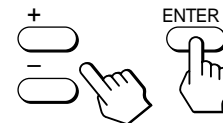

Select	To
DYNAMIC	Receive high contrast picture with powerful sound.
STANDARD	Receive normal contrast picture with medium listening sound.
SOFT	Receive mild picture with soft sound.
PERSONAL	Receive the last picture and sound settings that are adjusted using VIDEO ADJUST and AUDIO ADJUST.

4 Press MENU to return to the normal screen.



Adjusting the picture settings (VIDEO ADJUST)

You can adjust the picture settings to suit your taste with the VIDEO ADJUST option. The adjusted settings are stored in the PERSONAL option.

1 Press MENU.

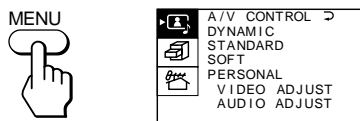

2 Make sure the cursor (▶) appears in the A/V CONTROL menu (A/V), and press ENTER.

3 Press + or - to move the cursor (▶) to VIDEO ADJUST, and press ENTER.

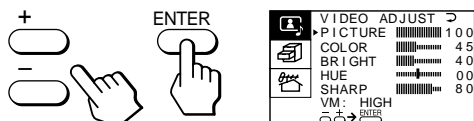

4 Press + or - to move the cursor (▶) to the item you want to adjust, and press ENTER.

5 Press + or - to adjust the selected item, and press ENTER.

For details on each item, see “Description of adjustable items” below.

6 To adjust other items, repeat steps 4 and 5.

7 Press MENU to return to the normal screen.

Description of adjustable items

Item	Press -	Press +
PICTURE	Decrease picture contrast.	Increase picture contrast.
COLOR	Decrease color intensity.	Increase color intensity.
BRIGHT	Darken the picture.	Brighten the picture.
HUE	Make picture tones become reddish.	Make picture tones become greenish.
SHARP	Soften the picture.	Sharpen the picture.
VM	Decrease emphasis on picture edges.	Increase emphasis on picture edges.

Note

You can adjust HUE for the NTSC color system only.

If the picture is slightly snowy

You may try to improve the picture by changing the VM setting as described below:

- 1 Display the VIDEO ADJUST menu.
- 2 Press + or - to move the cursor (▶) to VM, and press ENTER.
- 3 Press + or - to select LOW, and press ENTER.

If the picture color is abnormal when receiving programs through the ㄗ (antenna) terminal

Change the color system or the TV system from the PRESET menu as described below until the color becomes normal.

- 1 Display the PRESET menu.
- 2 Press + or - to move the cursor (▶) to COL SYS or TV SYS, and press ENTER.
- 3 Press + or - to change the color system or the TV system until the color becomes normal, and press ENTER.

Note

Normally set the color system (COL SYS) to AUTO.

Adjusting the sound settings (AUDIO ADJUST)

You can adjust the sound settings to suit your taste with the AUDIO ADJUST option. The adjusted settings are stored in the PERSONAL option.

1 Press MENU.

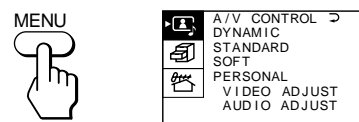

2 Make sure the cursor (▶) appears in the A/V CONTROL menu (A/V), and press ENTER.

3 Press + or - to move the cursor (▶) to AUDIO ADJUST, and press ENTER.

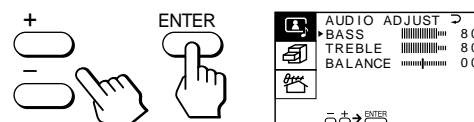

4 Press + or - to move the cursor (▶) to the item you want to adjust, and press ENTER.

Continue to next page →

5 Press + or – to adjust the selected item, and press ENTER.

For details on each item, see “Description of adjustable items” below.

6 To adjust other items, repeat steps 4 and 5.

7 Press MENU to return to the normal screen.

Description of adjustable items

Item	Press –	Press +
BASS	Decrease the bass sound.	Increase the bass sound.
TREBLE	Decrease the treble sound.	Increase the treble sound.
BALANCE	Increase the left speaker's volume	Increase the right speaker's volume.

If the sound is distorted or noisy when receiving programs through the ㄗ (antenna) terminal

Change the TV system from the PRESET menu as described below until the sound becomes normal.

- 1 Display the PRESET menu.
- 2 Press + or – to move the cursor (▶) to TV SYS, and press ENTER.
- 3 Press + or – to change the TV system until the sound becomes normal, and press ENTER.

Listening to the woofer sound (3D WOOFER)

The 3D WOOFER enhances bold, dynamic and clear sounds that spread over a large area and lets you enjoy the thrills, horrors, and suspense of movies or music. The initial setting of the 3D WOOFER is **ON**, and it is ready for your listening when you turn on the TV.

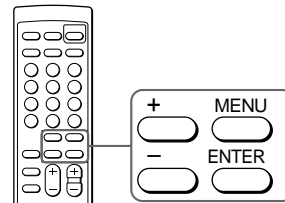

To turn off the woofer sound

1 Press MENU.

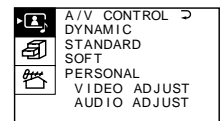

2 Make sure the cursor (▶) appears in the A/V CONTROL menu (A), and press ENTER.

3 Press + or – to move the cursor (▶) to AUDIO ADJUST, and press ENTER.

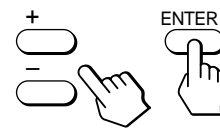

4 Press + or – to move the cursor (▶) to 3D WOOFER, and press ENTER.

5 Press + or – to select OFF, and press ENTER.

6 Press MENU to return to the normal screen.

Notes

- To listen to the woofer sound, make sure that the 3D WOOFER is properly connected to the TV (see page 6).
- You can also disconnect the 3D WOOFER from the TV to turn off the woofer sound.

Listening to the surround sound (SURROUND)

The SURROUND feature enables you to enjoy a surround sound effect that is like being in a large hall or live concert when receiving stereo signals.

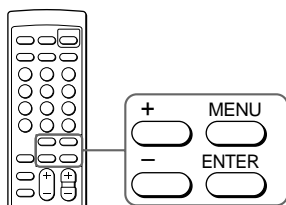

1 Press MENU.

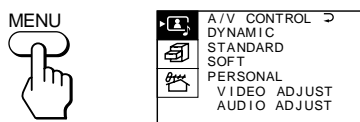

2 Press + or - to move the cursor (▶) to the FEATURES menu (FEATURES), and press ENTER.

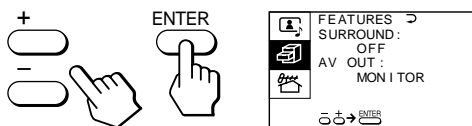

3 Make sure the cursor (▶) appears beside SURROUND, and press ENTER.

4 Press + or - to select HALL<SRS>, LIVE<SRS>, or SPACE, and press ENTER.

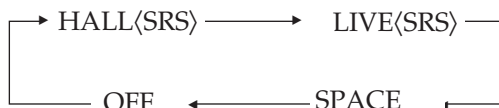

For details on each item, see “Description of adjustable items” below.

5 Press MENU to return to the normal screen.

Description of adjustable items

Select	To
HALL<SRS>	Listen to a sound that spreads out over a large area.
LIVE<SRS>	Listen to the sound that gives the feeling of being at a live concert.
SPACE	Listen to a monaural sound that gives a stereo-like effect.
OFF	Turn off the surround sound.

Note

The (●) © SRS (SOUND RETRIEVAL SYSTEM) is manufactured by Sony Corporation under license from SRS Labs, Inc. It is covered by U.S. Patent No. 4,748,669. The word “SRS” and the SRS symbol (●) are registered trademarks of SRS Labs, Inc.

Customizing the TV

Using the AV OUT (advanced rec-out) terminal

You can select the output signal from the ⇨ (MONITOR/TV OUT) jacks at the rear of the TV.

1 Press MENU.

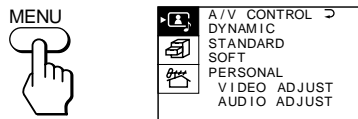

2 Press + or - to move the cursor (▶) to the FEATURES menu (FEATURES), and press ENTER.

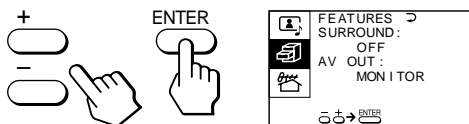

3 Press + or - to move the cursor (▶) to AV OUT, and press ENTER.

4 Press + or - to select the output signal, and press ENTER.

Select	To
TV	Output the signal of the TV broadcast.
MONITOR	Output the signal of the picture you are watching as a main picture.

Note

Do not change the channel while recording with a VCR through the ⇨ (MONITOR/TV OUT) jacks. If you change the channel, it also changes the channel you are recording.

Adjusting the picture tilt

You can adjust the picture tilt if it is not aligned to the TV screen. This may happen due to the direction of the earth's magnetic fields in relation to the TV position.

1 Press MENU.

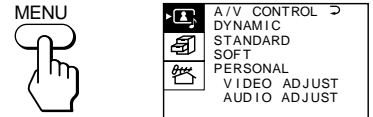

2 Make sure the cursor (▶) appears in the A/V CONTROL menu (A/V CONTROL), and press ENTER.

3 Press + or - to move the cursor (▶) to TILT CORRECT, and press ENTER.

4 Press + or - to select the most suitable value to adjust the picture tilt, and press ENTER.

TILT CORRECT:

-5 ← -4 ← -3 ← -2 ← -1 ← 0 → +1 → +2 → +3 → +4 → +5
Press - Press +

Troubleshooting

If you have any problems, read this manual again and check the countermeasure for each of the symptoms listed below.

If the problem persists after trying the methods below, contact your nearest Sony dealer or authorized service center.

Snowy picture Noisy sound

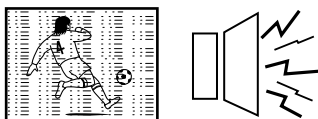

- ➔ Check the antenna.
- ➔ Check the antenna connection on the TV and on the wall.
- ➔ Check the TV system (TV SYS) setting.

Dotted lines or stripes



- ➔ This may be caused by local interference (e.g. cars, neon signs, hair dryers, etc.). Adjust the antenna for minimum interference.

Double images or "ghosts"



- ➔ This may be caused by reflections from nearby mountains or buildings. A highly directional antenna may improve the picture.

Good picture Noisy sound

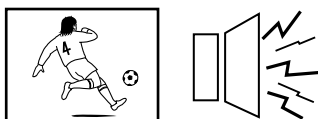

- ➔ Check the TV system (TV SYS) setting.

No picture No sound

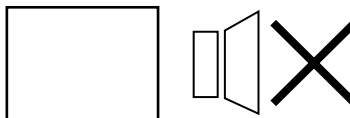

- ➔ Press ①.
- ➔ Press ① to turn off the TV for about five seconds and then turn it on again.
- ➔ Check the power cord connection.
- ➔ Check the antenna connection.
- ➔ Check the VCR connections.

Good picture No sound

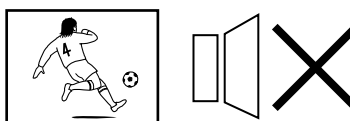

- ➔ Press \triangle +.
- ➔ Press \square ✕.

No color



- ➔ Adjust the COLOR level in the VIDEO ADJUST menu of the PERSONAL option.
- ➔ Check the color system (COL SYS) setting.

No sound from 3D WOOFER

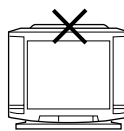





- ➔ Check the connection of the 3D WOOFER.

TV cabinet creaks

- ➔ Even if the picture or the sound is normal, changes in the room temperature sometimes make the TV cabinet expand or contract, making a noise. This does not indicate a malfunction.

Specifications

	KV-H29TF	Note
Power requirements	110-240 V AC, 50/60 Hz	
Power consumption (W)	Indicated on the rear of the TV	
Television system	B/G, I, D/K, M	
Color system	PAL, PAL 60, SECAM, NTSC4.43, NTSC3.58	
Channel coverage		
B/G	VHF : E2 to E12 / UHF : E21 to E69 / CATV : S01 to S03, S1 to S41	
I	UHF : B21 to B68 / CATV : S01 to S03, S1 to S41	
D/K	VHF : C1 to C12, R1 to R12 / UHF : C13 to C57, R21 to R60 / CATV: Z1 to Z39, S01 to S03, S1 to S41	
M	VHF : A2 to A13 / UHF : A14 to A79 / CATV: A-8 to A-2, A to W+4, W+6 to W+84	
Antenna	75-ohm external terminal	
Audio output (speaker)	5 W + 5 W + 15 W (3D WOOFER)	
Number of terminal		
 (Video)	Input : 3 Output : 1	Phono jacks; 1 Vp-p, 75ohms
 (Audio)	Input : 3 Output : 1	Phono jacks; 500 mVrms
 (S Video)	Input : 1	Y: 1 Vp-p, 75 ohms, unbalanced, sync negative C: 0.286 Vp-p, 75 ohms
 (Headphone)	Output : 1	Minijack
3D WOOFER	Output : 1	
Picture tube	Super Trinitron Plus (29 in.)	
Tube size (cm)	72	Measured diagonally
Screen size (cm)	68	Measured diagonally
Dimensions (w/h/d, mm)	782 x 593 x 534	
Mass (kg)	49	

Design and specifications are subject to change without notice.