



## English

Before operating the unit, please read this manual thoroughly and retain it for future reference.

## WARNING

**To reduce the risk of fire or electric shock, do not expose this apparatus to rain or moisture.**

**To reduce the risk of electrical shock, do not open the cabinet. Refer servicing to qualified personnel only.**

You are cautioned that any changes or modifications not expressly approved in this manual could void your authority to operate this equipment.

The validity of the CE marking is restricted to only those countries where it is legally enforced, mainly in the countries EEA (European Economic Area).

## Features

- Noise canceling headphones reduce unwanted ambient noise, providing a quieter environment to enhance your listening experience. A microphone inside each earpiece works with electronic circuitry to create an opposite sound wave to cancel out the noise. Up to 85 % ambient noise cancellation (Over 16.5 dB is reduced at 200 Hz)
- Slim, folding design for easy portability
- Neodymium magnets for powerful sound
- Dual-use capability allows option to listen to music with or without noise cancellation
- Built-in monitor function lets you silence the audio to listen outside
- Supplied plug adaptor for easy connectivity to stereo or dual jack for in-flight music services

## Installing a battery

- Push the “BATT ▲” button located at the bottom of the right housing. The lid of the battery box opens slightly.

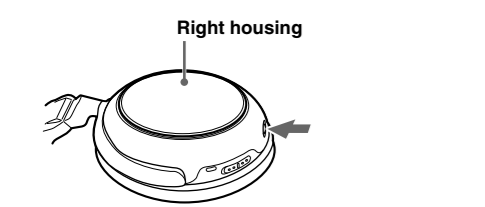

- Open the lid of the battery box of the headphone to insert one size AAA battery.

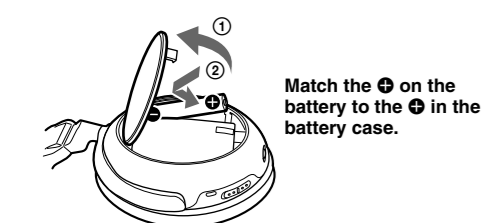

### Note

The lid of the battery box opens only so far, as shown in the illustration. Do not further force open the lid as it may damage it.

- Close the lid.

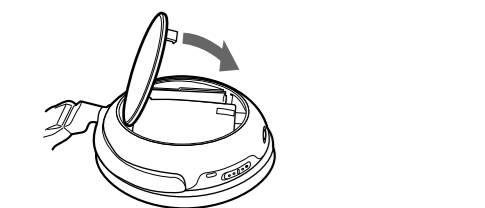

### Battery life

Battery	Approx. hours <sup>*1</sup>
Sony alkaline LR03/AM-4 (N) (size AAA) battery	30 hours <sup>*2</sup>
Sony manganese R03/ UM-4 (NU) (size AAA) battery	15 hours <sup>*2</sup>

<sup>[1]</sup> 1 kHz, 0.1 mW + 0.1 mW output

<sup>[2]</sup> Time stated above may vary, depending on the temperature or conditions of use.

### Note

Because the supplied battery was included in the package from the time of manufacture (as a convenience to the user), it is possible that the battery life may be somewhat depleted by the time of purchase. The actual life of the supplied battery may be shorter than the standard time described in this manual when using a fresh battery.

### When to replace the battery

Replace the battery with a new one when the POWER indicator dims. The noise canceling feature may not work correctly if battery power is low.

### To remove the battery

Open the lid of the battery box, then push the position marked with “PUSH ▷”. The (+) side of the battery comes up. Remove the battery by pulling it.

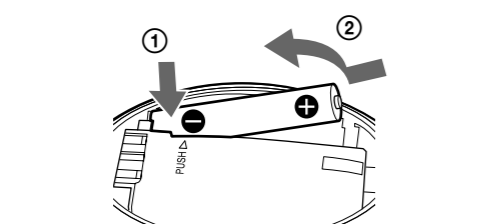

**If the lid of the battery box is detached**

Follow the procedure below to reattach the lid.

- Attach the lower side of the lid.

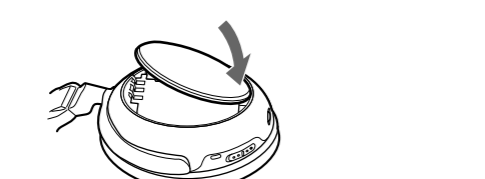

- Push the upper side of the lid straight forward until it clicks into position.

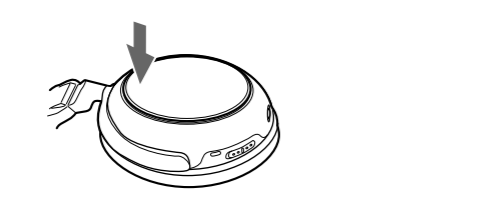

## Listening to music

- Connect the headphones to the AV equipment.

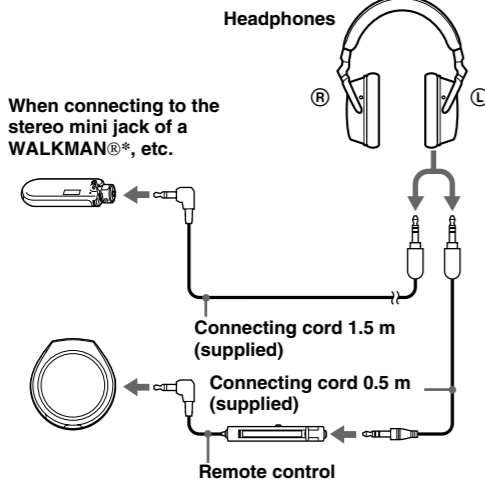

When connecting to the stereo mini jack of the remote control's jack supplied with a WALKMAN®, etc.

\* “WALKMAN” and “WALKMAN” logo are registered trademarks of Sony Corporation.

### Notes

- When connecting the cord, insert the plug into the jack until the green portion of the plug disappears.

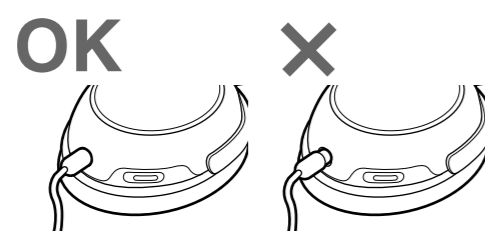

- To disconnect the cord, pull it out by the plug, not the cord, as the inner conductors may break.

- Turn on the power on the right side of the headphones.

The POWER indicator lights in red. When the power is turned on, ambient noise is reduced, and you can listen to music more clearly at a lower volume.

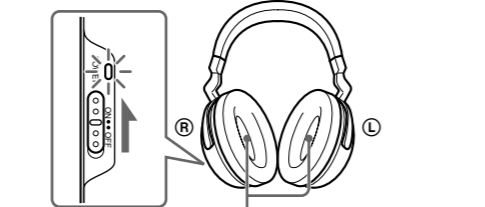

- Put on the headphones so that the ear pads cover your ears.



- Turn on the power of the AV equipment.

**Hearing environmental sound for safety**

If the MONITOR switch is pressed and held while the POWER switch is set to ON, playback silences so you can hear the surrounding environment.

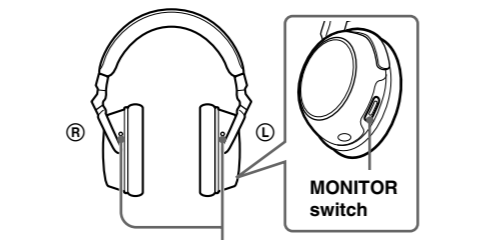

Monitor microphone

### Note

The environmental sound might not be heard if the microphone is covered with your fingers.

## Notes on using on the airplane

- The supplied plug adaptor can be connected to dual and stereo mini jacks.

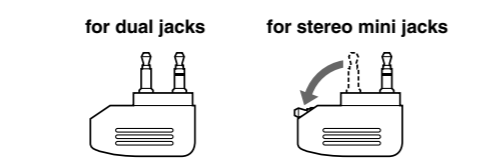

- Do not use the headphones when use of electronic equipment is prohibited or when use of personal headphones for in-flight music services is prohibited.

If you have any questions or problems concerning the system that are not covered in this manual, please consult the nearest Sony dealer.

### After listening to music

Turn off the power of the headphones.

## Folding the headphones

### Folding

The housings rotate to make them flat for easy storage in the carrying case (supplied), or in a seat pocket.

Restore to their usual position before using.

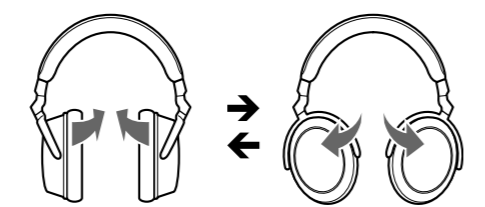

### Putting the headphones in the carrying case

Fold the headphones before putting them in the carrying case. The supplied cord, unimatch plugs or reserve batteries can also be stored in the pocket.

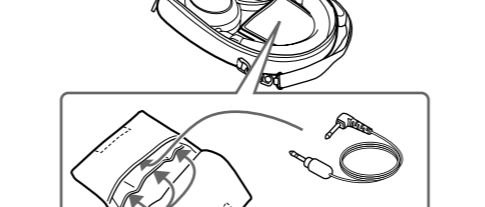

**Note on storing the connecting cord**

Store the connecting cord in the carrying case with both plugs together to avoid short circuiting the battery.

## Precautions

The headphones contain a noise canceling circuit.

### What is noise canceling?

The noise canceling circuit actually senses outside noise with built-in microphones and sends an equal-but-opposite canceling signal to the headphones.

- The noise canceling effect may not be pronounced in a very quiet environment, or some noise may be heard. In such a case, turn the POWER switch off.
- The noise canceling effect may vary depending on how you wear the headphones.
- When you turn the POWER switch on, the operation sound of the noise canceling may be noticeable. This is not a malfunction.
- The noise canceling function is only effective for noise in the low frequency band. Although noise is reduced, it is not canceled completely.
- When you use the headphones in a train or a car, noise may occur depending on street conditions. In such a case, turn the POWER switch off.
- You can use the headphones without turning on the power. In this case, the noise canceling function is not active, and the headphones operate as passive headphones.
- Howling may occur if you do not wear the headphones correctly.
- Howling may occur if you place an object such as finger close to the noise canceling microphone. Keep it away from the microphone.
- Mobile phones may cause noise. Keep the headphones away from mobile phones.

### Notes on usage

- Clean the headphones with a soft dry cloth.
- Do not leave the plug dirty otherwise the sound may be distorted.
- Be sure to consult a Sony dealer when the earpads become dirty or damaged, or when the headphones require repair work.
- Do not leave the stereo headphones in a location subject to direct sunlight, heat or moisture.

### Note on headphones Preventing hearing damage

Avoid using headphones at high volume. Hearing experts advise against continuous, loud and extended play. If you experience a ringing in your ears, reduce the volume or discontinue use.

### Do not listen with the headphones while driving or cycling

As your headphones reduce outside sounds, it may cause traffic accident. Also avoid using them where hearing must not be impaired, for example, at a railroad crossing, a site of construction, etc.

## Troubleshooting

### No sound

- Check the connection of the headphones and the AV equipment.
- Check that the connected AV equipment is turned on.
- Turn up the volume of the connected AV equipment.

### Muffled sound

- Turn down the volume of the connected AV equipment.
- Replace the battery.

### Power does not turn on

- Check if the battery has expired (the POWER indicator dims).
- Replace the battery with a new one.

### Howling

- Make sure you are wearing the headphones correctly.

## Specifications

<b>General</b>	
Type	Dynamic, closed
Driver units	40 mm, dome type (CCA W adopted)
Power handling capacity	100 mW
Impedance	40 Ω at 1 kHz <p>(when the power is on)</p> 100 Ω at 1 kHz <p>(when the power is off)</p>
Sensitivity	102 dB/mW <p>(when the power is on)</p> 100 dB/mW <p>(when the power is off)</p>
Frequency response	14 – 24,000 Hz
Frequency range of active noise attenuation	40 – 1,500 Hz, more than 16.5 dB at 200 Hz
Power source	DC 1.5 V, 1 × R03 (size AAA) battery
Mass	Approx. 230 g (8.12 oz) including battery

### Supplied accessories

Connecting cord (0.5 m, gold plated stereo mini plug) (1)  
Connecting cord (1.5 m, gold plated L type stereo mini plug) (1)  
Sony R03 (size AAA) battery (1)  
Carrying case (1)  
Plug adaptor for in-flight use\* (single/dual)(1)  
Gold-plated unimatch plug adaptor (stereo phone plug ↔ stereo mini jack)(1)  
Operating Instructions (1)  
Card warranty (1)  
World model service network list (1)

\* May not be compatible with some in-flight music services.

Design and specifications are subject to change without notice.