

This equipment has been tested and found to comply with the limits for a Class B digital device, pursuant to Part 15 of the FCC Rules. These limits are designed to provide reasonable protection against harmful interference in a residential installation. This equipment generates, uses, and can radiate radio frequency energy and if not installed and used in accordance with the instructions, may cause harmful interference to radio communications. However, there is no guarantee that interference will not occur in a particular installation. If this equipment does cause harmful interference to radio or television reception, which can be determined by turning the equipment off and on, the user is encouraged to try to correct the interference by one or more of the following measures:

- Reorient or relocate the receiving antenna.
- Increase the separation between the equipment and receiver.
- Connect the equipment into an outlet on a circuit different from that to which the receiver is connected.
- Consult the dealer or an experienced radio/TV technician for help.

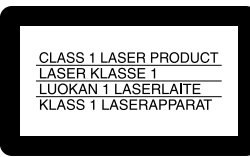

This appliance is classified as a CLASS 1 LASER product. The CLASS 1 LASER PRODUCT MARKING is located at the bottom of the player.

Notice for customers in the United Kingdom and Republic of Ireland

A moulded plug complying with BS1363 is fitted to this equipment for your safety and convenience. Should the fuse in the plug supplied need to be replaced, a 5 AMP fuse approved by ASTA or BSI to BS1362, (i.e., marked with Ⓢ or Ⓡ mark) must be used. If the plug supplied with this equipment has a detachable fuse cover, be sure to attach the fuse cover after you change the fuse. Never use the plug without the fuse cover. If you should lose the fuse cover, please contact your nearest Sony service station.

About this manual

Thank you for purchasing this Sony CD/DVD Player. Before operating this player, please read this manual thoroughly and retain it for future reference. In this manual, the basic information on connection, operation, and settings is given on the back side (Blue Side). The advanced information on connection and settings, and additional information is given on this side (Brown Side).



Playable discs and special words

Identifying the discs

Playable discs: DVD VIDEOS, Music CDs, VIDEO CDs

The "DVD VIDEO" logo is a trademark.

Non-playable discs

- CD-Rs/CD-RWs/CD-ROMs (including photo CDs) that are not in music CD or VIDEO CD format.
- Data sections in CD-EXTRAS
- HD (high density) layer of Super Audio CDs
- DVD-ROMs, DVD Audio discs, DVD-RWs (VR mode)
- DVDs with region codes that cannot be played on this player.
- Irregularly shaped discs such as heart- or star-shaped discs.
- A disc with stickers or glue on its surface.

For U.S./Canadian models: A disc recorded in a color system other than NTSC.

For European models: A disc recorded in the NTSC color system when connected to a PAL TV. A disc recorded in the PAL color system when connected to an NTSC TV.

Notes

- **Notes about DVD-RWs/DVD-Rs, DVD+Rw/DVD+Rs or CD-Rs/CD-RWs**
Some DVD-RWs/DVD-Rs, DVD+Rw/DVD+Rs or CD-Rs/CD-RWs cannot be played on this player due to the recording quality or physical condition of the disc, or the characteristics of the recording device and authoring software. The disc will not play if it has not been correctly finalized. For more information, see the operating instructions for the recording device. Note that discs created in the Packet Write format cannot be played.

Digital audio compression technology developed by Digital Theater Systems. Conforms to 5.1ch surround mode. "DTS" and "DTS Digital Out" are trademarks of Digital Theater Systems, Inc.

Dolby Surround (Pro Logic)
Audio signal processing technology developed by Dolby Laboratories for surround mode.

More on playable DVDs

Region code

Your player has a region code printed on the bottom of the player (see "Precautions" for the specific location) and will only play DVDs that are labeled with identical region codes or the mark.

Copyright

This product incorporates copyright protection technology that is protected by method claims of certain U.S. patents, other intellectual property rights owned by Macrovision Corporation, and other rights owners. Use of this copyright protection technology must be authorized by Macrovision Corporation, and is intended for home and other limited viewing uses only unless otherwise authorized by Macrovision Corporation. Reverse engineering or disassembly is prohibited.

More on playable DATA CDs

Formats

You can play MP3 audio tracks recorded on CD-Rs/CD-RWs/CD-ROMs in accordance with ISO9660[®] Level1/Level2/Joliet formats. You can also play discs with MP3 audio tracks recorded in multisession format (a format in which data is added on to the disc) only if an MP3 audio track is recorded in the first session. *A logical file format for CD-ROM formalized by the International Organization for Standardization (ISO).

Understanding special words

Dolby* Digital

Digital audio compression technology developed by Dolby Laboratories. Conforms to 5.1ch surround mode. *Manufactured under license from Dolby Laboratories. "Dolby," "Pro Logic," and the double-D symbol are trademarks of Dolby Laboratories.

Limiting Playback

You can set a password and choose a playback limitation level for DVDs with the playback limitation function. Scenes that are limited by this function may be blocked or replaced with different scenes.

Setting the playback limitation level

- 1 Press DISPLAY repeatedly in stop mode to show Setup Display.
- 2 Select "SCREEN SETUP" using and press ENTER.
- 3 Select "PARENTAL CONTROL" using , and press ENTER.
- 4 Enter a 4-digit password, and press ENTER. Select the numbers using / . Press to go to the next digit. When entering a password for the first time, repeat this step once more to confirm the entered password.

<TV screen>

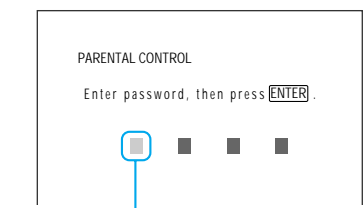

- 5 Select "STANDARD" using , and press ENTER.
- 6 Select an area as the playback limitation level standard (e.g., "USA") using , and press ENTER. When you chose "OTHERS" using , select and enter a code number from the area code list given at the end of this section using , , , and .

Select the limitation level (e.g., "4PG13") using , and press ENTER. The viewer limitation becomes more strict as the number becomes lower.

To return to the previous screen

Press .

To turn off the display

Press DISPLAY.

To change the password

After performing step 4 of "Setting the playback limitation level," select "CHANGE PASSWORD" using , and press ENTER. Enter your 4-digit password using , , , and , and press ENTER. The display for changing the password appears. Enter a new password and press ENTER. To confirm the password, enter the new password again, and press ENTER.

Playing discs with playback limitations

- 1 Place the disc on the tray, and close the lid until it clicks. Then press . The display for entering your password appears.
- 2 Enter the 4-digit password using , , , and , and press ENTER. Playback starts.

To cancel the playback limitation

Select "OFF" for "LEVEL" in step 8 of "Setting the playback limitation level."

If you forget your password

Open the lid and perform steps 1-3 of "Setting the playback limitation level." Enter the 6-digit number "199703" in step 4, and press ENTER. After entering a new password and pressing ENTER, repeat the entire procedure from step 1 of "Playing discs with playback limitations."

Standard	Code number
Argentina	2044
Australia	2047
Austria	2046
Belgium	2057
Brazil	2070
Canada	2079
Chile	2090
China	2092
Denmark	2115
Finland	2185
France	2174
Germany	2109
India	2248
Indonesia	2238
Italy	2254
Japan	2276
Korea	2304
Malaysia	2363
Mexico	2362
Netherlands	2376
New Zealand	2390
Norway	2379
Pakistan	2427
Philippines	2424
Portugal	2436
Russia	2489
Singapore	2501
Spain	2149
Sweden	2499
Switzerland	2086
Thailand	2528
United Kingdom	2184

Using the Design Sheet

You can open the clear, round-shaped cover on the lid of this player and exchange the supplied "design sheet" with your favorite pictures or photos.

- 1 Press to open the lid of the player.
- 2 On the back side of the lid, slide the locks toward the center at the same time as shown in the illustration and release the hooks . The front part of the ring will pop up .

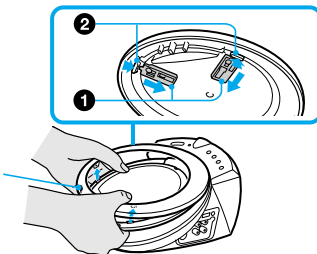

- 3 Lower the lid and remove the ring. Then remove the transparent cover.
- 4 Place a design sheet on the lid. Replace the transparent cover, aligning the one upper and two lower cutouts with the lid.
- 5 Engage the upper two tabs of the lid with the slots in the ring . Insert the two lower tabs of the ring into the slots in the lid until it clicks.

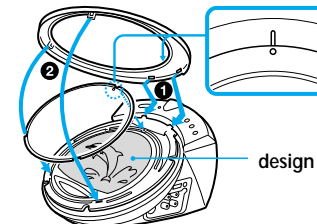

Hint
Align the marks on both the transparent cover and the ring when replacing them.

CD/DVD Player

Operating Instructions



DVP-PQ2

http://www.sony.net/
© 2003 Sony Corporation Printed in Malaysia

Connecting Other Components

For better pictures

If your TV* has an S VIDEO input jack, connect this player to your TV using an S VIDEO cord for higher quality images.
* You can also use monitors and projectors.

Connecting to your TV using an S VIDEO cord

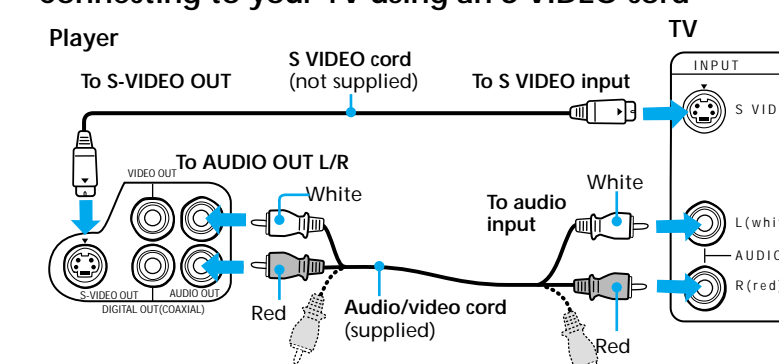

Connecting headphones/earphones

Connect headphones or earphones to the (phone) jack and adjust the (volume) control.

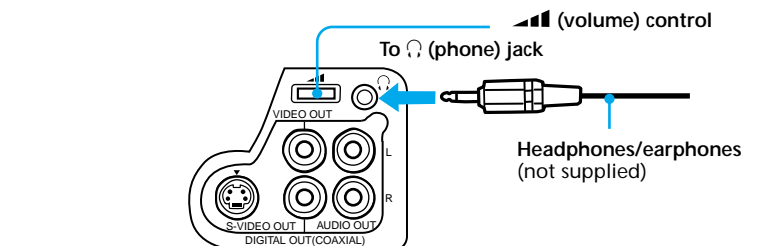

For better sound

You can connect this player to an amplifier and speakers to enjoy better sound. See the relative diagrams below to connect to an amplifier.

- A stereo amplifier: Use a stereo audio cord.
- An AV amplifier with DTS, Dolby Digital, or MPEG audio decoder: Use a coaxial digital cord*. You can enjoy the DVD's DTS, Dolby Digital, or MPEG audio sound.
- An AV amplifier with Dolby Surround (Pro Logic) decoder: Use a stereo audio cord or coaxial digital cord*. You can enjoy the DVD's Dolby Surround sound.
- * If you connect a coaxial digital cord, you cannot use the TVS function of this player.

Before operating this player, adjust the settings of this player ("DIGITAL OUT"/"DOLBY DIGITAL"/"DTS"/"MPEG") according to the connected components (e.g., amplifier). For details, see "Settings and Adjustments" on the Blue Side of this manual.

Connecting an amplifier using a stereo audio cord

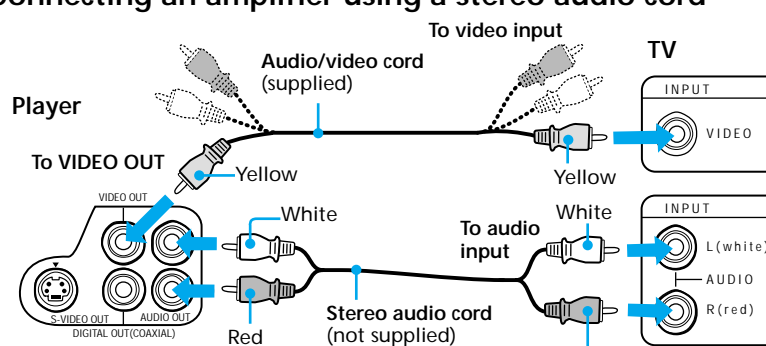

Connecting an amplifier using a coaxial digital cord

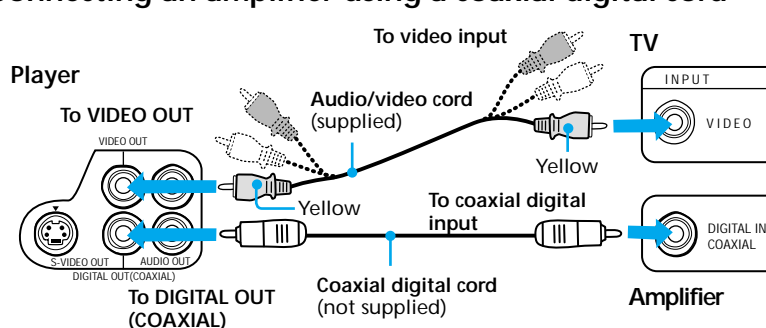

Note

When you use the DIGITAL OUT (COAXIAL) jack to listen to MPEG audio signals and set "MPEG" to "MPEG" in "AUDIO SETUP," no sound will come from your speakers if you select one of the TVS modes.

Precautions

The power requirements, power consumption, and region code of this player are indicated at the bottom of the player. Check that the player's operating voltage is identical with your local power supply.

On safety
• Caution - The use of optical instruments with this product will increase eye hazard.
• Should any solid object or liquid fall into the cabinet, unplug the player and have it checked by qualified personnel before operating it any further.

On power sources (mains)
• The player is not disconnected from the AC power source (mains) as long as it is connected to the wall outlet, even if the player itself has been turned off.
• If you are not going to use the player for a long time, be sure to disconnect the player from the wall outlet. To disconnect the AC power cord (mains lead), grasp the plug itself; never pull the cord.

On placement
• Do not install the player in an inclined position. It is designed to be operated only in a horizontal position.
• Place the player in a location with adequate ventilation to prevent heat build-up in the player.
• Do not place the player on a soft surface such as a rug that might block the ventilation holes.
• Do not place the player in a location near heat sources, or in a place subject to direct sunlight, excessive dust, or mechanical shock.
• Keep the player and discs away from equipment with strong magnets, such as microwave ovens, or large loudspeakers.

operate properly. In this case, remove the disc and leave the player turned on for about half an hour until the moisture evaporates.
• Do not touch the disc if it is still spinning when you open the lid.
• When you move the player, take out any discs. If you don't, the disc may be damaged.

On the headphones/earphones
Preventing hearing damage
Avoid using headphones/earphones at high volumes. Hearing experts advise against continuous, loud and extended play. If you experience a ringing in your ears, reduce the volume or discontinue use.
Caring for others
Keep the volume at a moderate level. This will allow you to hear outside sounds and to be considerate of the people around you.

On cleaning
Clean the cabinet, panel, and controls with a soft cloth slightly moistened with a mild detergent solution. Do not use any type of abrasive pad, scouring powder, or solvent such as alcohol or benzine.

On cleaning discs
Do not use a commercially available cleaning disc. It may cause a malfunction.

IMPORTANT NOTICE
Caution: This player is capable of holding a still video image or on-screen display image on your television screen indefinitely. If you leave the still video image or on-screen display image displayed on your TV for an extended period of time, you risk permanent damage to your television screen.
Plasma Display Panel televisions and projection televisions are especially susceptible to this.
If you have any questions or problems concerning your player, please consult your nearest Sony dealer.

Troubleshooting

If you experience any of the following difficulties while using the player, use this troubleshooting guide to help remedy the problem. Should any problem persist, consult your nearest Sony dealer.

Power

The player does not turn on.
• Connect the power cord (mains lead) securely.
• Close the lid of the player until it clicks.

Display

There is no picture. The picture is distorted.
• Check to see if the player is connected securely.
• Check to see if the connecting cord is damaged.
• Check the connection and change the video input on the TV so that the picture output from this player is displayed on the TV screen.
• If the video signal from your DVD player is output to your TV via a VCR, the copy-protection signal of some DVD programs could affect the picture quality. If you still experience problems after connecting this player directly to your TV, try connecting to the S VIDEO input of your TV, if it has one.

The picture does not fill the screen even after adjusting the "TV TYPE" in "DISPLAY SETUP."
• The aspect ratio is fixed on your DVD.

Audio

There is no sound.
• Check to see if the player is connected securely.
• Check to see if the audio connecting cord is damaged.
• Check to see if the player is connected correctly to the amplifier.
• Change the audio input setting of your amplifier so that you can hear the sound from this player.
• The player is in the pause, Slow Motion Play, or the scan mode.
• If no sound is output from the DIGITAL OUT (COAXIAL) jack, check the audio setup setting. (See "Settings and Adjustments" on the Blue Side.)
• Press AUDIO repeatedly and select "STEREO" to play DTS sound tracks on a CD.

A loud noise occurs.

• When playing a CD with DTS sound tracks, noise will come from the AUDIO OUT L/R jacks.

The volume is low.

• Select "ON" for "AUDIO ATT" in the audio setup setting. (See "Settings and Adjustments" on the Blue Side.)
• If you are playing a Super VCD which does not contain a second audio track, no sound will come out when you select "2: STEREO," "2: 1/L," or "2: 2/R" by pressing AUDIO repeatedly.

There is no sound output from the headphones/earphones or the sound is too low.
• Insert the headphones/earphones plug firmly into the jack.
• Adjust the (volume) control.

Operation

The remote does not function.
• Remove any obstacles between the remote and the player.
• Use the remote near the player.
• Point the remote at the remote sensor on the player.
• Replace all batteries in the remote with new ones.

The disc does not play.
• Close the lid of the player until it clicks.
• Place the disc on the tray with the recorded side facing down, and press its center until it clicks into place.
• The disc type is not compatible with the player.
• Moisture has condensed inside the player. (See "Precautions" for details.)

The player does not start playing from the beginning of a disc.

• The player is in Repeat Play, Shuffle Play, or Resume Play mode. To return to normal play mode, press CLEAR or press twice.

Playback stops automatically.
• A disc with an auto pause signal stops playback at that signal.

I cannot perform some functions such as Stop, Scan, Slow Motion Play, Repeat Play, or Shuffle Play.
• Some discs prohibit the operation of these functions.

I cannot switch the audio language or the angle.

I cannot change the subtitle language or cancel the subtitles.
• Instead of pressing AUDIO, ANGLE, or SUBTITLE, press MENU to display the DVD's menu and select the desired option with , , , and and ENTER.
• There are no multilingual tracks, subtitles, or multi-angles recorded on that DVD.
• There are no other recorded angles for the scene you are watching.
• The changing of language, angle, or subtitles is prohibited on that DVD.

The player does not operate properly.
• Static electricity, etc., may affect the player's operation. Disconnect the AC power cord (mains lead), then connect it again.

Error Messages

A five-character service number (combination of a letter and digits (e.g., "E:61:10")) is displayed on the screen.
• When the first 3 digits are "C13": Clean the disc with a cleaning cloth.
• When the first 3 digits are "C31": Place the disc correctly on the tray.
• When the digits start with "E": Consult your nearest Sony dealer.

Specifications

System
Laser: Semiconductor laser
Signal format systems: U.S./Canadian models: NTSC
European models: PAL/NTSC

Outputs
(Jack name: Jack type/Output level/Load impedance)
AUDIO OUT L/R: Phonojack/2 Vrms/10 kΩ
DIGITAL OUT (COAXIAL): Phonojack/0.5 Vp-p/75 Ω
VIDEO OUT: Phonojack/1.0 Vp-p/75 Ω
S-VIDEO OUT: 4-pin mini DIN/ Y: 1.0 Vp-p, C: 0.3 Vp-p (PAL), 0.286 Vp-p (NTSC)/75 Ω

Headphones/earphones: Stereo mini-jack/9 mW + 9 mW/32 Ω

General
Power requirements: U.S./Canadian models: 120 V AC, 60 Hz
European models: 220 - 240 V AC, 50/60 Hz
Power consumption: 9 W
Dimensions (approx.): 190 × 147 × 235 mm (7 × 5 7/8 × 9 in.) (w/h/d)
Mass (approx.): 1.3 kg (2.9 lbs)
Operating temperature: 5 °C to 35 °C (41 F to 95 F)
Operating humidity: 25 - 80 %

Supplied accessories
Operating Instructions (1)
Audio/video cord (1)
Remote (1)
AA (R6) size batteries (2)
EURO AV adaptor (For European models only) (1)
Design sheet

Specifications and design are subject to change without notice.

ENERGY STAR[®] is a U.S. registered mark. As an ENERGY STAR[®] Partner, Sony Corporation has determined that this product meets the ENERGY STAR[®] guidelines for energy efficiency.

Language Code List

The language spelling conforms to the ISO 639:1988 (E/F) standard.

Code	Language	Code	Language	Code	Language	Code	Language
1027	Afar	1183	Irish	1349	Macedonian	1509	Somali
1028	Abkhazian	1186	Scotts Gaelic	1350	Malayalam	1511	Albanian
1032	Afrikaans	1194	Galician	1352	Mongolian	1512	Serbian
1039	Amharic	1196	Guarani	1353	Moldavian	1513	Siswati
1044	Arabic	1203	Gujarati	1356	Marathi	1514	Sesotho
1045	Assamese	1209	Hausa	1357	Malay	1516	Sundanese
1051	Aymara	1217	Hindi	1358	Maltese	1517	Swedish
1052	Azerbaijani	1226	Croatian	1363	Burmese	1521	Swahili
1053	Bashkir	1229	Hungarian	1365	Nauru	1521	Tamil
1057	Byelorussian	1233	Armenian	1369	Nepali	1525	Telugu
1059	Bulgarian	1235	Interlingua	1376	Dutch	1527	Tajik
1060	Bihari	1239	Interlingue	1379	Norwegian	1528	Thai
1061	Bislama	1245	Impujak	1383	Occitan	1529	Tigrinya
1066	Bengali	1248	Indonesian	1403	(Afan)Oromo	1531	Turkmen
1067	Tibetan	1253	Icelandic	1408	Oriya	1532	Tagalog
1070	Breton	1257	Hebrew	1417	Punjabi	1534	Setswana
1079	Catalan	1261	Japanese	1428	Polish	1535	Tonga
1093	Corsican	1269	Yiddish	1435	Pashto; Pushto	1538	Turkish
1097	Czech	1283	Japanese	1436	Portuguese	1540	Tatar
1103	Welsh	1287	Georgian	1463	Quechua	1543	Twi
1105	Danish	1297	Kazakh	1481	Rheto-Romanic	1552	Ukrainian
1109	German	1298	Greenlandic	1482	Kirundi	1564	Urdu
1130	Bhutani	1299	Cambodian	1483	Romanian	1572	Uzbek
1142	Greek	1300	Kannada	1489	Russian	1581	Vietnamese
1144	English	1301	Korean	1491	Kinyarwanda	1587	Volapuk
1145	Esperanto	1305	Kashmiri	1495	Sanskrit	1613	Wolof
1149	Spanish	1307	Kurdish	1498	Sindhi	1632	Xhosa
1150	Estonian	1311	Kirghiz	1501	Sangho	1665	Yoruba
1151	Basque	1313					

Connecting the Player



Connecting to your TV

You can enjoy standard quality picture and sound using this connection. Before connecting, make sure that your TV is turned off. To enjoy better picture and sound, refer to the Brown Side of this manual. Refer also to the instruction manuals of the components to be connected.

Basic connection

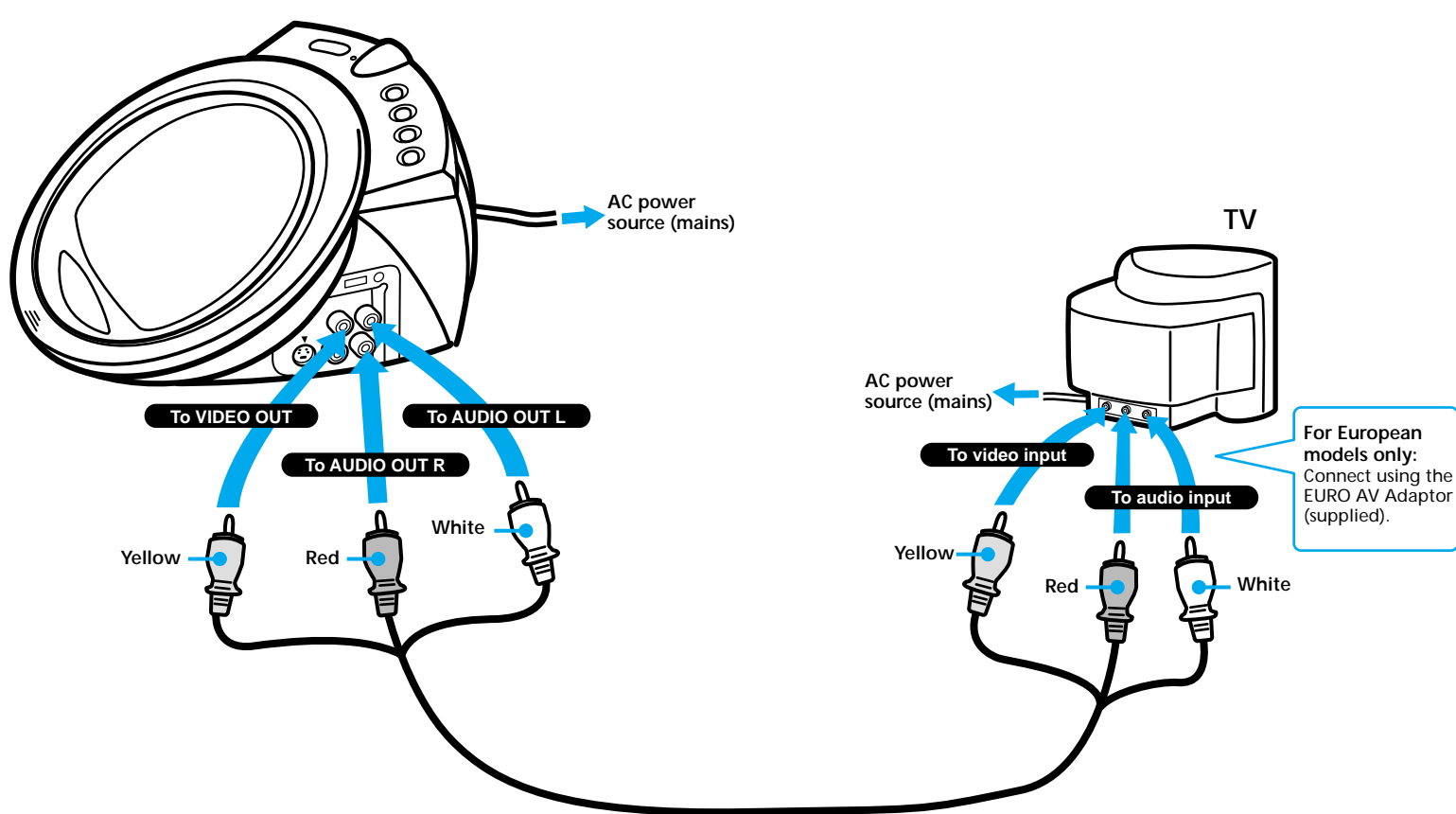

Connect the audio/video cord (supplied).
Then, connect the player and the TV to an AC power source (mains).

Playing Discs



Basic steps and tips on playback

You can play DVDs, VIDEO CDs, music CDs, as well as MP3 audio tracks recorded on a DATA CD*. Buttons on the player that share the same symbol with buttons on the remote also share the same function.
*A CD-R/CD-RW/CD-ROM with MP3 audio tracks recorded on the disc is called a "DATA CD" in this manual.

1 On your TV :
Turn your TV on and select the video input.

2 Turn on the player by pressing I/O (on/standby).
One of the background pictures appears at random on your TV screen.

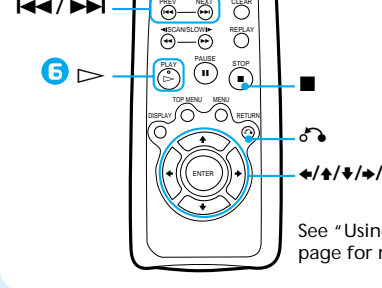
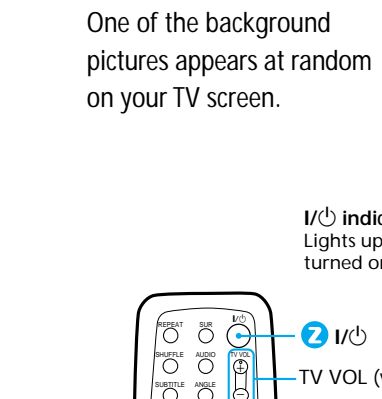

5 Press > (play).

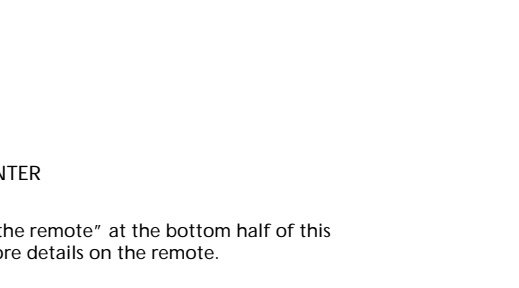
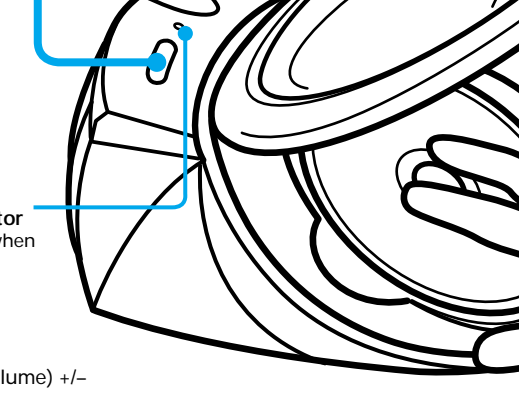
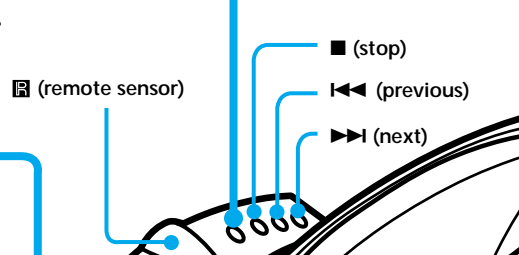

3 Press ▲PUSH, and gently lift the lid until it clicks.

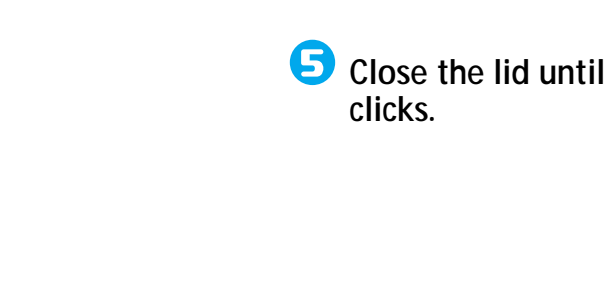

To adjust the TV volume (for Sony products only)
Press TV VOL +/-.

Note

This function may not be available depending on the connected TV.

To play the next or previous chapter or track
Press >>> or <<<< during playback.

To stop playback

Press ■. The background picture appears on your TV screen. (See "Settings and Adjustments" for details.) The next time you press >>>, playback starts from the same place. (Resume Play)

To play from the beginning

Press ■ twice, then press >>>.

To remove the disc

Hold the edges of the disc and pull while pressing the center.

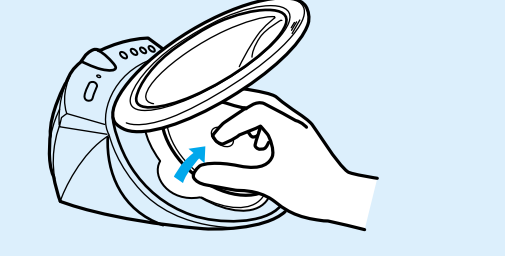

Notes on connecting to your TV

- Do not connect this player directly to a component such as a VCR. If you do, noise may appear in the picture.
- When connecting this player to a monaural TV, use a stereo-mono conversion cord (not supplied).

To insert batteries in the remote

Slide open the cover. Insert two AA (R6) size batteries by matching the + and - ends with the markings inside the compartment, and close the cover.

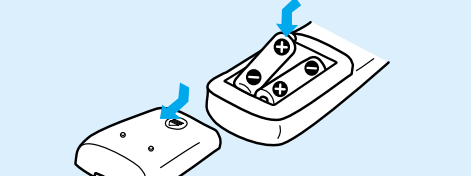

Connecting the EURO AV Adaptor (For European models only)

Attach the Euro AV Adaptor (supplied) to your TV. Then, connect the audio/video cord to the corresponding jacks of the Euro AV Adaptor.

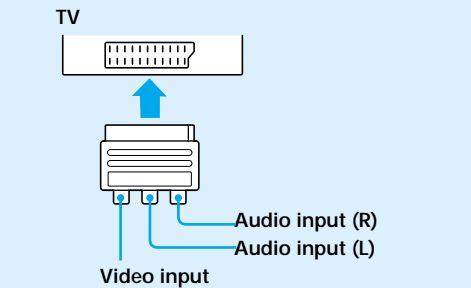

Using the Remote



To change the playing mode, sound effect, and display, or to use the DVD's menu.
→ "Functions"

To read disc information on the screen.
→ "Reading the screen"

Remote

The letters below correspond to the letters in "Functions." Use the letters to quickly find the buttons needed for each operation.

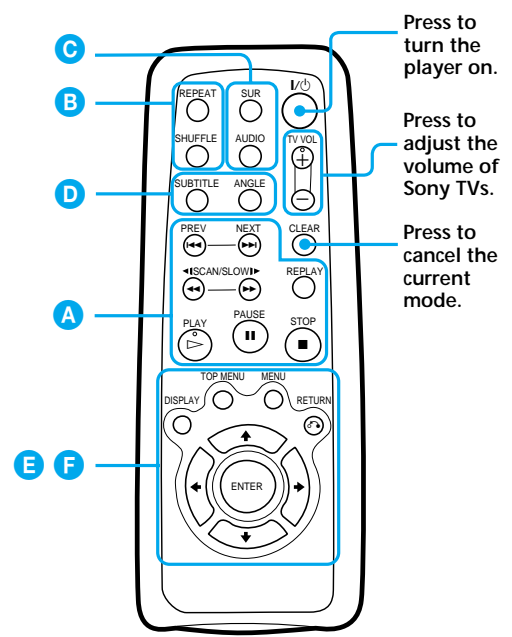

There is a tactile dot on > and the "+" button of TV VOL.

Functions

Note

Some playback features of DVDs and VIDEO CDs described in the following may be prohibited by the software producers. Refer to the instructions supplied with the DVDs and VIDEO CDs.

Basic operations (A)

To	Press
play	>
stop	■
pause	
go to the next or previous title or track	>>> NEXT or <<<< PREV during playback.
scan forward or backward	>>>> or <<<<< during playback. Press the button repeatedly to change the speed. To return to normal playback, press >>>.
play forward or backward in slow motion	>>>> or <<<<< during pause. (DVD/VIDEO CD only) Press the button repeatedly to change the playback speed. To return to normal playback, press >>>.
repeat	REPLAY during playback. (DVD only)

Selecting the playing mode (B)

You can play a selected title or track randomly or repeatedly. To cancel the operation, press the following button repeatedly to select "OFF" or press CLEAR.

To	Press
shuffle	SHUFFLE repeatedly during playback. (DVD/VIDEO CD/CD only)
repeat	REPEAT repeatedly during playback. When you select Repeat Play during Shuffle Play, Shuffle Play is repeated.

Changing the sound (C)

You can change the audio language for DVDs recorded with multilingual tracks. When listening to a Karaoke VIDEO CD, you can turn off the vocals. You can also enjoy this player's surround effect mode.

To change	Press
language/sound	AUDIO repeatedly during playback to select from the options. In DVDs: Select a language from the options on the screen. (When a 4-digit number is displayed, check the number in the "Language Code List" on the Brown Side of this manual.) VIDEO CDs/CDs/DATA CDs: • STEREO: To hear standard stereo sound. • 1/L: To hear the sound of the left channel from both speakers. • 2/R: To hear the sound of the right channel from both speakers. Super VCDs: (The number before the colon shows the number of the audio track being played. For the meaning after the colon, see above.) • 1: STEREO • 1: 1/L • 1: 2/R • 2: STEREO • 2: 1/L • 2: 2/R
TV Virtual Surround settings	SUR repeatedly during playback to select from the following. (DVD only) To cancel the surround setting, press SUR repeatedly to select "OFF."

Notes

- The surround mode signals are only output when the player is connected via the AUDIO OUT L/R jack.
- Set the surround settings of the connected components (such as TV) to off.
- Surround does not function when a disc has no rear signal.
- TVS DYNAMIC: To enjoy the surround effect with your TV's speakers. The distinct sound imaging effect is as if you have a set of additional speakers next to you.
- TVS WIDE: To enjoy the surround effect with your TV's speakers. The sound imaging effect is as if you have five sets of virtual speakers filling the area surrounding you.
- TVS NIGHT: To enjoy the surround mode at a lower volume. (Dolby Digital audio DVD only)
- TVS STANDARD: To enjoy the surround effect with a set of front speakers connected to the player. The imaging effect is as if you have three sets of additional speakers around you.

Changing the viewing angle and subtitles (D)

You can select picture angles if there are multiple pictures (angles) recorded on the disc, or change subtitle languages in multilingual DVDs.

To	Press
change angles	ANGLE repeatedly during playback to select the number of the angle you want to play. (DVD only)
display or change subtitles	SUBTITLE repeatedly to select the subtitle language. (DVD only) (When a 4-digit number is displayed, check the number in the "Language Code List" on the Brown Side of this manual.) To cancel the subtitle, press SUBTITLE repeatedly to select "OFF."

Using the DVD's menu (E)

When a menu is recorded on the DVD, you can usually select items such as the title, audio language, or subtitles.

To display	Press
DVD's menu	TOP MENU or MENU. Select an item using </>, and press ENTER. (DVD only) TOP MENU: Displays a menu of available movie and music titles. MENU: Displays a menu of subtitles and audio languages.

Displaying information on your screen (F)

You can display information such as the playing time or the disc text on the TV screen. To return to the normal screen, press DISPLAY repeatedly.

To display	Press
time/text	DISPLAY during playback. Then press ENTER repeatedly to switch the display from total playing time to remaining time, and vice versa. (For details, see "Time display" in the next section.) DVD/CD TEXT or MP3 track name will be displayed following the time display if it is recorded on the disc. (Only the letters of the alphabet are shown.)
current audio format	DISPLAY twice during playback. (DVD only) (For details, see "Audio display" in the next section.)

Reading the screen

You can display the time or audio format in the upper area of the TV screen during playback.

Time display

<Example">
Cg T11 8 T 1:01:57 >

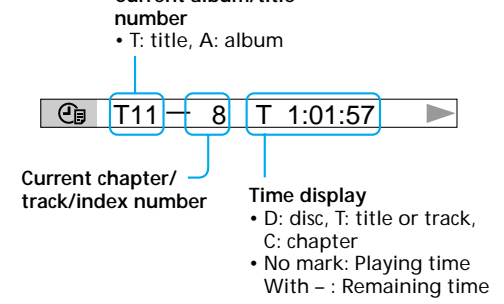

*Here, the disc is playing chapter 8 of the 11th title, which has been played for 1 hour 1 minute and 57 seconds.

Audio display

<Example">
DOLBY DIGITAL 3/2/1 >

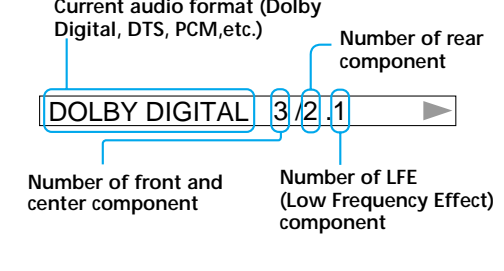

*Here, the indicated disc's audio format is Dolby Digital 5.1channel (ch).
5.1ch: 3 (Front Left/Right/Center) + 2 (Rear Left/Right) + 0.1 (LFE)

Note

When "DTS" is set to "OFF" in the audio setup setting, the DTS display will not appear even if the disc has a DTS signal. (See "Settings and Adjustments" for details.)

Playing MP3 audio tracks from a list

You can select and play MP3 audio tracks from the list displayed on the menu.

Selecting an MP3 audio track

1 Press MENU. Albums containing MP3 audio tracks appear.
<TV screen>
Selected album number
Number of playable albums in the disc

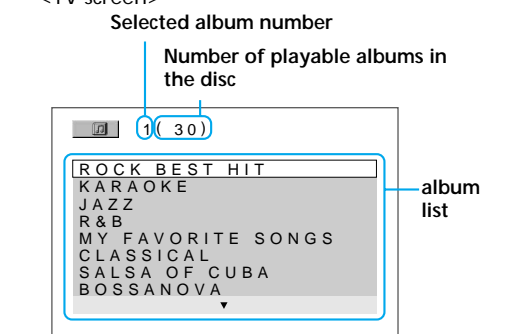

2 Select an album using </>, and press ENTER. The MP3 audio tracks contained in the album appears.
<TV screen>
Selected track number
Number of playable tracks in the album

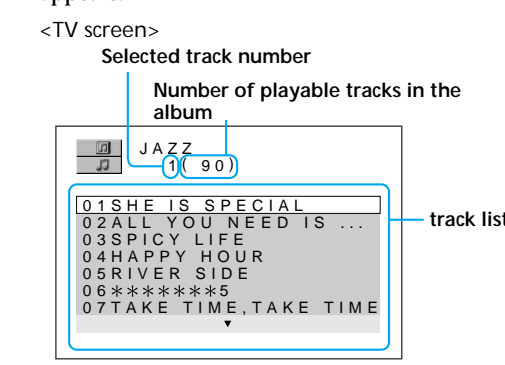

3 Select a track using </>, and press ENTER. Playback starts.

To display the next or previous page in an album or track list
Press < or >.

To return to the previous screen
Press <.

To turn off the menu
Press MENU once.

Hint

The album or track currently being played is shaded in the list.

Notes

- On playback
 - Only the MP3 audio tracks displayed in the list can be played on this player (maximum 100 albums or 200 tracks).
 - MP3 audio tracks are played in the order displayed in the list. This may not coincide with the recorded order.
 - The following audio format files cannot be played.
 - MP3 audio tracks not created according to ISO9660 Level1/Level2/Iollet.
 - MP3 audio tracks that do not have the file name extension ".MP3."
 - Files with the file name extension ".MP3." but are not MP3 audio tracks.
 - Audio tracks recorded in MP3PRO format.
 - MP3 audio tracks recorded in Packet Write format.
 - Data that are not MPEG1 Audio Layer 3.
- On the display method
 - Only the alphabet and numbers can be displayed. Other characters appear as an "*" (asterisk).
 - This player cannot display ID3 tags.

Selecting the language setup

For the following items, select the language from the Language List displayed on the screen.

Item	Select
OSD (DVD only)	The language you want for the player's menu and the Setup Display.
MENU* (DVD only)	The language you want for the menu recorded on the disc.
AUDIO* (DVD only)	The language you want for the sound. (ORIGINAL: The language prioritized in the disc is automatically chosen.)
SUBTITLE* (DVD only)	The subtitle language. (AUDIO FOLLOW: The subtitle language changes according to the audio language.)

*If the language you select here is not recorded on the disc, another language will be automatically selected from the disc.

Hint

When you select "OTHERS," enter the language code from the list on the Brown Side of this manual using </>.

Selecting the screen setup

Item	Select
TV TYPE* (Change this to fit the picture to your TV)	• 16:9 For a wide-screen TV or a TV with wide mode function. • 4:3 LETTER BOX For a standard TV. Displays a wide picture to fit the width of the screen while keeping the same aspect ratio. • 4:3 PAN SCAN For a standard TV. Cuts off portions of a wide picture in order to fit the width of the screen.
SCREEN SAVER	• ON: Turns on the screen saver. • OFF: Turns off the screen saver.

BACKGROUND	Select
	• 1: The logo appears. • 2: A preset picture appears. • 3: A preset picture appears.

*The setting recorded on the disc has priority.

Selecting the audio setup

Item	Select
AUDIO ATT (Audio attenuation)	• OFF: Standard setting. • ON: When the playback sound is distorted.
DIGITAL OUT (Adjust only when using a coaxial digital cord)	(See "Connecting Other Components" on the Brown Side for instructions on this connection.) • OFF: When connecting a TV or an amplifier to AUDIO OUT L/R. • ON: When connecting an amplifier with a digital input jack, etc., to DIGITAL OUT (COAXIAL).

(See "Connecting Other Components" on the Brown Side for instructions on this connection.)

MPEG (For European models only) (Adjust only when "DIGITAL OUT" is set to "ON.")	Select
	• D-PCM: Standard setting. • DOLBY DIGITAL: When connecting to an amplifier with a built-in Dolby Digital decoder.

(See "Connecting Other Components" on the Brown Side for instructions on this connection.)

DTS (Adjust only when "DIGITAL OUT" is set to "ON.")	Select
	• OFF: Standard setting. • ON: When connecting to an amplifier with a built-in DTS decoder.

Hint

The underlined settings are the default settings.